

12-08-400-006

#7501.50



12-08-400-007

#7501.75

R-Res

Y-1
WD FR SHED

Pin: 12-08-400-007
Sale Date: 12/21/10
Sale Price: \$150,000
Acres: 1.22 Net
Classification: Rural Residential

LEGAL DESCRIPTION:	CLASS:	-----	CSR'S	.00	-----	CODE	VALUE	ACRES
08-91-35	R RESIDENTIAL		GROSS	1.64		CURRENT		
A.C.T. COON			ROADS	.42		LAND	22,300	
PT SE SE			D.D.			BLDG		
			R.R.			DWLG	134,220(1)	
			MISC					
						TOTAL	156,520	
			NET	1.22				

-----		=====		=====	
		YEAR	2010		
		LAND	22,300	ROAD	.42
		BLDG			
		DWLG	134,220(1)		
		TOTAL	156,520		
		NET TX			

DEED HOLDER:	DATE REFER	CONTRACT HOLDER:	DATE REFER	YEAR	2009	-----	-----
EHRLERS FARMS LTD	01102011 4			LAND	22,300	ROAD	.42
2023 550TH ST				BLDG			
NEWELL IA 50568				DWLG	134,220(1)		
				TOTAL	156,520		
				NET TX			

-----	-----	-----	-----	YEAR	2008	-----	-----
DOYLE TIMOTHY F	12302002 3			LAND	10,030	ROAD	.42
DOYLE TEDDA L				BLDG			
55599 210TH AVE				DWLG	79,270(1)		
NEWELL IA 50568				TOTAL	89,300		
				NET TX			

-----	-----	-----	-----	YEAR	2007	-----	-----
KELM BRIAN	04081996 2			LAND	10,030	ROAD	.42
KELM JULIE				BLDG			
55599 210TH AVE				DWLG	79,270(1)		
NEWELL IA				TOTAL	89,300		
				NET TX			

-----	-----	-----	-----	YEAR	2007	-----	-----
EHRLERS FARMS LTD				LAND	8,500	ROAD	.42
2023 550TH ST				BLDG			
NEWELL IA				DWLG	67,180(1)		
				TOTAL	75,680		
				NET TX			

REMARKS:	-----	YEAR	2007	-----	-----
2 WD 61/396 03-18-96 \$43,500		LAND	8,500	ROAD	.42
3 W.D. #024127 11-20-02 \$85,000 (D000)		BLDG			
4 W.D. #103529 12-21-10 \$150,000		DWLG	67,180(1)		
		TOTAL	75,680		
		NET TX			

-----	-----	YEAR	2006	-----	-----
		LAND	8,500	ROAD	.42
		BLDG			
		DWLG	67,180(1)		
		TOTAL	75,680		
		NET TX			

5599 DWLG 210TH AVE, NEWELL

Deed: EHLERS FARMS LTD

Map Area: COON-RES

Checks/Tags:

Contract:

Route: 912-001-170

Lister/Date: DS, 09/30/2008

CID#: 0750175

Tax Dist: ACT COON

Review/Date: DS, 12/02/2008

DBA:

Plat Page:

Entry Status: Estimated

MLS:

Subdiv: [NONE]

RURAL/RESIDENTIAL

Legal:08-91-35 A.C.T. COON PT SE SE

Land

Land Basis	Front	Rear	Side 1	Side 2	R. Lot	SF	Acres								
Site-Excess							1.000								
Excess 1							0.220								
Sub Total						53,143.20	1.220								
Grand Total						53,143.20	1.220								

Sales				Building Permits				Values					
Date	\$ Amount	NUTC	Recording	Date	Number	Tag	\$ Amount	Reason					
12/21/2010	\$150,000	D0	103529	4/30/1997		N	\$5,000	Addition					
11/20/2002	\$85,000	D0	#024127										

Res. Structure		1 of 1		Finish				Plumbing				Addition		Garage	
Occ. Code	101	Ttl Rooms Above #	7	Bedrooms Above #	3	Full Bath	1	Addition	1 of 4	Garage	1 of 1				
Occ. Descr.	Single-Family / Owner Occupied	Ttl Rooms Below #	0	Bedrooms Below #	0	Shower Stall Bath		Year Built	1880	Style	Att Frm				
Year Built	1880	Bsmt Fin Area #1				Toilet Room		EFA	99	W X L	0' X 0'				
EFA / EFYr	99 / 1910	Bsmt Fin Area #2				Lavatory		EFA Year	1910	Area (SF)	720				
Arch. Dsgn	N/A	Bsmt Fin Area #3				Water Closet		Style	1 Sty Frm	Year Built	1997				
Style	2 Story Frame	Foundation	C Blk / Stn			Sink		Area (SF)	160	EFA	12				
AreaSF/TLA	736 / 3,360	Exterior Walls	Vinyl			Shower Stall/Tub		Condition	Above Normal	EFF Year	1997				
Condition	A NML	Roof	Asph / Gable			Mtl St Sh Bath	1	Bsmt (SF)		Condition	NML				
Basement	Full	Interior Finish	Plas / Drwl			Mtl Stall Shower		NoBsmt Flr(SF)		Bsmt (SF)					
No Bsmt Flr.	0	Flooring	Carp / Vinyl			No Bathroom		Heat	FHA - Gas	Qtrs Over	None				
Heat	FHA - Gas	Non-base Heating		Fireplace		Wet Bar		AC	Yes	Qtrs Over (SF)					
AC	Yes	Floor/Wall #	0	Gas/Elec-Side, 1 Sty	1	Whirlpool Bathroom		Attic (SF)		Qtrs AC (SF)					
Attic	None	Pipeless #	0			Whirlpool Tub		See other pages for more additions.							
		Hand Fired (Y/N)	No			No Hot Water Tank				Door Opnrs					
		Space Heat #	0			No Plumbing				Bsmt Stalls					
		Appliances				Sewer & Water Only									
		Range Unit	1	Built-In Vacuums		Water Only w/Sink									
		Oven - Single	1	Intercom System		Hot Tub									
		Oven - Double		BI Stereo		Bidet									
		Dishwasher				Fbgls Service Sink									
		Microwave				Urinal									
		Trash Compactor				Sauna									
		Jennair				W'Pool Bath w/Shower									
		Security System				Water Only									
						No Tub/Shower									



Bldg / Addn	Description	Units	Year					
1 of 1	101 — Single-Family / Owner Occupied							
	2 Story Frame	736						
	Base Heat: FHA - Gas							
	Add Central Air	736						
#1	Porch: 1S Frame Open	200 SF						
	Deck #1: Concrete Patio-Low	252 SF						
	Veneer #1 1/2 Story Brick	74.0 LF						
	Plumbing	2						
	B.I. Appliances	2						
#1	Fireplace: Gas/Elec-Side, 1 Story	1						
	Garage: Att Frame	720 SF	1997					
1 of 4 Adtn	1 Story Frame	160 SF	1880					
2 of 4 Adtn	1 Story Frame	544 SF	1960					
3 of 4 Adtn	1 Story Frame	416 SF	1880					
4 of 4 Adtn	1 Story Frame	768 SF	1997					

	Description	Units	Cond	Year						
P:1	Yrd 1 — Sheds		NML	1960						

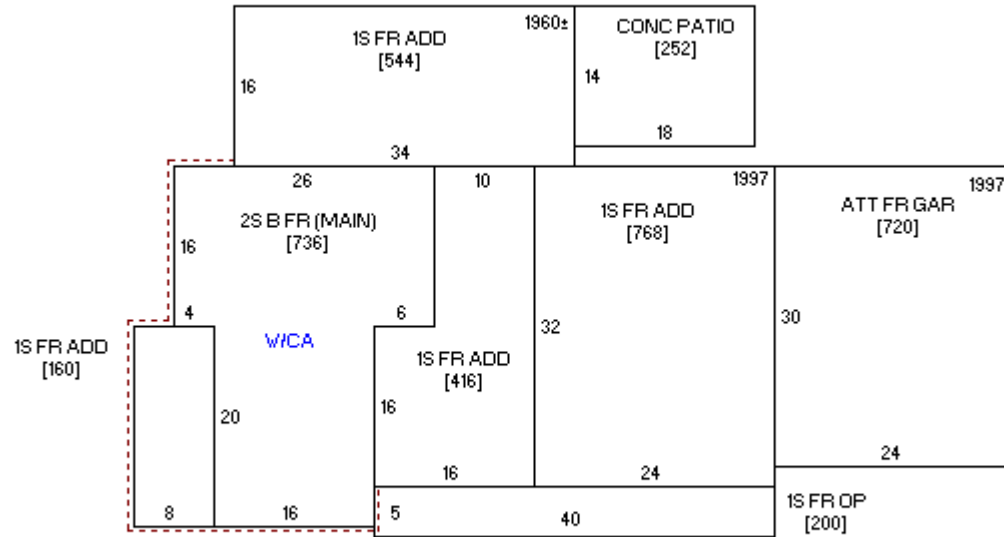

74 LF 1/2S BRK



09/18/2008