

LEGAL DESCRIPTION:

CLASS:

		CSR'S	.00	CODE	VALUE ACRES
GROSS	CURRENT				
ROADS	LAND	84,480			
D.D.	BLDG				
R.R.	DWLG	299,100(1)			
MISC					
	TOTAL	383,580			
NET					

11-00 R RESIDENTIAL
 SL HAYES S-W S SD
 SOUTH CASINO BEACH
 CASINO BEACH CONDO #3
 TRACT 2, UNIT 2

		YEAR	2010		
	LAND	84,480			
	BLDG				
	DWLG	299,100(1)			
	TOTAL	383,580			
	NET TX				

DEED HOLDER:	DATE REFER	CONTRACT HOLDER:	DATE REFER	YEAR	2009
MARRON FRANCIS O	10082010 5			LAND	84,480
MARRON MARY JO				BLDG	
198 CASINO RD				DWLG	299,100(1)
STORM LAKE IA 50588				TOTAL	383,580
				NET TX	

		YEAR	2008		
ZYLSTRA LAYTON	07082002 4			LAND	79,240
ZYLSTRA BECKI				BLDG	
6 ST ANDREWS CT				DWLG	244,040(1)
ALTA IA 51002				TOTAL	323,280
				NET TX	

DEED HOLDER:	DATE REFER	CONTRACT HOLDER:	DATE REFER	YEAR	2007
OLSON GARRY I	03222001 3			LAND	79,240
OLSON JOYCE E				BLDG	
1405 SHOREWAY RD				DWLG	244,040(1)
STORM LAKE IA				TOTAL	323,280
				NET TX	

		YEAR	2007		
BV BUILDING LLC				LAND	67,150
				BLDG	
600 LAKE AVE				DWLG	206,810(1)
STORM LAKE IA				TOTAL	273,960
				NET TX	

		YEAR	2006		
REMARKS:				LAND	67,150
3 QCD #010484 09-27-00 \$125,000 (D008)				BLDG	
4 W.D. #022135 06-25-02 \$252,000(D008)				DWLG	206,810(1)
5 W.D. #102404 09-10-10 \$365,000(D008)				TOTAL	273,960
				NET TX	

198 CASINO RD, STORM LAKE

Deed: MARRON FRANCIS O, MARRON MARY JO

Map Area: HAYES-RES(CASINO)

Checks/Tags:

Contract:

Route: 915-001-700

Lister/Date: LF, 06/23/2008

CID#: 0950985

Tax Dist: SL HAYES S-W S SD

Review/Date: TG, 12/01/2008

DBA:

Plat Page:

Entry Status: Inspected

MLS: 14843

Subdiv: [NONE]

RURAL/RESIDENTIAL

Legal: 11-00 SL HAYES S-W S SD SOUTH CASINO BEACH CASINO BEACH CONDO #3 TRACT 2, UNIT 2

Land

Land Basis	Front	Rear	Side 1	Side 2	R. Lot	SF	Acres								
FF Main	47.31	39.48	166.45	172.12	0.00										
Sub Total						7,346.12	0.169								
Grand Total						7,346.12	0.169								

Sales				Building Permits				Values					
Date	\$ Amount	NUTC	Recording	Date	Number	Tag	\$ Amount	Reason					
09/10/2010	\$365,000	D8.1	102404	9/11/2000		N	\$280,000	New Dwlg					
06/25/2002	\$252,000	D16	#022135										
09/27/2000	\$125,000	D7	#010484										
09/08/2000	\$130,000	D34.1	#002472										

Res. Structure		Finish				Plumbing				Addition		Garage	
Occ. Code	113	Ttl Rooms Above #	4	Bedrooms Above #	2	Full Bath	1	Addition	1 of 2	Garage	1 of 1		
Occ. Descr.	Condominium	Ttl Rooms Below #	3	Bedrooms Below #	2	Shower Stall Bath	2	Year Built	2000	Style	Att Brick		
Year Built	2000	Bsmt Fin Area #1	1400	Table		Toilet Room		EFA	9	W X L	0' X 0'		
EFA / EFYr	9 / 2000	Bsmt Fin Area #2				Lavatory	1	EFA Year	2000	Area (SF)	600		
Arch. Dsgn	N/A	Bsmt Fin Area #3				Water Closet		Style	1 Sty Frm	Year Built	2000		
Style	1 Story Brick	Foundation	Conc			Sink		Area (SF)	30	EFA	9		
AreaSF/TLA	1,676 / 1,726	Exterior Walls	Brk			Shower Stall/Tub		Condition	Normal	EFF Year	2000		
Condition	NML	Roof	Asph / Hip			Mtl St Sh Bath				Condition	NML		
Basement	Full	Interior Finish	Drwl			Mtl Stall Shower		Bsmt (SF)		Bsmt (SF)			
No Bsmt Flr.	0	Flooring	Carp / Ceramic			No Bathroom		NoBsmt Flr(SF)		Qtrs Over	None		
Heat	FHA - Gas	Non-base Heating		Fireplace		Wet Bar	1	Heat	FHA - Gas	Qtrs Over (SF)			
AC	Yes	Floor/Wall #	0	Gas-Vertical, 2 Sty	1	Whirlpool Bathroom		AC	Yes	Qtrs AC (SF)			
Attic	None	Pipeless #	0			Whirlpool Tub	1	Attic (SF)					
		Hand Fired (Y/N)	No			No Hot Water Tank		See other pages for more additions.					
		Space Heat #	0			No Plumbing				Door Opnrs			
		Appliances				Sewer & Water Only				Bsmt Stalls			
		Range Unit		Built-In Vacuums		Water Only w/Sink							
		Oven - Single		Intercom System		Hot Tub							
		Oven - Double		Bl Stereo		Bidet							
		Dishwasher				FbglS Service Sink							
		Microwave				Urinal							
		Trash Compactor				Sauna							
		Jennair				W'Pool Bath w/Shower							
		Security System				Water Only							
						No Tub/Shower							



Bldg / Addn	Description	Units	Year				
1 of 1	113 — Condominium						
	1 Story Brick	1,676					
#1	Bsmt Fin - Living Qtrs. W/ Walk-out (Avg)	1,400 Tbl					
	Base Heat: FHA - Gas						
	Add Central Air	1,676					
#1	Porch: 1S Brick Open	40 SF					
	Deck #1: Concrete Patio-Med	132 SF					
	Deck #2: Vinyl/CompoDeck-Med	222 SF					
	Plumbing	6					
#1	Fireplace: Gas-Vertical, 2 Story	1					
	Garage: Att Brick	600 SF	2000				
1 of 2 Adtn	1 Story Frame	30 SF	2000				
2 of 2 Adtn	1 Story Frame	20 SF	2000				

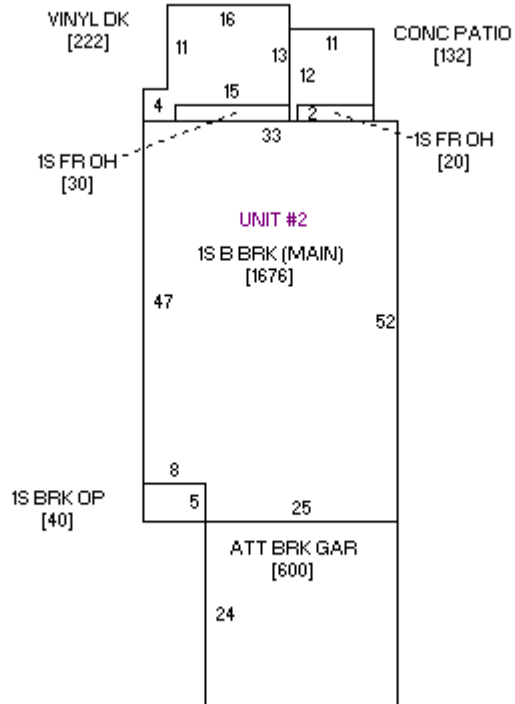

198 CASINO RD



06/26/2008



11/18/2004