

LEGAL DESCRIPTION:

CLASS:

05-90-37  
STORM LAKE HAYES  
PT GOVT LOT 3  
.24 AC SW SE SW  
7.75 AC SE SE SW

R RESIDENTIAL

		CSR'S	.00		
				CODE	VALUE ACRES
GROSS	7.99	CURRENT			
ROADS	.49	LAND	54,000		
D.D.		BLDG			
R.R.		DWLG	105,370( 1)		
MISC					
		TOTAL	159,370		
NET	7.50				

		YEAR	2011		
		LAND	54,000	ROAD	.49
		BLDG			
		DWLG	105,370( 1)		
		TOTAL	159,370		
		NET TX			

DEED HOLDER:	DATE REFER	CONTRACT HOLDER:	DATE REFER	YEAR	2010		
PATTON WILLIAM U	05102011 6			LAND	54,000	ROAD	.49
PATTON DAVID W				BLDG			
606 GENESEO				DWLG	105,370( 1)		
STORM LAKE IA 50588				TOTAL	159,370		
				NET TX			

		YEAR	2009		
BALLOU WILLIAM	05202005 5	LAND	54,000	ROAD	.49
BALLOU DENISE		BLDG			
839 610TH ST		DWLG	105,370( 1)		
STORM LAKE IA 50588		TOTAL	159,370		
		NET TX			

		YEAR	2008		
BALLOU WILLIAM	12152004 4	LAND	57,610	ROAD	.49
BALLOU DENISE		BLDG			
839 610TH ST		DWLG	96,390( 1)		
STORM LAKE IA 50588		TOTAL	154,000		
		NET TX			

		YEAR	2007		
BALLOU WILLIAM	3	LAND	57,610	ROAD	.49
BALLOU DENISE		BLDG			
839 610TH ST		DWLG	96,390( 1)		
STORM LAKE IA 50588		TOTAL	154,000		
		NET TX			

		YEAR	2007		
REMARKS:		LAND	48,820	ROAD	.49
3 W.D. #033790 07-30-03 \$174,000 (D000)		BLDG			
4 W.D. #043948 10-16-04		DWLG	81,680( 1)		
5 W.D. #051105 04-08-05		TOTAL	130,500		
6 W.D. #110938 04-21-11 \$130,540.42		NET TX			



Res. Structure		Finish				Plumbing		Addition		Garage	
Occ. Code	101	Ttl Rooms Above #	6	Bedrooms Above #	3	Full Bath	1	Addition	No Additions	Garage	1 of 1
Occ. Descr.	Single-Family / Owner Occupied	Ttl Rooms Below #	1	Bedrooms Below #	0	Shower Stall Bath		Year Built		Style	Det Frm
Year Built	1976	Bsmt Fin Area #1	175	Table		Toilet Room		EFA		W X L	0' X 0'
EFA / EFYr	33 / 1976	Bsmt Fin Area #2				Lavatory		EFA Year		Area (SF)	528
Arch. Dsgn	N/A	Bsmt Fin Area #3				Water Closet		Style		Year Built	1996
Style	1 Story Frame	Foundation	C Blk			Sink		Area (SF)		EFA	13
AreaSF/TLA	1,196 / 1,196	Exterior Walls	Stl			Shower Stall/Tub		Condition		EFF Year	1996
Condition	NML	Roof	Asph / Gable			Mtl St Sh Bath	1			Condition	BL NML
Basement	Full	Interior Finish	Drwl			Mtl Stall Shower		Bsmt (SF)		Bsmt (SF)	
No Bsmt Flr.	0	Flooring	Carp / Vinyl			No Bathroom		NoBsmt Flr(SF)		Qtrs Over	None
Heat	FHA - Gas	<b>Non-base Heating</b>		<b>Fireplace</b>		Wet Bar		Heat		Qtrs Over (SF)	
AC	Yes	Floor/Wall #	0	Prefab, 1 Sty	1	Whirlpool Bathroom		AC		Qtrs AC (SF)	
Attic	None	Pipeless #	0			Whirlpool Tub		Attic (SF)		Door Opnrs	
		Hand Fired (Y/N)	No			No Hot Water Tank				Bsmt Stalls	
		Space Heat #	0			No Plumbing					
		<b>Appliances</b>				Sewer & Water Only					
		Range Unit	Built-In Vacuums			Water Only w/Sink					
		Oven - Single	Intercom System			Hot Tub					
		Oven - Double	Bl Stereo			Bidet					
		Dishwasher				Fbgl's Service Sink					
		Microwave				Urinal					
		Trash Compactor				Sauna					
		Jennair				W'Pool Bath w/Shower					
		Security System				Water Only					
						No Tub/Shower					



Bldg / Addn	Description	Units	Year						
1 of 1	101 — Single-Family / Owner Occupied								
	1 Story Frame	1,196							
#1	Bsmt Fin - Rec. Room (Single) (Low)	175 Tbl							
	Base Heat: FHA - Gas								
	Add Central Air	1,196							
	Deck #1: Wood Deck-Low	604 SF							
	Deck #2: Concrete Patio-Med	357 SF							
	Plumbing	2							
#1	Fireplace: Prefab, 1 Story	1							
	Garage: Det Frame	0' X 0'	528 SF	1996					

	Count	Ag Building Description	Units		Year					
1 of 5 P:1	1	GARAGE FR @ .20 927-Shed	10' X 20'	200 SF	1900					
2 of 5 P:2	1	GARAGE FR @ .20 927-Shed	10' X 22'	220 SF	1900					
3 of 5 P:3	1	FR @ .90 906-Barn - Flat	24' X 36'	864 SF	1900					
4 of 5 P:4	1	MTL, SLANT SIDES 925-Steel Utility Bldg	48' X 96'	4,608 SF	1976					
5 of 5	1	FR-ATT TO #3 @ .90 908-Lean-To	12' X 22'	264 SF	1900					

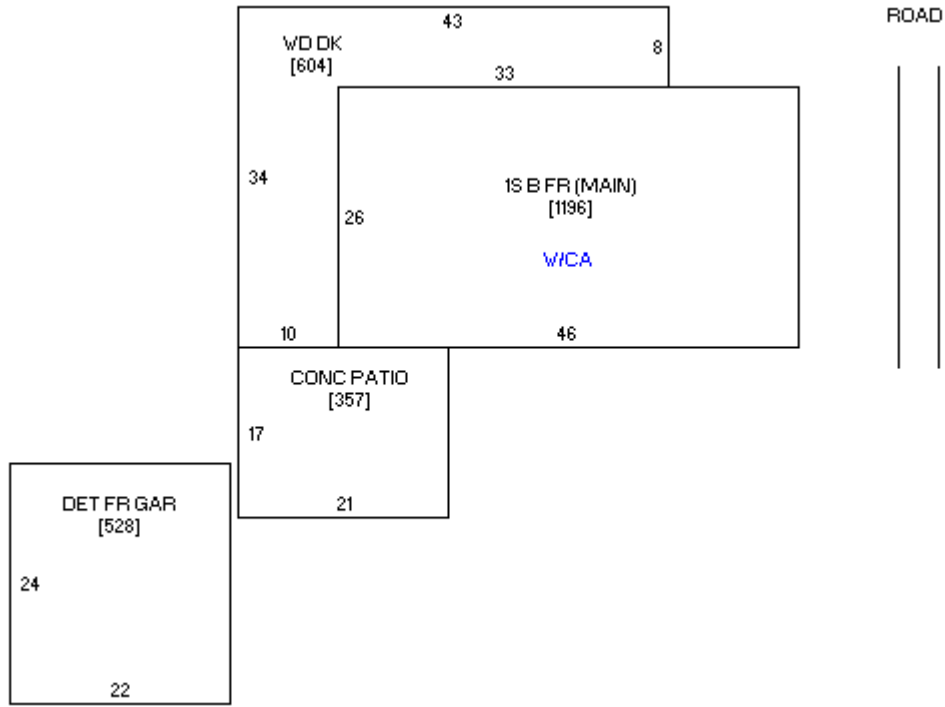



06/26/2008



12/06/2001



05/09/2001