

LEGAL DESCRIPTION:

CLASS:

21-91-38
ALTA NOKOMIS
PT S 1/2 SE 1/4
LYING N OF HWY
(EX LOT A)

R RESIDENTIAL

-----		CSR'S	.00	-----	
				CODE	VALUE ACRES
GROSS		CURRENT			
ROADS		LAND	26,500		
D.D.		BLDG			
R.R.		DWLG	186,240(1)		
MISC					
		TOTAL	212,740		
NET	3.93				

=====		=====		=====	
		YEAR	2011		
		LAND	26,500		
		BLDG			
		DWLG	186,240(1)		
		TOTAL	212,740		
		NET TX			

-----		-----		-----		-----	
DEED HOLDER:	DATE REFER	CONTRACT HOLDER:	DATE REFER	YEAR	2010		
DEHNER MICHAEL A	12142011 2			LAND	26,500		
DEHNER ELLEN R				BLDG			
393 HWY 7				DWLG	186,240(1)		
ALTA IA 51002				TOTAL	212,740		
				NET TX			

-----		-----		-----		-----	
				YEAR	2009		
POTRATZ ROGER W				LAND	26,500		
POTRATZ BRENDA R				BLDG			
393 HWY 7				DWLG	186,240(1)		
ALTA IA 51002				TOTAL	212,740		
				NET TX			

-----		-----		-----		-----	
				YEAR	2008		
				LAND	34,610		
				BLDG			
				DWLG	168,810(1)		
				TOTAL	203,420		
				NET TX			

-----		-----		-----		-----	
				YEAR	2007		
REMARKS:				LAND	34,610		
				BLDG			
2 W.D. #113017 10-31-11 \$215,000				DWLG	168,810(1)		
				TOTAL	203,420		
				NET TX			

-----		-----		-----		-----	
				YEAR	2007		
				LAND	29,330		
				BLDG			
				DWLG	143,060(1)		
				TOTAL	172,390		
				NET TX			

393 HWY 7, ALTA

Deed: **DEHNER MICHAEL A,DEHNER ELLEN R**
 Contract:
 CID#: **1097250**
 DBA:
 MLS: **14818**

Map Area: **NOKOMIS-RES**
 Route: **909-001-760**
 Tax Dist: **ALTA NOKOMIS**
 Plat Page:
 Subdiv: **[NONE]**

Checks/Tags:
 Lister/Date: **MA, 07/30/2008**
 Review/Date: **DS, 11/05/2008**
 Entry Status: **Inspected**

RURAL/RESIDENTIAL

Legal:21-91-38 ALTA NOKOMIS PT S 1/2 SE 1/4 LYING N OF HWY (EX LOT A)

Land

Land Basis	Front	Rear	Side 1	Side 2	R. Lot	SF	Acres								
Site-Excess							1.000								
Excess 1							2.930								
Sub Total						171,190.80	3.930								
Grand Total						171,190.80	3.930								

Sales				Building Permits				Values					
Date	\$ Amount	NUTC	Recording	Date	Number	Tag	\$ Amount	Reason					
10/31/2011	\$215,000	D0	113017										
09/19/2000	\$34,000	D34.1	002704										

Res. Structure		1 of 1		Finish				Plumbing				Addition		Garage	
Occ. Code	101	Ttl Rooms Above #	6	Bedrooms Above #	3	Full Bath	2	Addition	No Additions	Garage	1 of 1				
Occ. Descr.	Single-Family / Owner Occupied	Ttl Rooms Below #	3	Bedrooms Below #	1	Shower Stall Bath	1	Year Built		Style	Att Frm				
Year Built	2000	Bsmt Fin Area #1	1550	Table		Toilet Room		EFA		W X L	0' X 0'				
EFA / EFYr	9 / 2000	Bsmt Fin Area #2				Lavatory	1	EFA Year		Area (SF)	1,268				
Arch. Dsgn	N/A	Bsmt Fin Area #3				Water Closet		Style		Year Built	2000				
Style	1 Story Frame	Foundation	Conc			Sink		Area (SF)		EFA	9				
AreaSF/TLA	1,568 / 1,568	Exterior Walls	Vinyl			Shower Stall/Tub		Condition		EFF Year	2000				
Condition	NML	Roof	Asph / Gable			Mtl St Sh Bath				Condition	NML				
Basement	Full	Interior Finish	Drwl			Mtl Stall Shower		Bsmt (SF)		Bsmt (SF)					
No Bsmt Flr.	0	Flooring	Carp / Vinyl			No Bathroom		NoBsmt Flr(SF)		Qtrs Over	None				
Heat	FHA - Gas	Non-base Heating		Fireplace		Wet Bar		Heat		Qtrs Over (SF)					
AC	Yes	Floor/Wall #	0			Whirlpool Bathroom		AC		Qtrs AC (SF)					
Attic	None	Pipeless #	0			Whirlpool Tub		Attic (SF)		Door Opnrs					
		Hand Fired (Y/N)	No			No Hot Water Tank				Bsmt Stalls					
		Space Heat #	0			No Plumbing									
		Appliances				Sewer & Water Only									
		Range Unit	Built-In Vacuums			Water Only w/Sink									
		Oven - Single	Intercom System			Hot Tub									
		Oven - Double	Bl Stereo			Bidet									
		Dishwasher				FbglS Service Sink									
		Microwave				Urinal									
		Trash Compactor				Sauna									
		Jennair				W'Pool Bath w/Shower									
		Security System				Water Only									
						No Tub/Shower									



Bldg / Addn	Description	Units	Year						
1 of 1	101 — Single-Family / Owner Occupied								
	1 Story Frame	1,568							
#1	Bsmt Fin - Living Qtrs. (Multi) (Avg)	1,550 Tbl							
	Base Heat: FHA - Gas								
	Add Central Air	1,568							
#1	Porch: Frame 3 Seasons	180 SF							
	Deck #1: Concrete Patio-Med	112 SF							
	Deck #2: Wood Deck-Med	352 SF							
	Plumbing	4							
	Garage: Att Frame	1,268 SF	2000						

	Description	Units	Cond	Year							
P:1	Yrd 1 — Sheds		NML	2002							

Y-1
10 [100]
10
SHED

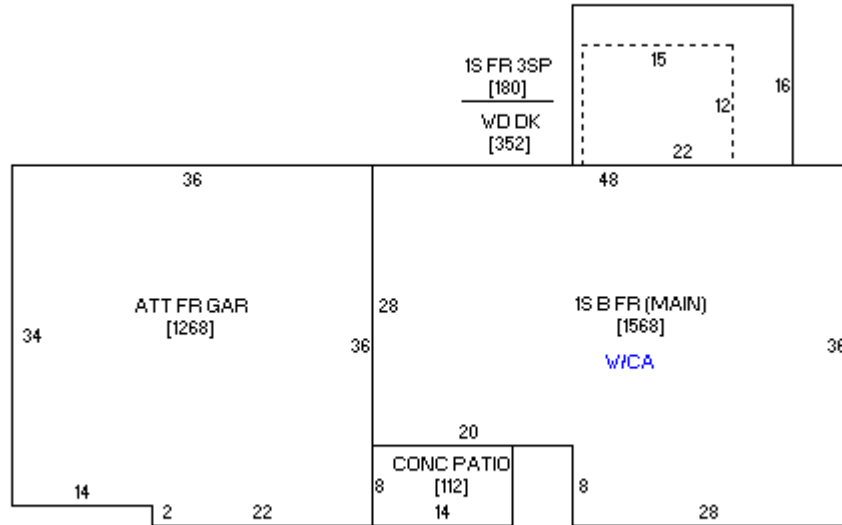

09/18/2008



11/01/2001