

Pin: 04-05-400-008

Sale Date: 11/01/11

Sale Price: \$150,000

Net Acres: 2.79

Classification: Change in Use from  
Ag to Rural Residential

04-05-400-008

50  
#7985.20 *Subst*

R-Res

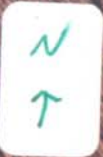

LOCATION: 2073 430TH ST

DISTRICT: 00350 REF #:

PARCEL #: 04-05-400-008

ALT ID:

0000798550

LEGAL DESCRIPTION:

CLASS:

05-93-35 A AGRICULTURE  
LAUR. MARA. POLAND  
TRACT IN S 1/2 SE

-----		CSR'S	234.36		
				CODE	VALUE ACRES
GROSS	3.05	CURRENT			
ROADS	.22	LAND	5,200		
D.D.		BLDG	5,390( 3)		
R.R.		DWLG	65,710( 1)		
MISC					
		TOTAL	76,300		
NET	2.79				

=====		=====		=====	
		YEAR	2011		
		LAND	5,200	ROAD	.22
		BLDG	5,390( 3)		
		DWLG	65,710( 1)		
		TOTAL	76,300		
		NET TX			

-----		-----		-----	
DEED HOLDER:	DATE REFER	CONTRACT HOLDER:	DATE REFER	YEAR	2010
J & C WILLFARMS INC	12132011 4			LAND	4,110
				BLDG	4,720( 3)
				DWLG	65,710( 1)
				TOTAL	74,540
				NET TX	

-----		-----		-----	
HANSEN CLIFFORD K TRUST	02232005 3			YEAR	2009
				LAND	4,110
				BLDG	4,720( 3)
				DWLG	65,710( 1)
				TOTAL	74,540
				NET TX	

-----		-----		-----	
HANSEN BETTY L TRUSTEE	08282000 2			YEAR	2008
				LAND	2,520
				BLDG	7,000( 3)
				DWLG	47,260( 1)
				TOTAL	56,780
				NET TX	

-----		-----		-----	
HANSEN CLIFFORD K TRUSTEE	2			YEAR	2007
				LAND	2,520
				BLDG	7,000( 3)
				DWLG	47,260( 1)
				TOTAL	56,780
				NET TX	

-----		-----		-----	
REMARKS:				YEAR	2007
				LAND	2,050
				BLDG	7,000( 3)
				DWLG	40,050( 1)
				TOTAL	49,100
				NET TX	

2 WD #001777 06/28/00 (D020)  
3 W.D. #050274 01-10-05  
4 W.D. #113112 11-01-11 \$150,000



Res. Structure		Finish				Plumbing		Addition		Garage	
Occ. Code	101	Ttl Rooms Above #	7	Bedrooms Above #	3	Full Bath	2	Addition	1 of 1	Garage	No garages
Occ. Descr.	Single-Family / Owner Occupied	Ttl Rooms Below #	0	Bedrooms Below #	0	Shower Stall Bath		Year Built	1920	Style	
Year Built	1920	Bsmt Fin Area #1				Toilet Room		EFA	89	W X L	
EFA / EFYr	89 / 1920	Bsmt Fin Area #2				Lavatory		EFA Year	1920	Area (SF)	
Arch. Dsgn	N/A	Bsmt Fin Area #3				Water Closet		Style	1 Sty Frm	Year Built	
Style	2 Story Frame	Foundation	C Blk			Sink		Area (SF)	160	EFA	
AreaSF/TLA	840 / 1,840	Exterior Walls	Vinyl			Shower Stall/Tub		Condition	Above Normal	EFF Year	
Condition	A NML	Roof	Asph / Gambrel			Mtl St Sh Bath					
Basement	Full	Interior Finish	Plas			Mtl Stall Shower		Bsmt (SF)		Condition	
No Bsmt Flr.	0	Flooring	Carp / Vinyl			No Bathroom		NoBsmt Flr(SF)		Bsmt (SF)	
Heat	Yes	<b>Non-base Heating</b>		<b>Fireplace</b>		Wet Bar		Heat	Yes	Qtrs Over	
AC	Yes	Floor/Wall #	0			Whirlpool Bathroom		AC	Yes	Qtrs Over (SF)	
Attic	None	Pipeless #	0			Whirlpool Tub		Attic (SF)		Qtrs AC (SF)	
		Hand Fired (Y/N)	No			No Hot Water Tank				Door Opnrs	
		Space Heat #	0			No Plumbing				Bsmt Stalls	
		<b>Appliances</b>				Sewer & Water Only					
		Range Unit	Built-In Vacuums			Water Only w/Sink					
		Oven - Single	Intercom System			Hot Tub					
		Oven - Double	Bl Stereo			Bidet					
		Dishwasher				FbglS Service Sink					
		Microwave				Urinal					
		Trash Compactor				Sauna					
		Jennair				W'Pool Bath w/Shower					
		Security System				Water Only					
						No Tub/Shower					



Bldg / Addn	Description	Units	Year					
1 of 1	101 — Single-Family / Owner Occupied							
	2 Story Frame	840						
	Base Heat							
	Add Central Air	840						
	Deck #1: Wood Deck-Med	184 SF						
	Plumbing	2						
1 of 1	Adtn 1 Story Frame	160 SF	1920					

	Count	Ag Building Description	Units		Year						
1 of 3 P:1	1	MTL POLE LESTER 925-Steel Utility Bldg	50' X 100'	5,000 SF	1976						
2 of 3 P:2	1	TOOL FR @ .90 927-Shed	16' X 24'	384 SF	1900						
3 of 3 P:3	1	FR @ .90 906-Barn - Flat	32' X 40'	1,280 SF	1900						

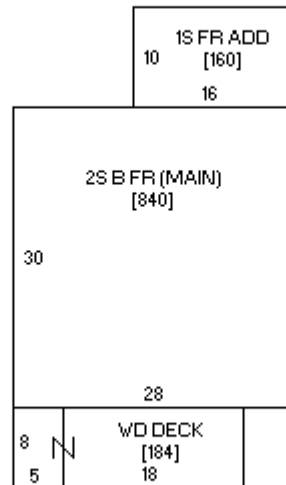



08/25/2008