

LEGAL DESCRIPTION:	CLASS:	-----	CSR'S	.00	-----	CODE	VALUE	ACRES
			GROSS	CURRENT				
25-01	R RESIDENTIAL		ROADS	LAND	218,100			
SL HAYES S-W S SD			D.D.	BLDG				
SCHALLERS S/D GOVT			R.R.	DWLG	99,660(1)			
LOTS 3&4 SEC 15-90-37			MISC					
& NW 3' LOT 24				TOTAL	317,760			
			NET					

		-----	YEAR	2012	-----			
			LAND	218,100				
			BLDG					
			DWLG	99,660(1)				
			TOTAL	317,760				
			NET TX					

DEED HOLDER:	DATE REFER	CONTRACT HOLDER:	DATE REFER	YEAR	2011	-----			
RETTINGER LEONARD LOUIS III	09182012 3			LAND	218,100				
				BLDG					
257 SOUTH SHORE DR				DWLG	99,660(1)				
STORM LAKE IA 50588				TOTAL	317,760				
				NET TX					

DEED HOLDER:	DATE REFER	CONTRACT HOLDER:	DATE REFER	YEAR	2010	-----			
ANDERSON RUTH A	09182012 2			LAND	218,100				
				BLDG					
709 ANGLIER DR				DWLG	99,660(1)				
STORM LAKE IA 50588				TOTAL	317,760				
				NET TX					

DEED HOLDER:	DATE REFER	CONTRACT HOLDER:	DATE REFER	YEAR	2009	-----			
ANDERSON THOMAS N	1			LAND	218,100				
ANDERSON RUTH A				BLDG					
709 ANGLIER DR				DWLG	99,660(1)				
STORM LAKE IA 50588				TOTAL	317,760				
				NET TX					

REMARKS:	YEAR	2008	-----			
1 W.D. 52/455 11-23-82 \$76,000	LAND	147,830				
2 DEATH CERT FILED W/AUD 09-12-12	BLDG					
3 W.D. #122468 08-31-12 \$290,000	DWLG	117,610(1)				
	TOTAL	265,440				
	NET TX					

REMARKS:	YEAR	2007	-----			
	LAND	147,830				
	BLDG					
	DWLG	117,610(1)				
	TOTAL	265,440				
	NET TX					

245 SOUTH SHORE DR, STORM LAKE

Deed: **RETINGER LEONARD LOUIS III**

Map Area: **HAYES-RES(SCHALLERS)**

Checks/Tags:

Contract:

Route: **915-002-500**

Lister/Date: **LF, 06/16/2008**

CID#: **0955700**

Tax Dist: **SL HAYES S-W S SD**

Review/Date: **TG, 12/02/2008**

DBA:

Plat Page: -

Entry Status: **Inspected**

MLS:

Subdiv: **[NONE]**

RURAL/RESIDENTIAL

Legal: 25-01 SL HAYES S-W S SD SCHALLERS S/D GOVT LOTS 3&4 SEC 15-90-37 & NW 3' LOT 24

Land

Land Basis	Front	Rear	Side 1	Side 2	R. Lot	SF	Acres							
FF Main	103.00	103.00	300.00	270.00	0.00									
Sub Total						29,355.00	0.674							
Grand Total						29,355.00	0.674							

Sales				Building Permits				Values					
Date	\$ Amount	NUTC	Recording	Date	Number	Tag	\$ Amount	Reason					
08/31/2012	\$290,000	D0	122468										
11/23/1982	\$76,000	D0											

Res. Structure		1 of 1		Finish				Plumbing				Addition		Garage									
Occ. Code	101	Ttl Rooms Above #	7	Bedrooms Above #	3	Full Bath	1	Addition	1 of 1	Garage	1 of 1	Occ. Descr.	Single-Family / Owner Occupied	Ttl Rooms Below #	1	Bedrooms Below #	0	Shower Stall Bath		Year Built	1949	Style	Att Frm
Year Built	1949	Bsmt Fin Area #1	275	Table		Toilet Room	1	EFA	60	W X L	0' X 0'	Year Built	1949	Bsmt Fin Area #2				Lavatory		EFA Year	1949	Area (SF)	640
EFA / EFYr	60 / 1949	Bsmt Fin Area #3				Water Closet		Style	1 Sty Frm	Year Built	1949	Condition	Above Normal	Foundation	C Bk			Sink	1	Area (SF)	252	EFA	60
Arch. Dsgn	N/A					Shower Stall/Tub		Condition	Above Normal	EFF Year	1949	Condition	A NML	Exterior Walls	Vinyl			Mtl St Sh Bath		Bsmt (SF)		Condition	A NML
Style	1 1/2 Story Frame					Mtl Stall Shower		Bsmt (SF)		Condition	A NML	Condition	A NML	Roof	Asph / Gambrel			No Bathroom		NoBsmt Flr(SF)		Condition	A NML
AreaSF	782 /					No Plumbing		NoBsmt Flr(SF)		Condition	A NML	Condition	A NML	Interior Finish	Plas			Wet Bar		Heat	FHA - Gas	Condition	A NML
Condition	A NML					Whirlpool Bathroom		Heat	FHA - Gas	Condition	A NML	Condition	A NML	Flooring	Carp / Hdwd			Whirlpool Tub		AC	Yes	Condition	A NML
Basement	Full	Non-base Heating		Fireplace		No Hot Water Tank		AC	Yes	Condition	A NML	Condition	A NML	Space Heat #	0			No Plumbing		Attic (SF)		Condition	A NML
No Bsmt Flr.	0	Floor/Wall #	0	Masonry w/1 Extra, 2 Sty	1	Sewer & Water Only		Attic (SF)		Condition	A NML	Condition	A NML					Water Only w/Sink				Condition	A NML
Heat	FHA - Gas	Pipeless #	0			Water Only w/Sink				Condition	A NML	Condition	A NML					Hot Tub				Condition	A NML
AC	Yes	Hand Fired (Y/N)	No			Hot Tub				Condition	A NML	Condition	A NML					Bidet				Condition	A NML
Attic	None	Space Heat #	0			Bidet				Condition	A NML	Condition	A NML					Fbgl's Service Sink				Condition	A NML
		Appliances								Condition	A NML	Condition	A NML					Urinal				Condition	A NML
		Range Unit		Built-In Vacuums						Condition	A NML	Condition	A NML					Sauna				Condition	A NML
		Oven - Single		Intercom System						Condition	A NML	Condition	A NML					W'Pool Bath w/Shower				Condition	A NML
		Oven - Double		Bl Stereo						Condition	A NML	Condition	A NML					Water Only				Condition	A NML
		Dishwasher								Condition	A NML	Condition	A NML					No Tub/Shower				Condition	A NML
		Microwave								Condition	A NML	Condition	A NML									Condition	A NML
		Trash Compactor								Condition	A NML	Condition	A NML									Condition	A NML
		Jennair								Condition	A NML	Condition	A NML									Condition	A NML
		Security System								Condition	A NML	Condition	A NML									Condition	A NML



Bldg / Addn	Description	Units	Year
1 of 1	101 — Single-Family / Owner Occupied		
	1 1/2 Story Frame	782	
#1	Bsmt Fin - Rec. Room (Single) (Low)	275 Tbl	
	Base Heat: FHA - Gas		
	Add Central Air	782	
	Deck #1: Concrete Patio-Low	463 SF	
	Plumbing	3	
#1	Fireplace: Masonry w/1 Extra, 2 Story	1	
	Garage: Att Frame	640 SF	1949
1 of 1 Adtn	1 Story Frame	252 SF	1949

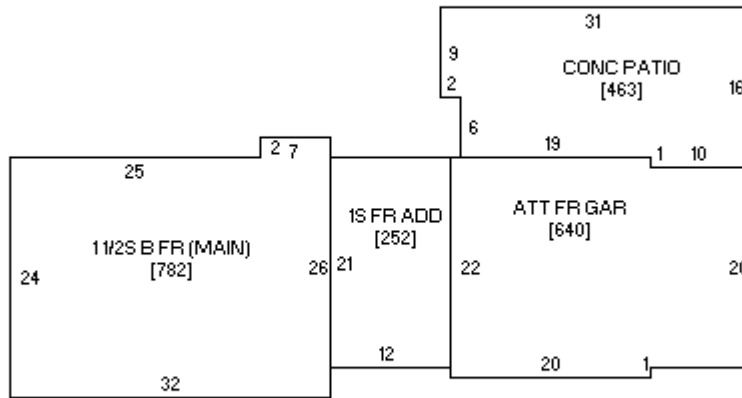



06/26/2008



05/01/1998