

LEGAL DESCRIPTION:

CLASS:

-----		CSR'S	.00	-----	
				CODE	VALUE ACRES
GROSS	CURRENT				
ROADS	LAND	13,130			
D.D.	BLDG				
R.R.	DWLG	51,540( 1)			
MISC					
	TOTAL	64,670			
NET					

29-00 R RESIDENTIAL  
 ALTA WASH LC AREA SSD  
 LAKE CREEK VILLA 1  
 #206-U

=====		=====		=====	
		YEAR	2011		
	LAND	13,130			
	BLDG				
	DWLG	51,540( 1)			
	TOTAL	64,670			
	NET TX				

-----		-----		-----		-----	
DEED HOLDER:	DATE REFER	CONTRACT HOLDER:	DATE REFER	YEAR	2010		
SALUS LLC	02142012 6			LAND	13,130		
				BLDG			
				DWLG	51,540( 1)		
				TOTAL	64,670		
				NET TX			

-----		-----		-----		-----	
NITCHALS LORI K	07072009 5			YEAR	2009		
206 VILLA RD				LAND	13,130		
ALTA IA 51002				BLDG			
				DWLG	51,540( 1)		
				TOTAL	64,670		
				NET TX			

-----		-----		-----		-----	
LOEW ARICK	07282003 4			YEAR	2008		
206 VILLA RD				LAND	13,030		
ALTA IA 51002				BLDG			
				DWLG	49,540( 1)		
				TOTAL	62,570		
				NET TX			

-----		-----		-----		-----	
ANDERSON JONI K	3			YEAR	2007		
1620 MAPLECREST DR				LAND	13,030		
ESTHERVILLE IA				BLDG			
				DWLG	49,540( 1)		
				TOTAL	62,570		
				NET TX			

-----		-----		-----		-----	
REMARKS:				YEAR	2007		
3 W.D. #992640 08-02-99 \$49,000 (D008)				LAND	11,040		
4 W.D. #033110 06-19-03 \$49,950 (D008)				BLDG			
5 W.D. #091840 06-12-09 \$65,000 (D008)				DWLG	41,990( 1)		
6 W.D. #120299 02-01-12 \$68,000				TOTAL	53,030		
				NET TX			

206 VILLA RD, ALTA

Deed: SALUS LLC

Map Area: WASH-RES(LAKE CREEK)

Checks/Tags:

Contract:

Route: 910-003-330

Lister/Date: LF, 08/07/2008

CID#: 0983100

Tax Dist: ALTA WASH LC AREA SSD

Review/Date: DS, 12/09/2008

DBA:

Plat Page: -

Entry Status: Inspected

MLS:

Subdiv: [NONE]

RURAL/RESIDENTIAL

Legal: 29-00 ALTA WASH LC AREA SSD LAKE CREEK VILLA 1 #206-U

Land

Land Basis	Front	Rear	Side 1	Side 2	R. Lot	SF	Acres							
SqFt X Rate						5,250.00	0.121							
Grand Total						5,250.00	0.121							

Sales				Building Permits				Values					
Date	\$ Amount	NUTC	Recording	Date	Number	Tag	\$ Amount	Reason					
02/01/2012	\$68,000	D0	120299										
06/12/2009	\$65,000	D0	091840										
06/19/2003	\$49,950	D0	033110										
08/02/1999	\$49,000	D0	992640										

Res. Structure 1 of 1		Finish				Plumbing		Addition		Garage	
Occ. Code	113	Ttl Rooms Above #	4	Bedrooms Above #	2	Full Bath	1	Addition	No Additions	Garage	1 of 1
Occ. Descr.	Condominium	Ttl Rooms Below #	0	Bedrooms Below #	0	Shower Stall Bath	1	Year Built		Style	Det Frm
Year Built	1973	Bsmt Fin Area #1				Toilet Room		EFA		W X L	14' X 22'
EFA / EFYr	36 / 1973	Bsmt Fin Area #2				Lavatory		EFA Year		Area (SF)	308
Arch. Dsgn	N/A	Bsmt Fin Area #3				Water Closet		Style		Year Built	1973
Style	1 Story Frame	Foundation	Conc			Sink		Area (SF)		EFA	36
AreaSF/TLA	1,176 / 1,176	Exterior Walls	BRICK VENNER			Shower Stall/Tub		Condition		EFF Year	1973
Condition	NML	Roof	Asph / Gable			Mtl St Sh Bath					
Basement	None	Interior Finish	Drwl			Mtl Stall Shower		Bsmt (SF)		Condition	NML
No Bsmt Flr.	0	Flooring	Carp / Vinyl			No Bathroom		NoBsmt Flr(SF)		Bsmt (SF)	
Heat	FHA - Electric	<b>Non-base Heating</b>		<b>Fireplace</b>		Wet Bar		Heat		Qtrs Over	None
AC	Yes	Floor/Wall #	0			Whirlpool Bathroom		AC		Qtrs Over (SF)	
Attic	None	Pipeless #	0			Whirlpool Tub		Attic (SF)		Qtrs AC (SF)	
		Hand Fired (Y/N)	No			No Hot Water Tank					
		Space Heat #	0			No Plumbing				Door Opnrs	
		<b>Appliances</b>				Sewer & Water Only				Bsmt Stalls	
		Range Unit	Built-In Vacuums			Water Only w/Sink					
		Oven - Single	Intercom System			Hot Tub					
		Oven - Double	BI Stereo			Bidet					
		Dishwasher				FbglS Service Sink					
		Microwave				Urinal					
		Trash Compactor				Sauna					
		Jennair				W'Pool Bath w/Shower					
		Security System				Water Only					
						No Tub/Shower					



Bldg / Addn	Description	Units	Year						
1 of 1	113 — Condominium								
	1 Story Frame	1,176							
	Adjustment for basement - None								
	Base Heat: FHA - Electric								
	Add Central Air	1,176							
	Plumbing	2							
BEx	1/8TH COMMON AREA	126 SF							
	Garage: Det Frame	14' X 22'	308 SF	1973					

	Description	Units	Cond	Year									
P:0	Yrd 1 — 2-12 X 22 ASSOC GAR(1/20th)		NML	1973									

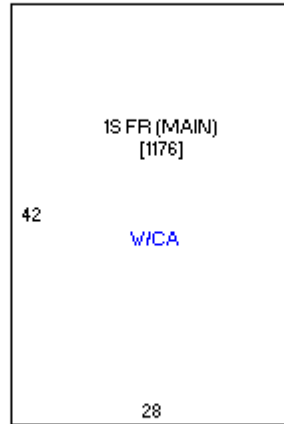

08/18/2008



05/01/1998