

LEGAL DESCRIPTION:

CLASS:

-----		CSR'S	.00		
				CODE	VALUE ACRES
GROSS	22.14	CURRENT			
ROADS	1.74	LAND	46,560		
D.D.		BLDG			
R.R.		DWLG	429,780( 1)		
MISC					
		TOTAL	476,340		
NET	20.40				

28-91-36 R RESIDENTIAL  
 STORM LAKE GRANT  
 LOT B IN N 1/2 NW 1/4

=====		=====		=====	
		YEAR	2013		
		LAND	46,560	ROAD	1.74
		BLDG			
		DWLG	429,780( 1)		
		TOTAL	476,340		
		NET TX			

DEED HOLDER:	DATE REFER	CONTRACT HOLDER:	DATE REFER	YEAR	2012		
				LAND	46,560	ROAD	1.74
HAMANN JOSHUA C	08292013 5			BLDG			
HAMANN KEIRA C				DWLG	429,780( 1)		
1528 580TH ST				TOTAL	476,340		
STORM LAKE IA 50588				NET TX			

				YEAR	2011		
				LAND	46,560	ROAD	1.74
WHITMORE FAMILY TRUST	08292013 4			BLDG			
				DWLG	429,780( 1)		
1528 580TH ST				TOTAL	476,340		
STORM LAKE IA 50588				NET TX			

				YEAR	2010		
				LAND	46,560	ROAD	1.74
WHITMORE ROBERT L II	01232009 3			BLDG			
WHITMORE RUTH E				DWLG	207,900		
1528 580TH ST				TOTAL	254,460		
STORM LAKE IA 50588				NET TX			

				YEAR	2009		
				LAND	17,990	ROAD	1.74
REMARKS:				BLDG			
				DWLG			
1 09)SPLIT FROM -001 & -005 (01/23/09)				TOTAL	17,990		
3 WD #083175 11/03/08 \$80,000 (D026)				NET TX			
4 W.D. #132249 07-30-13				-----		-----	

				YEAR	2009 REFER: 1		
				LAND	11,020		
				BLDG			
				DWLG			
				TOTAL	11,020		
				NET TX			



Res. Structure		Finish				Plumbing		Addition		Garage	
Occ. Code	101	Ttl Rooms Above #	9	Bedrooms Above #	4	Full Bath	2	Addition	1 of 3	Garage	1 of 1
Occ. Descr.	Single-Family / Owner Occupied	Ttl Rooms Below #	5	Bedrooms Below #	1	Shower Stall Bath	1	Year Built	2009	Style	Att Frm
Year Built	2009	Bsmt Fin Area #1	1600	Table		Toilet Room		EFA	1	W X L	0' X 0'
EFA / EFYr	1 / 2009	Bsmt Fin Area #2				Lavatory	1	EFA Year	2009	Area (SF)	852
Arch. Dsgn	N/A	Bsmt Fin Area #3				Water Closet		Style	1 Sty Frm	Year Built	2009
Style	1 1/2 Story Frame	Foundation	Conc			Sink	1	Area (SF)	100	EFA	1
AreaSF/TLA	959 / 3,253	Exterior Walls	Composite			Shower Stall/Tub	1	Condition	Normal	EFF Year	2009
GLA 1st/2nd	2,052 / 1,201	Roof	Mtl / Gable			Mtl St Sh Bath				Condition	NML
		Interior Finish	Drwl			Mtl Stall Shower		Bsmt (SF)		Bsmt (SF)	
		Flooring	Carp / Tile / Hdwd			No Bathroom		NoBsmt Flr(SF)		Qtrs Over	Frame
		<b>Non-base Heating</b>		<b>Fireplace</b>		Wet Bar		Heat	Yes	Qtrs Over (SF)	530
		Floor/Wall #	0	Prefab, 1 1/2 Sty	1	Whirlpool Bathroom		AC	Yes	Qtrs AC (SF)	530
		Pipeless #	0			Whirlpool Tub		Attic (SF)			
		Hand Fired (Y/N)	No			No Hot Water Tank		See other pages for more additions.			
		Space Heat #	0			No Plumbing				Door Opnrs	
Condition	NML	<b>Appliances</b>				Sewer & Water Only				Bsmt Stalls	
		Range Unit		Built-In Vacuums		Water Only w/Sink					
Basement	Full	Oven - Single		Intercom System		Hot Tub					
No Bsmt Flr.	0	Oven - Double		BI Stereo		Bidet					
Heat	Yes	Dishwasher				FbglS Service Sink					
AC	Yes	Microwave				Urinal					
Attic	None	Trash Compactor				Sauna					
		Jennair				W'Pool Bath w/Shower					
		Security System				Water Only					
						No Tub/Shower					



Bldg / Addn 1 of 1	Description	Units	Year			
	101 — Single-Family / Owner Occupied					
	1 1/2 Story Frame	959				
#1	Bsmt Fin - Living Qtrs. W/ Walk-out (Avg)	1,600 Tbl				
	Base Heat					
	Add Central Air	959				
#1	Porch: 1S Frame Open	226 SF				
	Deck #1: Brick/Blk Patio-Med	381 SF				
	Deck #2: Wood Deck-Med	381 SF				
	Deck #3: Fbgls/Mtl Roof-Med	381 SF				
	Veneer #1 1/2 Story Brick	254.0 LF				
	Plumbing	6				
#1	Fireplace: Prefab, 1 1/2 Story	1				
	Garage: Att Frame	852 SF	2009			
1 of 3	Adtn 1 Story Frame	100 SF	2009			
2 of 3	Adtn High Ceiling-Frame	360 SF	2009			
3 of 3	Adtn 1 Story Frame	633 SF	2009			

Count	Ag Building Description	Units	Year
1 of 1 P:1	MTL/FR with LOFT 906-Barn - Flat	36' X 60' 2,160 SF	2009

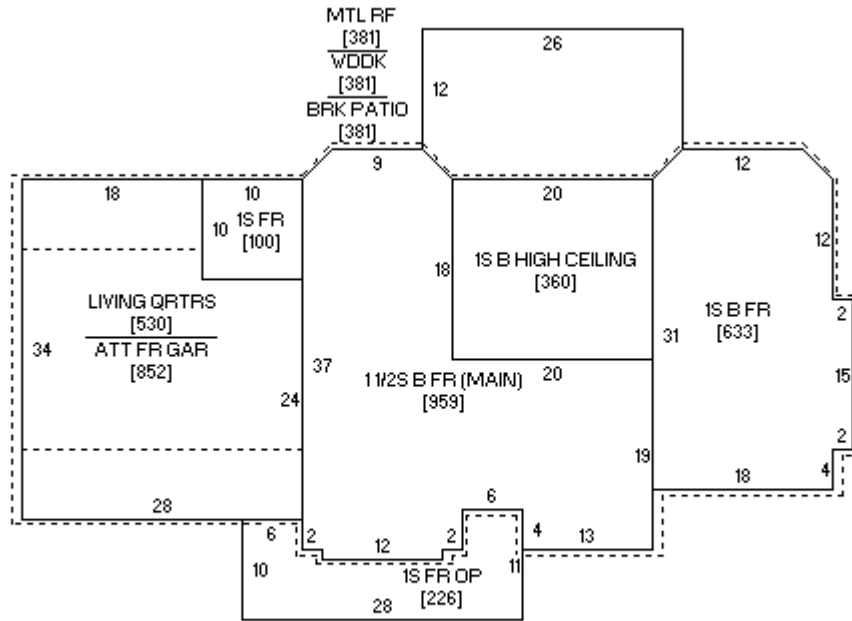

254 LF 1/2S BRK

Sketch 1 of 1

