

LEGAL DESCRIPTION:

CLASS:

----- CSR'S		.00		
			CODE	VALUE ACRES
GROSS	CURRENT			
ROADS	LAND	36,160		
D.D.	BLDG			
R.R.	DWLG	229,800 (1)		
MISC				
	TOTAL	265,960		
NET				

30-91-37 R RESIDENTIAL
 ALTA WASH LC AREA SSD
 AUD S/D SW FR 1/4
 LOT 28-C (EX S 4')

===== =====		=====	=====	
		YEAR	2013	
	LAND		36,160	
	BLDG			
	DWLG		229,800 (1)	
	TOTAL		265,960	
	NET TX			

-----		-----	-----	-----	-----
DEED HOLDER:	DATE REFER	CONTRACT HOLDER:	DATE REFER	YEAR	2012
HALL TOM SCOTT	02212013 6			LAND	36,160
HALL LYNN MARIE				BLDG	
30 FAIRWAY DR				DWLG	229,800 (1)
ALTA IA 51002				TOTAL	265,960
				NET TX	

-----		-----	-----	-----	-----
TODD MICHAEL H	06152000 3			YEAR	2011
TODD PATRICIA H				LAND	36,160
1 ST ANDREWS DR				BLDG	
STORM LAKE IA 50588				DWLG	229,800 (1)
				TOTAL	265,960
				NET TX	

-----		-----	-----	-----	-----
PAGE CHARLES KIRK	03021994 2			YEAR	2010
COLVIN LISA J				LAND	36,160
30 FAIRWAY DR				BLDG	
ALTA IA				DWLG	229,800 (1)
				TOTAL	265,960
				NET TX	

-----		-----	-----	-----	-----
MC CORMICK SUSAN E	1			YEAR	2009 REFER: 5
				LAND	36,160
				BLDG	
				DWLG	229,800 (1)
				TOTAL	265,960
				NET TX	

-----		-----	-----	-----	-----
REMARKS:				YEAR	2009
1 CHG TITLE 54/926 12-23-86				LAND	36,160
2 W.D. 59/945 01-25-94 \$19,000 (D034)				BLDG	
3 WD #001367 05-12-00 \$180,000 (D000)				DWLG	229,800 (1)
5 2009 INFORMAL BOARD HEARING				TOTAL	265,960
6 W.D. #130302 01-29-13 \$220,000				NET TX	

Res. Structure		Finish				Plumbing		Addition		Garage	
Occ. Code	101	Ttl Rooms Above #	8	Bedrooms Above #	4	Full Bath	1	Addition	1 of 2	Garage	1 of 1
Occ. Descr.	Single-Family / Owner Occupied	Ttl Rooms Below #	1	Bedrooms Below #	0	Shower Stall Bath	2	Year Built	1996	Style	Att Frm
Year Built	1996	Bsmt Fin Area #1	300	Table		Toilet Room	1	EFA	13	W X L	0' X 0'
EFA / EFYr	13 / 1996	Bsmt Fin Area #2	100	Table		Lavatory		EFA Year	1996	Area (SF)	1,049
Arch. Dsgn	N/A	Bsmt Fin Area #3				Water Closet		Style	1 Sty Frm	Year Built	1996
Style	2 Story Frame	Foundation	Conc			Sink		Area (SF)	22	EFA	13
AreaSF/TLA	912 / 2,320	Exterior Walls	Stl			Shower Stall/Tub		Condition	Normal	EFF Year	1996
GLA 1st/2nd	1,102 / 1,218	Roof	Asph / Hip			Mtl St Sh Bath		Bsmt (SF)		Condition	NML
		Interior Finish	Drwl			Mtl Stall Shower		NoBsmt Flr(SF)		Bsmt (SF)	
		Flooring	Carp / Vinyl			No Bathroom		Heat	FHA - Gas	Qtrs Over	Frame
		Non-base Heating		Fireplace		Wet Bar		AC	Yes	Qtrs Over (SF)	306
		Floor/Wall #	0	Gas/Elec-Side, 1 Sty	1	Whirlpool Bathroom		Attic (SF)		Qtrs AC (SF)	306
		Pipeless #	0			Whirlpool Tub		See other pages for more additions.			
		Hand Fired (Y/N)	No			No Hot Water Tank				Door Opnrs	
		Space Heat #	0			No Plumbing				Bsmt Stalls	
Condition	NML	Appliances				Sewer & Water Only					
		Range Unit	Built-In Vacuums			Water Only w/Sink					
Basement	Full	Oven - Single	Intercom System			Hot Tub					
No Bsmt Flr.	0	Oven - Double	BI Stereo			Bidet					
Heat	FHA - Gas	Dishwasher				Fbgls Service Sink					
AC	Yes	Microwave				Urinal					
Attic	None	Trash Compactor				Sauna					
		Jennair				W'Pool Bath w/Shower					
		Security System				Water Only					
						No Tub/Shower					



Bldg / Addn	Description	Units	Year
1 of 1	101 — Single-Family / Owner Occupied		
	2 Story Frame	912	
#1	Bsmt Fin - Living Qtrs. (Multi) (Avg)	300 Tbl	
#2	Bsmt Fin - Wall Fin./Interior of Exterior Wall	100 Tbl	
	Base Heat: FHA - Gas		
	Add Central Air	912	
#1	Porch: 1S Frame Open	128 SF	
	Deck #1: Wood Deck-Med	288 SF	
	Veneer #1 1 Story Brick	35.0 LF	
	Veneer #2 1/2 Story Brick	25.0 LF	
	Plumbing	4	
#1	Fireplace: Gas/Elec-Side, 1 Story	1	
	Garage: Att Frame	1,049 SF	1996
1 of 2	Adtn 1 Story Frame	22 SF	1996
2 of 2	Adtn 1 Story Frame	168 SF	1996

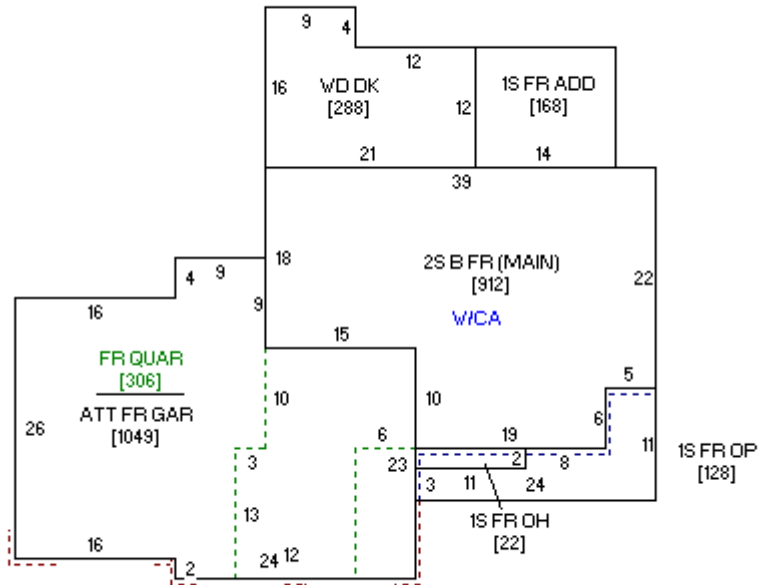

25 LF 1/2S BRK
 35 LF 1S BRK

Sketch 1 of 1



Photo 1 of 2 08/18/2008



Photo 2 of 2 03/09/2006