

LEGAL DESCRIPTION:	CLASS:	-----	CSR'S	.00	CODE	VALUE ACRES
30-91-37	R RESIDENTIAL	GROSS	CURRENT			
ALTA WASH LC AREA SSD		ROADS	LAND	37,450		
AUD S/D SW FR 1/4		D.D.	BLDG			
LOT 11		R.R.	DWLG	192,590(1)		
		MISC				
			TOTAL	230,040		
		NET				

-----		YEAR	2013	
		LAND	37,450	
		BLDG		
		DWLG	192,590(1)	
		TOTAL	230,040	
		NET TX		

DEED HOLDER:	DATE REFER	CONTRACT HOLDER:	DATE REFER	YEAR	2012
SCHEER GABRIEL J	08092013 3			LAND	37,450
SCHEER KARI A F				BLDG	
11 ST ANDREWS DR				DWLG	192,590(1)
STORM LAKE IA 50588				TOTAL	230,040
				NET TX	

-----	YEAR	2011	
SITZMANN JAY	07282003 2	LAND	37,450
SITZMANN CHRISTINE		BLDG	
11 ST ANDREWS DR		DWLG	192,590(1)
STORM LAKE IA 50588		TOTAL	230,040

BEUKELMAN ROY A	1	NET TX	
-----------------	---	--------	--

-----	YEAR	2010	
787 550TH ST		LAND	37,450
STORM LAKE IA		BLDG	
		DWLG	192,590(1)
		TOTAL	230,040
		NET TX	

-----	YEAR	2009	
REMARKS:		LAND	37,450
1 59/404 06-26-91 \$66,100 (D022)		BLDG	
2 W.D. #033346 07-17-03 \$160,500 (D000)		DWLG	192,590(1)
3 W.D. #132108 07-11-13 \$247,000		TOTAL	230,040
		NET TX	

-----	YEAR	2008	
		LAND	39,720
		BLDG	
		DWLG	152,810(1)
		TOTAL	192,530
		NET TX	

11 ST ANDREWS DR, STORM LAKE

Deed: SCHEER GABRIEL J, SCHEER KARI A F

Map Area: WASH-RES(LAKE CREEK)

Checks/Tags:

Contract:

Route: 910-003-780

Lister/Date: LF, 08/12/2008

CID#: 0978600

Tax Dist: ALTA WASH LC AREA SSD

Review/Date: DS, 12/09/2008

DBA:

Plat Page: -

Entry Status: Inspected

MLS: 15749

Subdiv: [NONE]

RURAL/RESIDENTIAL

Legal: 30-91-37 ALTA WASH LC AREA SSD AUD S/D SW FR 1/4 LOT 11

Land										
Land Basis	Front	Rear	Side 1	Side 2	R. Lot	SF	Acres			
FF Main	100.00	100.00	165.00	165.00	0.00					
Sub Total						16,500.00	0.379			
Grand Total						16,500.00	0.379			

Sales				Building Permits				Values			
Date	\$ Amount	NUTC	Recording	Date	Number	Tag	\$ Amount	Reason			
07/11/2013	\$247,000	D0	132108	4/15/2008	04-15-08-004	N	\$0	Addition			
07/17/2003	\$160,500	D0	#033346								
05/01/1989	\$66,100	C23									
06/28/1985	\$67,500	C0									

Res. Structure		Finish				Plumbing		Addition		Garage	
Occ. Code	101	Ttl Rooms Above #	8	Bedrooms Above #	3	Full Bath	2	Addition	1 of 2	Garage	1 of 1
Occ. Descr.	Single-Family / Owner Occupied	Ttl Rooms Below #	2	Bedrooms Below #	0	Shower Stall Bath		Year Built	2004	Style	Att Frm
Year Built	1972	Bsmt Fin Area #1	375	Table		Toilet Room	1	EFA	5	W X L	0' X 0'
EFA / EFYr	37 / 1972	Bsmt Fin Area #2				Lavatory		EFA Year	2004	Area (SF)	672
Arch. Dsgn	N/A	Bsmt Fin Area #3				Water Closet		Style	1 Sty Frm	Year Built	1972
Style	1 Story Frame	Foundation	C Blk			Sink		Area (SF)	288	EFA	37
AreaSF/TLA	1,768 / 2,350	Exterior Walls	Vinyl			Shower Stall/Tub		Condition	Normal	EFF Year	1972
GLA 1st/2nd	2,350 / 0	Roof	Asph / Gable			Mtl St Sh Bath				Condition	A NML
Condition	A NML	Interior Finish	Drwl			Mtl Stall Shower		Bsmt (SF)			
Basement	1/2	Flooring	Carp / Ceramic			No Bathroom		NoBsmt Flr(SF)		Bsmt (SF)	
No Bsmt Flr.	0	Non-base Heating		Fireplace		Wet Bar		Heat	FHA - Gas	Qtrs Over	None
Heat	FHA - Gas	Floor/Wall #	0	Prefab, 1 Sty	1	Whirlpool Bathroom		AC	Yes	Qtrs Over (SF)	
AC	Yes	Pipeless #	0			Whirlpool Tub		Attic (SF)		Qtrs AC (SF)	
Attic	None	Hand Fired (Y/N)	No			No Hot Water Tank		See other pages for more additions.			
		Space Heat #	0			No Plumbing				Door Opnrs	1
		Appliances				Sewer & Water Only				Bsmt Stalls	
		Range Unit	Built-In Vacuums			Water Only w/Sink					
		Oven - Single	Intercom System			Hot Tub					
		Oven - Double	Bl Stereo			Bidet					
		Dishwasher				FbglS Service Sink					
		Microwave				Urinal					
		Trash Compactor				Sauna					
		Jennair				W'Pool Bath w/Shower					
		Security System				Water Only					
						No Tub/Shower					



Bldg / Addn 1 of 1	Description	Units	Year
	101 — Single-Family / Owner Occupied		
	1 Story Frame	1,768	
	Adjustment for basement - 1/2		
#1	Bsmt Fin - Living Qtrs. (Multi) (Low)	375 Tbl	
	Base Heat: FHA - Gas		
	Add Central Air	1,768	
#1	Porch: 1S Frame Open	8 SF	
	Deck #1: Concrete Patio-Med	201 SF	
	Veneer #1 1/2 Story Brick	52.0 LF	
	Veneer #2 1 Story Brick	16.0 LF	
	Plumbing	3	
#1	Fireplace: Prefab, 1 Story	1	
	Garage: Att Frame	672 SF	1972
1 of 2	Adtn 1 Story Frame	288 SF	2004
2 of 2	Adtn 1 Story Frame	294 SF	2008

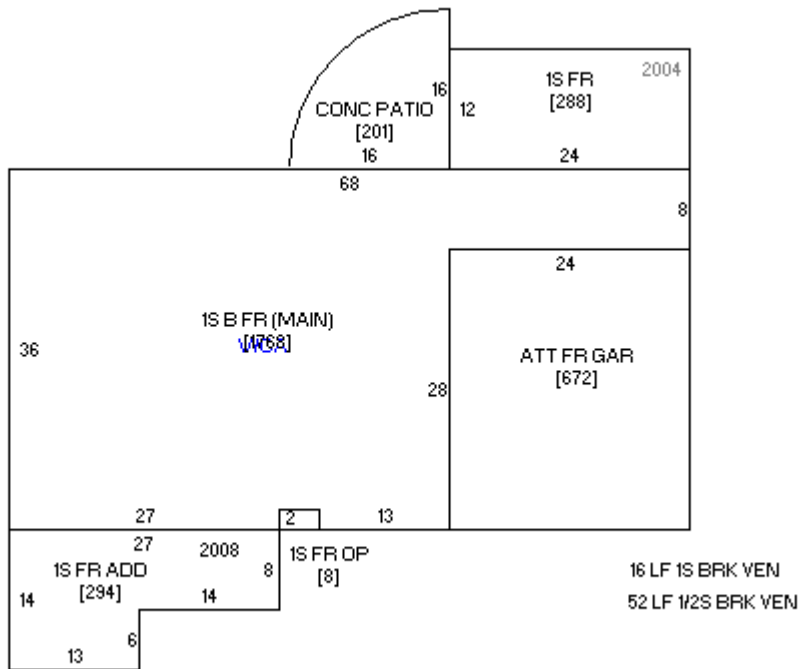

Sketch 1 of 1



Photo 1 of 2 08/18/2008



Photo 2 of 2 04/01/2003