

LEGAL DESCRIPTION: CLASS:

30-91-37 R RESIDENTIAL
ALTA WASH LC AREA SSD
ST. ANDREWS COURT
APT. #6

-----		CSR'S	.00	-----	
				CODE	VALUE ACRES
GROSS	CURRENT				
ROADS	LAND	20,620			
D.D.	BLDG				
R.R.	DWLG	110,090(1)			
MISC					
	TOTAL	130,710			
NET					

=====		=====	=====	=====	
	YEAR	2013			
	LAND	20,620			
	BLDG				
	DWLG	110,090(1)			
	TOTAL	130,710			
	NET TX				

DEED HOLDER: DATE REFER | CONTRACT HOLDER: DATE REFER

STARK JEFFORY B 06202013 3 |

6 ST ANDREWS CT |

ALTA IA 51002 |

-----		YEAR	2012	-----	
		LAND	20,620		
		BLDG			
		DWLG	110,090(1)		
		TOTAL	130,710		
		NET TX			

ZYLSTRA LAYTON 05062009 2 |

ZYLSTRA REBECCA M |

2329 SUNCREST DR |

AMES IA 50014 |

-----		YEAR	2011	-----	
		LAND	20,620		
		BLDG			
		DWLG	110,090(1)		
		TOTAL	130,710		
		NET TX			

MC KENNA J ORTON 1 |

MC KENNA LEATRICE J |

6 ST ANDREWS CT |

ALTA IA 51002 |

-----		YEAR	2010	-----	
		LAND	20,620		
		BLDG			
		DWLG	110,090(1)		
		TOTAL	130,710		
		NET TX			

REMARKS:

1 W.D. 53/449 05-07-84 \$71,500

2 W.D. #090643 02-25-09 \$120,000(D000)

3 W.D. #131638 05-30-13 \$162,500

-----		YEAR	2009	-----	
		LAND	20,620		
		BLDG			
		DWLG	110,090(1)		
		TOTAL	130,710		
		NET TX			

-----		YEAR	2008	-----	
		LAND	22,210		
		BLDG			
		DWLG	127,160(1)		
		TOTAL	149,370		
		NET TX			

6 ST ANDREWS CT, ALTA

Deed: STARK JEFFORY B

Map Area: WASH-RES(LAKE CREEK)

Checks/Tags:

Contract:

Route: 910-003-460

Lister/Date: LF, 08/11/2008

CID#: 0980460

Tax Dist: ALTA WASH LC AREA SSD

Review/Date: DS, 12/09/2008

DBA:

Plat Page: -

Entry Status: Inspected

MLS:

Subdiv: [NONE]

RURAL/RESIDENTIAL

Legal: 30-91-37 ALTA WASH LC AREA SSD ST. ANDREWS COURT APT. #6

Land										
Land Basis	Front	Rear	Side 1	Side 2	R. Lot	SF	Acres			
SqFt X Rate						8,247.00	0.189			
Grand Total						8,247.00	0.189			

Sales				Building Permits				Values			
Date	\$ Amount	NUTC	Recording	Date	Number	Tag	\$ Amount	Reason			
05/30/2013	\$162,500	D0	131638								
02/25/2009	\$120,000	D0	090643								
05/07/1984	\$71,500	D0									

Res. Structure 1 of 1		Finish				Plumbing		Addition		Garage	
Occ. Code	113	Ttl Rooms Above #	4	Bedrooms Above #	2	Full Bath	1	Addition	No Additions	Garage	1 of 1
Occ. Descr.	Condominium	Ttl Rooms Below #	0	Bedrooms Below #	0	Shower Stall Bath	1	Year Built		Style	Att Brick
Year Built	1983	Bsmt Fin Area #1				Toilet Room		EFA		W X L	0' X 0'
EFA / EFYr	26 / 1983	Bsmt Fin Area #2				Lavatory		EFA Year		Area (SF)	400
Arch. Dsgn	N/A	Bsmt Fin Area #3				Water Closet		Style		Year Built	1983
Style	1 Story Brick	Foundation	POURED CONCRETE			Sink		Area (SF)		EFA	26
AreaSF/TLA	1,400 / 1,400	Exterior Walls	BRICK VENNER			Shower Stall/Tub		Condition		EFF Year	1983
GLA 1st/2nd	1,400 / 0	Roof	Asph / Gable			Mtl St Sh Bath					
Condition	NML	Interior Finish	Drwl			Mtl Stall Shower		Bsmt (SF)		Condition	NML
Basement	None	Flooring	Carp / Ceramic			No Bathroom		NoBsmt Flr(SF)		Bsmt (SF)	
No Bsmt Flr.	0	Non-base Heating		Fireplace		Wet Bar		Heat		Qtrs Over	None
Heat	FHA - Gas	Floor/Wall #	0	Masonry, 1 Sty	1	Whirlpool Bathroom		AC		Qtrs Over (SF)	
AC	Yes	Pipeless #	0			Whirlpool Tub		Attic (SF)		Qtrs AC (SF)	
Attic	None	Hand Fired (Y/N)	No			No Hot Water Tank				Door Opnrs	1
		Space Heat #	0			No Plumbing				Bsmt Stalls	
		Appliances				Sewer & Water Only					
		Range Unit	Built-In Vacuums			Water Only w/Sink					
		Oven - Single	Intercom System			Hot Tub					
		Oven - Double	BI Stereo			Bidet					
		Dishwasher				FbglS Service Sink					
		Microwave				Urinal					
		Trash Compactor				Sauna					
		Jennair				W'Pool Bath w/Shower					
		Security System				Water Only					
						No Tub/Shower					



Bldg / Addn 1 of 1	Description	Units	Year
	113 — Condominium		
	1 Story Brick	1,400	
	Adjustment for basement - None		
	Base Heat: FHA - Gas		
	Add Central Air	1,400	
	Deck #1: Concrete Patio-Med	250 SF	
	Plumbing	2	
#1	Fireplace: Masonry, 1 Story	1	
	Garage: Att Brick	400 SF	1983

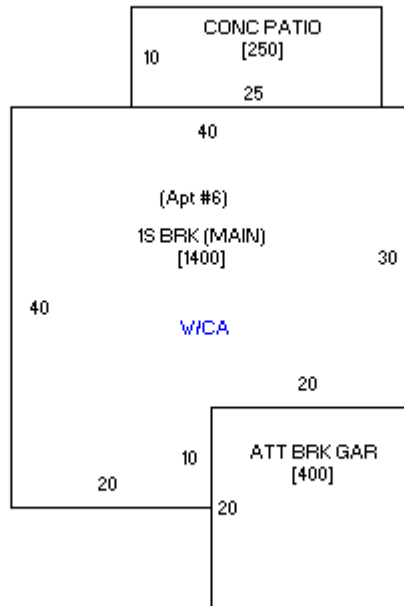

Sketch 1 of 1



Photo 1 of 2 08/18/2008



Photo 2 of 2 05/01/1998