

Pin: 14-21-300-001
Sale Date: 10/01/14
Sale Price: \$250,000
Acres: 5.08 Net
Classification: Rural Residential

3

6

14-21-300-001

R-Res

#9322.50

5

LEGAL DESCRIPTION:

CLASS:

21-90-37
STORM LAKE HAYES
PT NW SW
(478' X 505')

R RESIDENTIAL

-----		CSR'S	.00		
				CODE	VALUE ACRES
GROSS	5.54	CURRENT			
ROADS	.46	LAND	45,000		
D.D.		BLDG			
R.R.		DWLG	149,060(1)		
MISC					
		TOTAL	194,060		
NET	5.08				
-----		-----		-----	

YEAR		2014			
LAND		45,000	ROAD	.46	
BLDG					
DWLG		149,060(1)			
TOTAL		194,060			
NET TX					

DEED HOLDER:		DATE REFER	CONTRACT HOLDER:	DATE REFER	YEAR	2013		
BAUMHOVER BRYAN G		12012014 3			LAND	45,000	ROAD	.46
BAUMHOVER LEANN M					BLDG			
6362 90TH AVE					DWLG	149,060(1)		
STORM LAKE IA 50588					TOTAL	194,060		
					NET TX			

PLOEGER DAVID N		12201995 2			YEAR	2012		
PLOEGER JUDITH L					LAND	45,000	ROAD	.46
6362 90TH AVE					BLDG			
STORM LAKE IA 50588					DWLG	149,060(1)		
					TOTAL	194,060		
					NET TX			

SCHAEFER FERN MARIE					YEAR	2011		
BOX 312					LAND	45,000	ROAD	.46
SCHALLER IA					BLDG			
					DWLG	149,060(1)		
					TOTAL	194,060		
					NET TX			

REMARKS:					YEAR	2010		
2 WD 61/108 11-16-95 \$38,000 (D026)					LAND	45,000	ROAD	.46
3 W.D. #142509 10-01-14 \$250,000					BLDG			
					DWLG	149,060(1)		
					TOTAL	194,060		
					NET TX			

YEAR		2009			
LAND		45,000	ROAD	.46	
BLDG					
DWLG		149,060(1)			
TOTAL		194,060			
NET TX					

Deed: BAUMHOVER BRYAN G,BAUMHOVER LEANN M
 Contract:
 CID#: 0932250
 DBA:
 MLS:

Map Area: HAYES-RES
 Route: 915-004-310
 Tax Dist: SL HAYES
 Plat Page: -
 Subdiv: [NONE]

Checks/Tags: S
 Lister/Date: LF, 07/10/2008
 Review/Date: TG, 12/03/2008
 Entry Status: Inspected

RURAL/RESIDENTIAL

Legal: 21-90-37 STORM LAKE HAYES PT NW SW (478' X 505')

Land									
Land Basis	Front	Rear	Side 1	Side 2	R. Lot	SF	Acres		
Site-Excess							1.000		
Excess 1							4.080		
Sub Total						221,284.80	5.080		
Grand Total						221,284.80	5.080		

Sales				Building Permits				Values			
Date	\$ Amount	NUTC	Recording	Date	Number	Tag	\$ Amount	Reason			
10/01/2014	\$250,000	D0	142509	6/20/1997		N	\$100,000	New Dwlg			
11/16/1995	\$38,000	D26	061-108								

Res. Structure		1 of 1		Finish				Plumbing				Addition		Garage	
Occ. Code	101	Ttl Rooms Above #	7	Bedrooms Above #	3	Full Bath	1	Addition	No Additions	Garage	1 of 1				
Occ. Descr.	Single-Family / Owner Occupied	Ttl Rooms Below #	0	Bedrooms Below #	0	Shower Stall Bath	1	Year Built		Style	Att Frm				
Year Built	1997	Bsmt Fin Area #1				Toilet Room		EFA		W X L	0' X 0'				
EFA / EFYr	12 / 1997	Bsmt Fin Area #2				Lavatory		EFA Year		Area (SF)	884				
Arch. Dsgn	N/A	Bsmt Fin Area #3				Water Closet	1	Style		Year Built	1997				
Style	1 Story Frame	Foundation	POURED CONCRETE			Sink		Area (SF)		EFA	12				
AreaSF/TLA	1,704 / 1,704	Exterior Walls	Vinyl			Shower Stall/Tub		Condition		EFF Year	1997				
GLA 1st/2nd	1,704 / 0	Roof	Asph / Gable			Mtl St Sh Bath				Condition	NML				
		Interior Finish	Drwl			Mtl Stall Shower	1	Bsmt (SF)		Bsmt (SF)					
		Flooring	Carp / Hdwd			No Bathroom		NoBsmt Flr(SF)		Qtrs Over	None				
		Non-base Heating		Fireplace		Wet Bar		Heat		Qtrs Over (SF)					
		Floor/Wall #	0	Prefab, 1 Sty	1	Whirlpool Bathroom		AC		Qtrs AC (SF)					
		Pipeless #	0			Whirlpool Tub		Attic (SF)							
		Hand Fired (Y/N)	No			No Hot Water Tank									
Condition	NML	Space Heat #	0			No Plumbing				Door Opnrs					
		Appliances				Sewer & Water Only				Bsmt Stalls					
Basement	Full	Range Unit	Built-In Vacuums			Water Only w/Sink									
No Bsmt Flr.	0	Oven - Single	Intercom System			Hot Tub									
Heat	FHA - Gas	Oven - Double	BI Stereo			Bidet									
AC	Yes	Dishwasher				Fbgl Service Sink	1								
Attic	None	Microwave				Urinal									
		Trash Compactor				Sauna									
		Jennair				W'Pool Bath w/Shower									
		Security System				Water Only									
						No Tub/Shower									



Bldg / Addn 1 of 1	Description	Units	Year					
	101 — Single-Family / Owner Occupied							
	1 Story Frame	1,704						
	Base Heat: FHA - Gas							
	Add Central Air	1,704						
#1	Porch: 1S Frame Open	194 SF						
	Plumbing	5						
#1	Fireplace: Prefab, 1 Story	1						
	Garage: Att Frame	884 SF	1997					

	Count	Ag Building Description	Units	Year					
1 of 3 P:3	1	FR @ .40 913-Barn - Pole	40' X 56' 2,240 SF	1900					
2 of 3 P:5	1	OP FR @ .40 927-Shed	16' X 30' 480 SF	1900					
3 of 3 P:6	1	MTL/P 925-Steel Utility Bldg	32' X 40' 1,280 SF	2005					

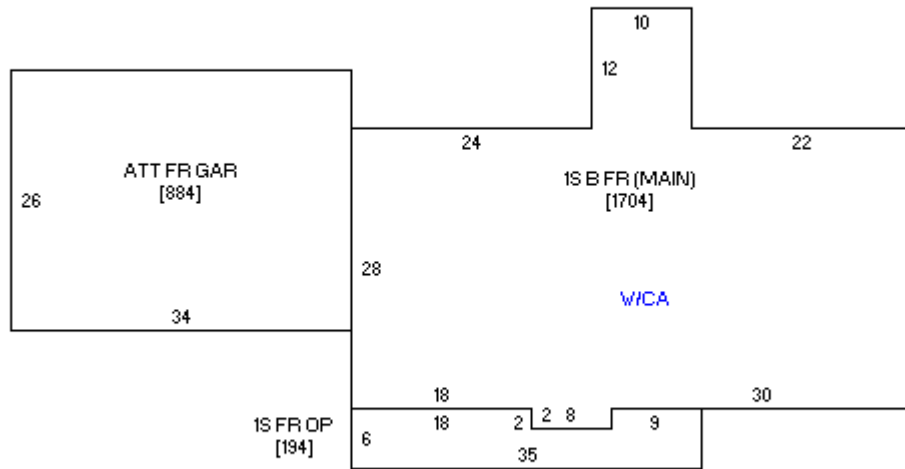

Sketch 1 of 1



Photo 1 of 2 07/25/2008



Photo 2 of 2 12/12/1997