

13-08-100-006

#10620.00

AG

W
T

13-08-100-007

#10620.50

R-Res

Pin: 13-08-100-007
Sale Date: 06/24/14
Sale Price: \$150,000
Net Acres: 2.96
Classification: Split - Change in use from
Ag to Rural Residential

Bldgs Not Listed

9

8

10

7

13

12

11

6

5

4

1

2

3

LEGAL DESCRIPTION:

CLASS:

08-90-38
ALTA MAPLE VALLEY
LOT B IN N 1/2 NW

A AGRICULTURE

		CSR'S	205.64		
				CODE	VALUE ACRES
GROSS	3.44	CURRENT			
ROADS	.48	LAND	6,680		
D.D.		BLDG	4,460(11)		
R.R.		DWLG	98,660(1)		
MISC					
		TOTAL	109,800		
NET	2.96				

		YEAR	2014 REFER: 1		
		LAND	6,680		
		BLDG	4,460(11)		
		DWLG	98,660(1)		
		TOTAL	109,800		
		NET TX			

DEED HOLDER:

DATE REFER

CONTRACT HOLDER:

DATE REFER

YEAR

BRADKE DARIN
BRADKE ELIZABETH
130 N SPRUCE ST
WACONIA MN 55387

08272014 3

LAND
BLDG
DWLG
TOTAL
NET TX

MONEYPENNY LOREEN

2980 HWY 22 S
MICHIE TN 38357

YEAR
LAND
BLDG
DWLG
TOTAL
NET TX

REMARKS:

1 !2014)SPLIT FROM 001 & 002 (08/27/14)
3 WDJT #141839 06/24/14 \$150,000

YEAR
LAND
BLDG
DWLG
TOTAL
NET TX

YEAR
LAND
BLDG
DWLG
TOTAL
NET TX

Res. Structure		Finish				Plumbing		Addition		Garage	
Occ. Code	101	Ttl Rooms Above #	7	Bedrooms Above #	3	Full Bath	1	Addition	No Additions	Garage	1 of 1
Occ. Descr.	Single-Family / Owner Occupied	Ttl Rooms Below #	0	Bedrooms Below #	0	Shower Stall Bath	1	Year Built		Style	Att Frm
Year Built	1972	Bsmt Fin Area #1				Toilet Room		EFA		W X L	0' X 0'
EFA / EFYr	37 / 1972	Bsmt Fin Area #2				Lavatory		EFA Year		Area (SF)	576
Arch. Dsgn	N/A	Bsmt Fin Area #3				Water Closet		Style		Year Built	1972
Style	1 Story Frame	Foundation	C Blk			Sink	1	Area (SF)		EFA	37
AreaSF/TLA	2,016 / 2,016	Exterior Walls	Composite			Shower Stall/Tub		Condition		EFF Year	1972
GLA 1st/2nd	2,016 / 0	Roof	Asph / Hip			Mtl St Sh Bath				Condition	Poor
Condition	Poor	Interior Finish	Drwl			Mtl Stall Shower		Bsmt (SF)		Bsmt (SF)	
Basement	Full	Flooring	Carp / Vinyl			No Bathroom		NoBsmt Flr(SF)		Qtrs Over	None
No Bsmt Flr.	0	Non-base Heating		Fireplace		Wet Bar		Heat		Qtrs Over (SF)	
Heat	FHA - Gas	Floor/Wall #	0			Whirlpool Bathroom		AC		Qtrs AC (SF)	
AC	Yes	Pipeless #	0			Whirlpool Tub		Attic (SF)		Door Opnrs	2
Attic	None	Hand Fired (Y/N)	No			No Hot Water Tank				Bsmt Stalls	
		Space Heat #	0			No Plumbing					
						Sewer & Water Only					
		Appliances				Water Only w/Sink					
		Range Unit	Built-In Vacuums			Hot Tub					
		Oven - Single	Intercom System			Bidet					
		Oven - Double	Bl Stereo			FbglS Service Sink					
		Dishwasher				Urinal					
		Microwave				Sauna					
		Trash Compactor				W'Pool Bath w/Shower					
		Jennair				Water Only					
		Security System				No Tub/Shower					



Bldg / Addn 1 of 1	Description	Units		Year				
	101 — Single-Family / Owner Occupied							
	1 Story Frame	2,016						
	Base Heat: FHA - Gas							
	Add Central Air	2,016						
	Veneer #1 1/2 Story Brick	76.0 LF						
	Plumbing	3						
	Garage: Att Frame	576 SF		1972				

	Count	Ag Building Description		Units		Year					
1 of 11 P:1	1	MTL POLE 925-Steel Utility Bldg	28' X 31'	868 SF		1978					
2 of 11 P:2	1	MACH FR @ .40 927-Shed	28' X 60'	1,680 SF		1900					
3 of 11 P:3	1	HOG HSE FR @ .40 927-Shed	16' X 24'	384 SF		1900					
4 of 11 P:4	1	GRANARY FR @ .40 927-Shed	10' X 20'	200 SF		1900					
5 of 11 P:5	1	FEED FR @ .90 907-Barn - Feed and Livestock	52' X 56'	2,912 SF		1900					
6 of 11 P:6	1	TILE @ .90 910-Milk House	24' X 30'	720 SF		1900					
7 of 11 P:7	1	HOG HSE FR @ .90 927-Shed	26' X 48'	1,248 SF		1900					
8 of 11 P:10	1	WIRE @ SV 934-Bin - Wire Grain Storage	16' X 12'	1,939 Bu		1900					
9 of 11 P:11	1	ELEV. OHB FR @ .90 926-Crib	29' X 32'	928 SF		1900					
10 of 11 P:12	1	HEN HSE FR @ .40 927-Shed	20' X 40'	800 SF		1900					
11 of 11 P:13	1	STG FR @ .40 927-Shed	8' X 12'	96 SF		1900					

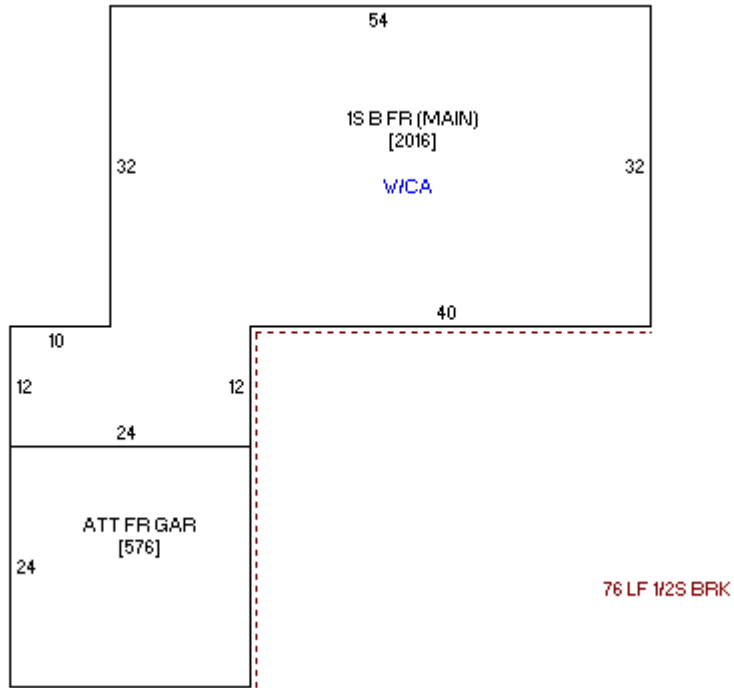

Sketch 1 of 1

