

16-08-200-012

#7245.75

R-Res

Pin: 16-08-200-012
Sale Date: 06/30/14
Sale Price: \$190,000 - RE
Classification: Rural Residential
Acres: 1.65 Net



LEGAL DESCRIPTION:

CLASS:

08-90-35
NEWELL PROV. NEWELL
PT LOT 1 SE NE
(240' X 294') &
LOT A SE NE

R RESIDENTIAL

-----		CSR'S	.00		
				CODE	VALUE ACRES
GROSS	1.98	CURRENT			
ROADS	.33	LAND	23,050		
D.D.		BLDG			
R.R.		DWLG	185,460(1)		
MISC					
		TOTAL	208,510		
NET	1.65				

=====		=====		=====	
		YEAR	2014		
		LAND	23,050	ROAD	.33
		BLDG			
		DWLG	185,460(1)		
		TOTAL	208,510		
		NET TX			

-----		-----		-----		-----	
DEED HOLDER:	DATE REFER	CONTRACT HOLDER:	DATE REFER	YEAR	2013		
DILWORTH SANDRA N	08072014 2			LAND	23,050	ROAD	.33
BALLOU CASSANDRA LENEA				BLDG			
6135 210TH AVE				DWLG	185,460(1)		
NEWELL IA 50568				TOTAL	208,510		
				NET TX			

-----		-----		-----		-----	
				YEAR	2012		
				LAND	23,050	ROAD	.33
				BLDG			
				DWLG	185,460(1)		
				TOTAL	208,510		
				NET TX			

-----		-----		-----		-----	
				YEAR	2011		
				LAND	23,050	ROAD	.33
				BLDG			
				DWLG	185,460(1)		
				TOTAL	208,510		
				NET TX			

-----		-----		-----		-----	
				YEAR	2010		
				LAND	23,050	ROAD	.33
				BLDG			
				DWLG	185,460(1)		
				TOTAL	208,510		
				NET TX			

-----		-----		-----		-----	
				YEAR	2009		
				LAND	23,050	ROAD	.33
				BLDG			
				DWLG	185,460(1)		
				TOTAL	208,510		
				NET TX			

REMARKS:
2 #141677 06-30-14 RE=190,000 PP=3,000

Res. Structure		Finish				Plumbing		Addition		Garage	
1 of 1											
Occ. Code	101	Ttl Rooms Above #	6	Bedrooms Above #	2	Full Bath	1	Addition	No Additions	Garage	1 of 2
Occ. Descr.	Single-Family / Owner Occupied	Ttl Rooms Below #	0	Bedrooms Below #	0	Shower Stall Bath	1	Year Built		Style	Att Frm
Year Built	1981	Bsmt Fin Area #1				Toilet Room	1	EFA		W X L	0' X 0'
EFA / EFYr	28 / 1981	Bsmt Fin Area #2				Lavatory	1	EFA Year		Area (SF)	768
Arch. Dsgn	N/A	Bsmt Fin Area #3				Water Closet		Style		Year Built	1981
Style	1 Story Frame	Foundation	Conc			Sink		Area (SF)		EFA	28
AreaSF/TLA	2,752 / 2,752	Exterior Walls	Composite			Shower Stall/Tub		Condition		EFF Year	1981
GLA 1st/2nd	2,752 / 0	Roof	Wd / Gable			Mtl St Sh Bath		Bsmt (SF)		Condition	NML
Condition	NML	Interior Finish	Drwl			Mtl Stall Shower		NoBsmt Flr(SF)		Bsmt (SF)	
Basement	None	Flooring	Carp / Vinyl			No Bathroom		Heat		Qtrs Over	None
No Bsmt Flr.	0	Non-base Heating		Fireplace		Wet Bar		AC		Qtrs Over (SF)	
Heat	FHA - Gas	Floor/Wall #	0	Gas-Vertical, 1 Sty	1	Whirlpool Bathroom		Attic (SF)		Qtrs AC (SF)	
AC	Yes	Pipeless #	0			Whirlpool Tub				Door Opnrs	
Attic	None	Hand Fired (Y/N)	No			No Hot Water Tank				Bsmt Stalls	
		Space Heat #	0			No Plumbing					
		Appliances				Sewer & Water Only					
		Range Unit	Built-In Vacuums			Water Only w/Sink					
		Oven - Single	Intercom System			Hot Tub					
		Oven - Double	BI Stereo			Bidet					
		Dishwasher				FbglS Service Sink					
		Microwave				Urinal					
		Trash Compactor				Sauna					
		Jennair				W'Pool Bath w/Shower					
		Security System				Water Only					
						No Tub/Shower					



Bldg / Addn 1 of 1	Description	Units	Year
	101 — Single-Family / Owner Occupied		
	1 Story Frame	2,752	
	Adjustment for basement - None		
	Base Heat: FHA - Gas		
	Add Central Air	2,752	
#1	Porch: 1S Frame Open	395 SF	
	Deck #1: Asph/Wd Roof OH-Med	135 SF	
	Deck #2: Wood Deck-Low	120 SF	
	Deck #3: Concrete Patio-Med	264 SF	
	Veneer #1 1/2 Story Brick	292.0 LF	
	Plumbing	4	
#1	Fireplace: Gas-Vertical, 1 Story	1	
	Garage: Att Frame	768 SF	1981
	Garage: Det Metal 0' X 0'	1,200 SF	1989

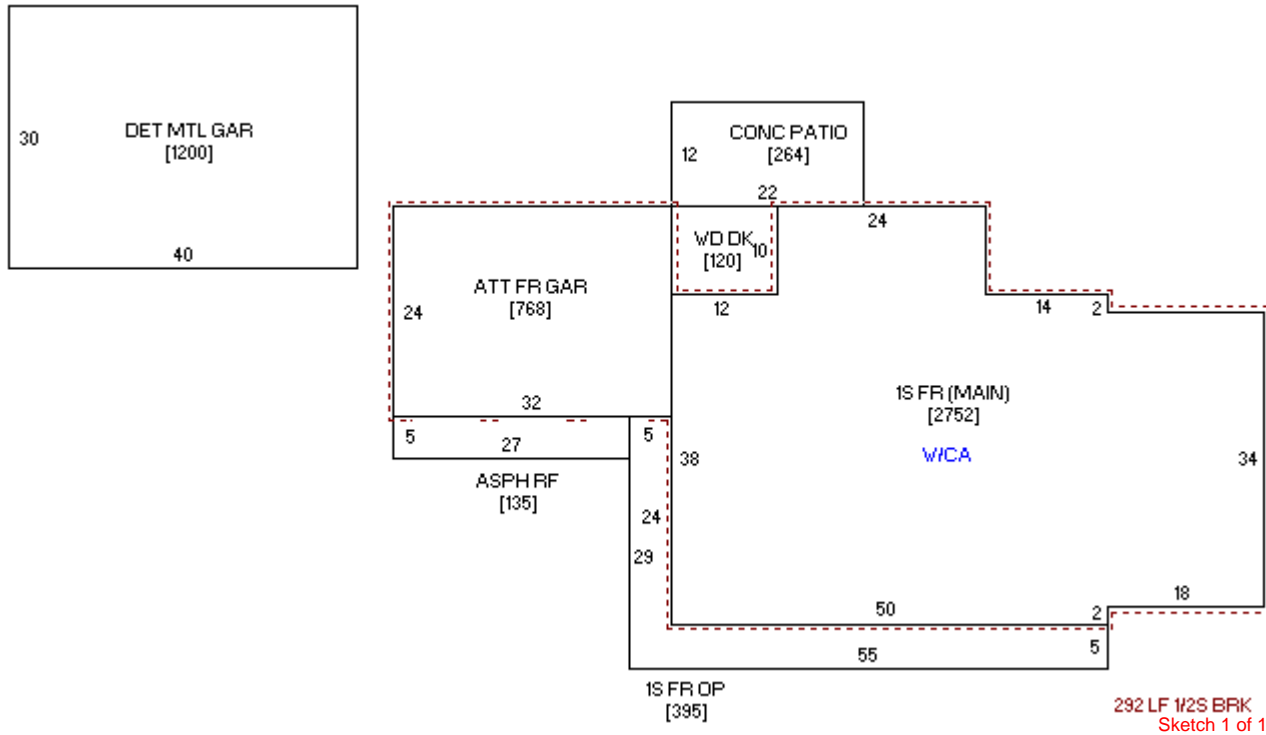



Photo 1 of 1 09/09/2008