

Pin: 06-08-300-006
Sale Date: 10/31/14
Sale Price: \$36,600
Acres: 4.88 Net
Classification: Rural Residential

06-08-300-006

10029.95

R-Res



LEGAL DESCRIPTION:	CLASS:	-----	CSR'S	.00	-----	CODE	VALUE	ACRES
08-92-37	R RESIDENTIAL		GROSS	5.15	CURRENT			
ALTA SCOTT			ROADS	.27	LAND	11,000		
PT SW SW			D.D.		BLDG			
(335.15' X 635')			R.R.		DWLG	12,070(1)		
			MISC					
					TOTAL	23,070		
			NET	4.88				

-----		=====		=====		=====	
		YEAR	2014				
		LAND	11,000	ROAD			.27
		BLDG					
		DWLG	12,070(1)				
		TOTAL	23,070				
		NET TX					

DEED HOLDER:	DATE REFER	CONTRACT HOLDER:	DATE REFER	YEAR	2013	-----	-----
WEILAND CORY D	12192014 5			LAND	11,000	ROAD	.27
WEILAND MELINDA L				BLDG			
5326 100TH AVE				DWLG	12,070(1)		
STORM LAKE IA 50588				TOTAL	23,070		
				NET TX			

-----	-----	-----	-----	YEAR	2012	-----	-----
WEST KEITH D	12302003 4			LAND	11,000	ROAD	.27
823 500TH ST				BLDG			
ALTA IA 51002				DWLG	12,070(1)		
				TOTAL	23,070		
				NET TX			

-----	-----	-----	-----	YEAR	2011	-----	-----
WEST KEITH D	03021995 3			LAND	11,000	ROAD	.27
WEST TWYLA				BLDG			
831 500TH ST				DWLG	12,070(1)		
ALTA IA				TOTAL	23,070		
				NET TX			

-----	-----	-----	-----	YEAR	2010	-----	-----
ANDERSON BARBARA	1			LAND	11,000	ROAD	.27
7011 HWY C29				BLDG			
ALTA IA				DWLG	12,070(1)		
				TOTAL	23,070		
				NET TX			

REMARKS:	-----	YEAR	2009	-----	-----
1 W.D. 58/633 08-06-92 (D022)		LAND	11,000	ROAD	.27
3 W.D. 60/694 02-24-95 \$32,000 (D000)		BLDG			
4 DIVORCE DECREE #CDCD002232 12-01-03		DWLG	12,070(1)		
5 W.D. #142855 10-31-14 \$36,600		TOTAL	23,070		
		NET TX			

-----	-----	YEAR	2009	-----	-----
		LAND	11,000	ROAD	.27
		BLDG			
		DWLG	12,070(1)		
		TOTAL	23,070		
		NET TX			

823 500TH ST, ALTA

Deed: WEILAND CORY D,WEILAND MELINDA L

Map Area: SCOTT-RES

Checks/Tags: S

Contract:

Route: 907-001-240

Lister/Date: CL, 10/01/2008

CID#: 1002995

Tax Dist: ALTA SCOTT

Review/Date: DS, 11/03/2008

DBA:

Plat Page:

Entry Status: Estimated

MLS:

Subdiv: [NONE]

RURAL/RESIDENTIAL

Legal:08-92-37 ALTA SCOTT PT SW SW (335.15' X 635')

Land									
Land Basis	Front	Rear	Side 1	Side 2	R. Lot	SF	Acres		
Site-Excess							1.000		
Excess 1							3.880		
Sub Total						212,572.80	4.880		
Grand Total						212,572.80	4.880		

Sales				Building Permits				Values			
Date	\$ Amount	NUTC	Recording	Date	Number	Tag	\$ Amount	Reason			
10/31/2014	\$36,600	D0	142855	1/28/2010	PRIOR YEAR	Y	\$0	Ext-Remodel			
12/01/2003	\$0	D38	#CDCD02232								

Res. Structure		Finish				Plumbing		Addition		Garage	
Occ. Code	101	Ttl Rooms Above #	5	Bedrooms Above #	2	Full Bath	1	Addition	No Additions	Garage	1 of 1
Occ. Descr.	Single-Family / Owner Occupied	Ttl Rooms Below #	0	Bedrooms Below #	0	Shower Stall Bath		Year Built		Style	Det Frm
Year Built	1925	Bsmt Fin Area #1				Toilet Room		EFA		W X L	0' X 0'
EFA / EFYr	84 / 1925	Bsmt Fin Area #2				Lavatory		EFA Year		Area (SF)	240
Arch. Dsgn	N/A	Bsmt Fin Area #3				Water Closet		Style		Year Built	1910
Style	1 Story Frame	Foundation	C Blk			Sink		Area (SF)		EFA	99
AreaSF/TLA	852 / 852	Exterior Walls	Wd Lap			Shower Stall/Tub		Condition		EFF Year	1910
GLA 1st/2nd	852 / 0	Roof	Asph / Gable			Mtl St Sh Bath				Condition	V Poor
Condition	V Poor	Interior Finish	Plas			Mtl Stall Shower		Bsmt (SF)		Bsmt (SF)	
Basement	1/2	Flooring	Carp / Vinyl			No Bathroom		NoBsmt Flr(SF)		Qtrs Over	None
No Bsmt Flr.	0	Non-base Heating		Fireplace		Wet Bar		Heat		Qtrs Over (SF)	
Heat	Yes	Floor/Wall #	0			Whirlpool Bathroom		AC		Qtrs AC (SF)	
AC	No	Pipeless #	0			Whirlpool Tub		Attic (SF)		Door Opnrs	
Attic	None	Hand Fired (Y/N)	No			No Hot Water Tank				Bsmt Stalls	
		Space Heat #	0			No Plumbing					
		Appliances				Sewer & Water Only					
		Range Unit			Built-In Vacuums	Water Only w/Sink					
		Oven - Single			Intercom System	Hot Tub					
		Oven - Double			BI Stereo	Bidet					
		Dishwasher				Fbgl Service Sink					
		Microwave				Urinal					
		Trash Compactor				Sauna					
		Jennair				W'Pool Bath w/Shower					
		Security System				Water Only					
						No Tub/Shower					



Bldg / Addn 1 of 1	Description	Units		Year				
	101 — Single-Family / Owner Occupied							
	1 Story Frame	852						
	Adjustment for basement - 1/2							
	Base Heat							
#1	Porch: 1S Frame Enclosed	28 SF						
	Garage: Det Frame	0' X 0' 240 SF		1910				

	Count	Ag Building Description	Units	Year
1 of 2 P:1	1	HEN HSE FR @ .20 927-Shed	14' X 56' 784 SF	1900
2 of 2 P:2	1	MACH SHED FR @ .20 908-Lean-To	20' X 48' 960 SF	1900

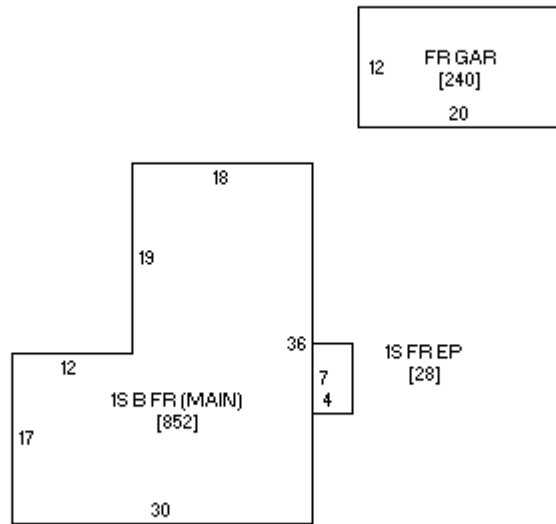

Sketch 1 of 1

