

LEGAL DESCRIPTION:

CLASS:

16-91-37 R RESIDENTIAL
STORM LAKE WASHINGTON
PT. SE COR. SE SE SW
(563' X 600')

-----		CSR'S	.00	CODE	VALUE ACRES
GROSS	CURRENT				
ROADS	LAND	28,500			
D.D.	BLDG				
R.R.	DWLG	56,910(1)			
MISC					
	TOTAL	85,410			
NET	7.75				

=====		YEAR	2014		
	LAND	28,500			
	BLDG				
	DWLG	56,910(1)			
	TOTAL	85,410			
	NET TX				

DEED HOLDER:

STANLEY MARK E
STANLEY SANDRA J
1219 570TH ST
STORM LAKE IA 50588

DATE REFER | CONTRACT HOLDER:
01092015 3 |

-----		YEAR	2013		
	LAND	28,500			
	BLDG				
	DWLG	56,910(1)			
	TOTAL	85,410			
	NET TX				

PHILLIPS WILLIAM L LIFE ESTATE
PHILLIPS DOLORES A LIFE ESTATE
PHILLIPS STEVEN D
ETAL

DATE REFER | CONTRACT HOLDER:
05212010 2 |

-----		YEAR	2012		
	LAND	28,500			
	BLDG				
	DWLG	56,910(1)			
	TOTAL	85,410			
	NET TX				

PHILLIPS WILLIAM L
PHILLIPS DOLORES A
937 570TH ST
STORM LAKE IA 50588

DATE REFER | CONTRACT HOLDER:
1 |

-----		YEAR	2011		
	LAND	28,500			
	BLDG				
	DWLG	56,910(1)			
	TOTAL	85,410			
	NET TX				

REMARKS:

1 W.D. 45/522 06-23-71
2 W.D. #100901 04-20-10
3 W.D. #143121-22 12-12-14 \$90,000

-----		YEAR	2010		
	LAND	28,500			
	BLDG				
	DWLG	56,910(1)			
	TOTAL	85,410			
	NET TX				

-----		YEAR	2009		
	LAND	28,500			
	BLDG				
	DWLG	56,910(1)			
	TOTAL	85,410			
	NET TX				

Deed: STANLEY MARK E, STANLEY SANDRA J
 Contract:
 CID#: 0985500
 DBA:
 MLS: 17445

Map Area: WASH-RES
 Route: 910-001-570
 Tax Dist: SL WASHINGTON
 Plat Page: -
 Subdiv: [NONE]

Checks/Tags:
 Lister/Date: LF, 07/29/2008
 Review/Date: DS, 12/04/2008
 Entry Status: Inspected

RURAL/RESIDENTIAL

Legal: 16-91-37 STORM LAKE WASHINGTON PT. SE COR. SE SE SW (563' X 600')

Land									
Land Basis	Front	Rear	Side 1	Side 2	R. Lot	SF	Acres		
Site-Excess							1.000		
Excess 1							6.750		
Sub Total						337,590.00	7.750		
Grand Total						337,590.00	7.750		

Sales				Building Permits				Values			
Date	\$ Amount	NUTC	Recording	Date	Number	Tag	\$ Amount	Reason			
12/12/2014	\$90,000	D0	143122								
04/20/2010	\$0	D17	100901								

Res. Structure		Finish				Plumbing				Addition		Garage	
Occ. Code	101	Ttl Rooms Above #	7	Bedrooms Above #	3	Full Bath		Addition	1 of 2	Garage	No garages		
Occ. Descr.	Single-Family / Owner Occupied	Ttl Rooms Below #	0	Bedrooms Below #	0	Shower Stall Bath	1	Year Built	1910	Style			
Year Built	1910	Bsmt Fin Area #1				Toilet Room	1	EFA	99	W X L			
EFA / EFYr	99 / 1910	Bsmt Fin Area #2				Lavatory		EFA Year	1910	Area (SF)			
Arch. Dsgn	N/A	Bsmt Fin Area #3				Water Closet		Style	1 Sty Frm	Year Built			
Style	2 Story Frame	Foundation	C Blk			Sink		Area (SF)	96	EFA			
AreaSF/TLA	640 / 1,606	Exterior Walls	Vinyl			Shower Stall/Tub		Condition	Above Normal	EFF Year			
GLA 1st/2nd	966 / 640	Roof	Asph / Gable			Mtl St Sh Bath	1	Bsmt (SF)	96	Condition			
		Interior Finish	Drwl			Mtl Stall Shower		NoBsmt Flr(SF)		Bsmt (SF)			
		Flooring	Carp / Vinyl			No Bathroom	1	Heat	FHA - Gas	Qtrs Over			
		Non-base Heating		Fireplace		Wet Bar		AC	Yes	Qtrs Over (SF)			
		Floor/Wall #	0			Whirlpool Bathroom		Attic (SF)		Qtrs AC (SF)			
		Pipeless #	0			Whirlpool Tub		See other pages for more additions.					
		Hand Fired (Y/N)	No			No Hot Water Tank							
Condition	A NML	Space Heat #	0			No Plumbing							
		Appliances											
Basement	Full	Range Unit	Built-In Vacuums			Sewer & Water Only							
No Bsmt Flr.	0	Oven - Single	Intercom System			Water Only w/Sink							
Heat	FHA - Gas	Oven - Double	Bl Stereo			Hot Tub							
AC	Yes	Dishwasher				Bidet							
Attic	None	Microwave				Fbgl Service Sink							
		Trash Compactor				Urinal							
		Jennair				Sauna							
		Security System				W'Pool Bath w/Shower							
						Water Only							
						No Tub/Shower							



Bldg / Addn	Description	Units	Year			
1 of 1	101 — Single-Family / Owner Occupied					
	2 Story Frame	640				
	Base Heat: FHA - Gas					
	Add Central Air	640				
	Deck #1: Wood Deck-Low	200 SF				
	Plumbing	4				
1 of 2	Adtn 1 Story Frame	96 SF	1910			
	Basement area	96 SF				
2 of 2	Adtn 1 Story Frame	230 SF	1910			

	Count	Ag Building Description	Units	Year
1 of 2 P:1	1	L FR @ .40 906-Barn - Flat	30' X 40' 1,200 SF	1900
2 of 2 P:2	1	C/S @ SV 932-Silo - Conc	16' X 31' 5,009 Bu	1900

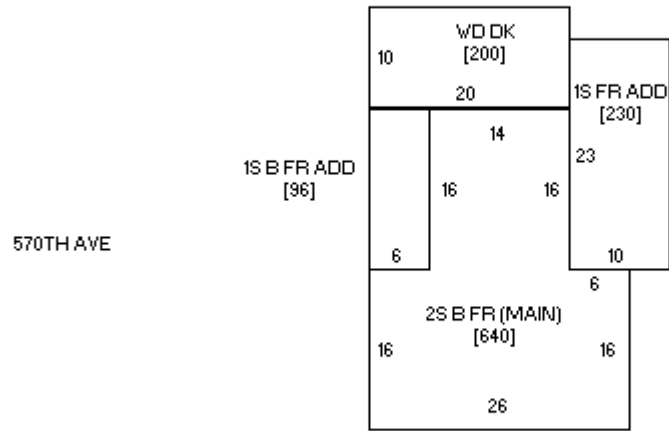

Sketch 1 of 1



Photo 1 of 1 08/11/2008