

NK

Pin: 08-36-100-012
Sale Date: 01/13/15
Sale Price: \$95,500
Acres: 7.06 Net
Classification: Rural Residential

R-Res

7921.50
08-36-100-012

04 04

04 04

~~# 7921.50~~

13

04

04

7922.00 08-36-100-011

1

LEGAL DESCRIPTION:

CLASS:

36-92-35 R RESIDENTIAL
A.C.T. FAIRFIELD
PARCEL F IN NW 1/4

-----		CSR'S	.00		
				CODE	VALUE ACRES
GROSS	7.08	CURRENT			
ROADS	.02	LAND	23,920		
D.D.		BLDG			
R.R.		DWLG	53,110(1)		
MISC					
		TOTAL	77,030		
NET	7.06				

=====		=====		=====	
		YEAR	2015		
		LAND	23,920	ROAD	.02
		BLDG			
		DWLG	53,110(1)		
		TOTAL	77,030		
		NET TX			

-----		-----		-----		-----	
DEED HOLDER:	DATE REFER	CONTRACT HOLDER:	DATE REFER	YEAR	2014		
CARAWAY SHANE M	02182015 4			LAND	23,000	ROAD	.02
CARAWAY AMANDA K				BLDG			
5328 240TH AVE				DWLG	51,070(1)		
ALBERT CITY IA 50510				TOTAL	74,070		
				NET TX			

-----		-----		-----		-----	
CARLSON JORDAN D	01252013 3			YEAR	2013		
				LAND	23,000	ROAD	.02
				BLDG			
5328 240TH AVE				DWLG	51,070(1)		
ALBERT CITY IA 50510				TOTAL	74,070		
				NET TX			

-----		-----		-----		-----	
PORATH FLORENCE				YEAR	2013 REFER: 1		
				LAND	12,090		
				BLDG	1,840(2)		
630 HWY N14 #207				DWLG	46,210(1)		
ALBERT CITY IA 50510				TOTAL	60,140		
				NET TX			

-----		-----		-----		-----	
REMARKS:				YEAR	2012 REFER: 2		
				LAND	12,090		
				BLDG	1,840(2)		
1 !2013)SPLIT FROM 4,5,6,9 (01/14/13)				DWLG	46,210(1)		
2 !2012)SPLIT FROM 4,5,6,9 (01/14/13)				TOTAL	60,140		
3 W.D. #123470 11-07-12 \$85,600				NET TX			
4 W.D. #150104 01-13-15 \$95,500							

-----		-----		-----		-----	
				YEAR			
				LAND			
				BLDG			
				DWLG			
				TOTAL			
				NET TX			

Deed: CARAWAY SHANE M,CARAWAY AMANDA K
 Contract:
 CID#: 0792150
 DBA:
 MLS: 16884

Map Area: FAIRFIELD-RES
 Route: 905-001-960
 Tax Dist: ACT FAIRFIELD
 Plat Page: -
 Subdiv: [NONE]

Checks/Tags:
 Lister/Date: JF, 09/25/2008
 Review/Date: DS, 10/23/2008
 Entry Status: Estimated

RURAL/RESIDENTIAL

Legal: 36-92-35 A.C.T. FAIRFIELD PARCEL F IN NW 1/4

Land									
Land Basis	Front	Rear	Side 1	Side 2	R. Lot	SF	Acres		
Site-Excess							1.000		
Excess 1							6.060		
Sub Total						307,533.60	7.060		
Grand Total						307,533.60	7.060		

Sales				Building Permits				Values			
Date	\$ Amount	NUTC	Recording	Date	Number	Tag	\$ Amount	Reason			
01/13/2015	\$95,500	D0	150104								
11/07/2012	\$85,600	D15	123470								

Res. Structure		Finish				Plumbing		Addition		Garage	
Occ. Code	101	Ttl Rooms Above #	8	Bedrooms Above #	4	Full Bath	1	Addition	No Additions	Garage	No garages
Occ. Descr.	Single-Family / Owner Occupied	Ttl Rooms Below #	0	Bedrooms Below #	0	Shower Stall Bath		Year Built		Style	
Year Built	1890	Bsmt Fin Area #1				Toilet Room		EFA		W X L	
EFA / EFYr	119 / 1890	Bsmt Fin Area #2				Lavatory		EFA Year		Area (SF)	
Arch. Dsgn	N/A	Bsmt Fin Area #3				Water Closet	1	Style		Year Built	
Style	1 1/2 Story Frame	Foundation	Strn			Sink	1	Area (SF)		EFA	
AreaSF/TLA	1,056 / 1,795	Exterior Walls	Stl			Shower Stall/Tub		Condition		EFF Year	
GLA 1st/2nd	1,056 / 739	Roof	Asph / Gable			Mtl St Sh Bath				Condition	
		Interior Finish	Plas			Mtl Stall Shower		Bsmt (SF)		Bsmt (SF)	
		Flooring	Carp / Vinyl			No Bathroom		NoBsmt Flr(SF)		Qtrs Over	
		Non-base Heating		Fireplace		Wet Bar		Heat		Qtrs Over (SF)	
		Floor/Wall #	0			Whirlpool Bathroom		AC		Qtrs AC (SF)	
		Pipeless #	0			Whirlpool Tub		Attic (SF)			
		Hand Fired (Y/N)	No			No Hot Water Tank					
Condition	NML	Space Heat #	0			No Plumbing				Door Opnrs	
		Appliances				Sewer & Water Only				Bsmt Stalls	
Basement	1/2	Range Unit		Built-In Vacuums		Water Only w/Sink					
No Bsmt Flr.	0	Oven - Single		Intercom System		Hot Tub					
Heat	FHA - Gas	Oven - Double		BI Stereo		Bidet					
AC	No	Dishwasher				Fbgl Service Sink					
Attic	None	Microwave				Urinal					
		Trash Compactor				Sauna					
		Jennair				W'Pool Bath w/Shower					
		Security System				Water Only					
						No Tub/Shower					



Bldg / Addn 1 of 1	Description	Units		Year				
	101 — Single-Family / Owner Occupied							
	1 1/2 Story Frame	1,056						
	Adjustment for basement - 1/2							
	Base Heat: FHA - Gas							
#1	Porch: 1S Frame Open	80 SF						
#2	Porch: 1S Frame Open	40 SF						
#3	Porch: 1S Frame Screen	154 SF						
	Deck #1: Concrete Patio-Med	80 SF						
	Plumbing	3						

	Count	Ag Building Description	Units	Year
1 of 1 P:1	1	MTL POLE 924-Machine or Utility Bldg	24' X 80' 1,920 SF	1969

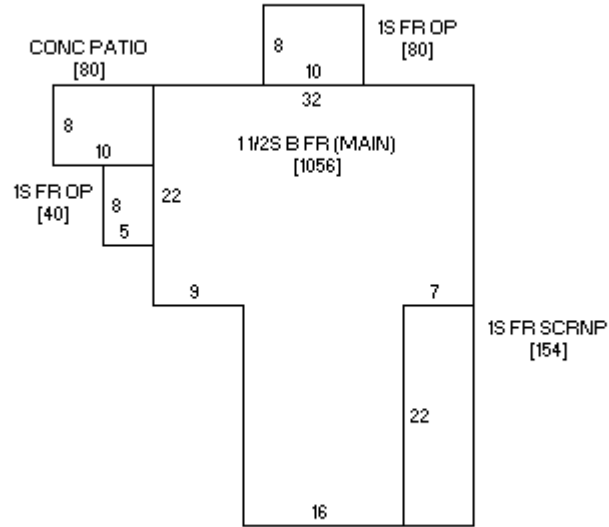

Sketch 1 of 1

