

LEGAL DESCRIPTION:	CLASS:	-----	CSR'S	.00	CODE	VALUE ACRES
04-02	R RESIDENTIAL		GROSS	CURRENT		
SL HAYES S-W S SD			ROADS	LAND	66,250	
CASINO BEACH			D.D.	BLDG		
			R.R.	DWLG	27,210( 1)	
			MISC			
				TOTAL	93,460	
			NET			

-----		YEAR	2015	-----
		LAND	66,250	
		BLDG		
		DWLG	27,210( 1)	
		TOTAL	93,460	
		NET TX		

DEED HOLDER:	DATE REFER	CONTRACT HOLDER:	DATE REFER	YEAR	2014
SNYDER MARK	12292015 4			LAND	63,700
1347 650TH ST				BLDG	
STORM LAKE IA 50588				DWLG	26,160( 1)
				TOTAL	89,860
				NET TX	

-----		YEAR	2013	-----
CASINO BEACH PROPERTIES LLC	12102015 4	LAND	63,700	
206 SCOTT		BLDG		
STORM LAKE IA 50588		DWLG	26,160( 1)	
		TOTAL	89,860	
		NET TX		

-----		YEAR	2012	-----
BROWN JAMI L	11062015 3	LAND	63,700	
BAUER JON M		BLDG		
206 SCOTT		DWLG	26,160( 1)	
STORM LAKE IA 50588		TOTAL	89,860	
		NET TX		

-----		YEAR	2011	-----
LANPHERE MARY A REV TRUST	2	LAND	63,700	
114 WHITE CAP RD		BLDG		
STORM LAKE IA 50588		DWLG	26,160( 1)	
		TOTAL	89,860	
		NET TX		

-----		YEAR	2010	-----
REMARKS:		LAND	63,700	
2 W.D. #093791 11-24-09		BLDG		
3 W.D. #152427 08-18-15 \$75,000		DWLG	26,160( 1)	
4 W.D. #152983 11-30-15 \$105,000		TOTAL	89,860	
		NET TX		

-----		YEAR	2010	-----
		LAND	63,700	
		BLDG		
		DWLG	26,160( 1)	
		TOTAL	89,860	
		NET TX		

109 WHITE CAP RD, STORM LAKE

Deed: SNYDER MARK

Map Area: HAYES-RES(CASINO)

Checks/Tags: S

Contract:

Route: 915-001-320

Lister/Date: LF, 06/19/2008

CID#: 0947900

Tax Dist: SL HAYES S-W S SD

Review/Date: TG, 11/26/2008

DBA:

Plat Page: -

Entry Status: Inspected

MLS: 17912

Subdiv: [NONE]

RURAL/RESIDENTIAL

Legal: 04-02 SL HAYES S-W S SD CASINO BEACH

Land										
Land Basis	Front	Rear	Side 1	Side 2	R. Lot	SF	Acres			
FF Main	40.00	40.00	100.00	100.00	0.00					
Sub Total						4,000.00	0.092			
Grand Total						4,000.00	0.092			

Street	Utilities	Zoning	Land Use
FF Main   Paved	City	Not Applicable	Not Applicable

Sales				Building Permits				Values			
Date	\$ Amount	NUTC	Recording	Date	Number	Tag	\$ Amount	Reason			
11/30/2015	\$105,000	D0	152983								
10/29/2015	\$0	D38	152721								
08/18/2015	\$75,000	D0	152427								
11/24/2009	\$0	D38	093791								

Res. Structure	Finish	Plumbing	Addition	Garage
Occ. Code 101	Ttl Rooms Above # 4	Bedrooms Above # 1	Full Bath 1	Garage No garages
Occ. Descr. Single-Family / Owner Occupied	Ttl Rooms Below # 0	Bedrooms Below # 0	Shower Stall Bath	Style
Year Built 1944	Bsmt Fin Area #1		Toilet Room	W X L
EFA / EFYr 65 / 1944	Bsmt Fin Area #2		Lavatory	Area (SF)
Arch. Dsgn N/A	Bsmt Fin Area #3		Water Closet	Year Built
Style 1 Story Frame	Foundation C Bk		Sink	EFA
AreaSF/TLA 640 / 640	Exterior Walls Composite		Shower Stall/Tub	Condition
GLA 1st/2nd 640 / 0	Roof Asph / Gable		Mtl St Sh Bath	EFF Year
	Interior Finish Drwl		Mtl Stall Shower	Condition
	Flooring Carp / Vinyl		No Bathroom	Bsmt (SF)
	<b>Non-base Heating</b>		Wet Bar	NoBsmt Flr(SF)
	<b>Fireplace</b>		Whirlpool Bathroom	Heat
	Floor/Wall # 0		Whirlpool Tub	AC
	Pipeless # 0		No Hot Water Tank	Attic (SF)
	Hand Fired (Y/N) No		No Plumbing	
Condition NML	Space Heat # 0		Sewer & Water Only	Door Opnrs
	<b>Appliances</b>		Water Only w/Sink	Bsmt Stalls
Basement None	Range Unit	Built-In Vacuums	Hot Tub	
No Bsmt Flr. 0	Oven - Single	Intercom System	Bidet	
	Oven - Double	BI Stereo	FbglS Service Sink	
Heat Elec - Basebd	Dishwasher		Urinal	
AC No	Microwave		Sauna	
Attic None	Trash Compactor		W'Pool Bath w/Shower	
	Jennair		Water Only	
	Security System		No Tub/Shower	



Bldg / Addn	Description	Units	Year				
	101 — Single-Family / Owner Occupied						
	1 Story Frame	640					
	Adjustment for basement - None						
	Base Heat: Elec - Basebd						
	Deck #1: Wood Deck-Low	140 SF					

Description	Units	Cond	Year
Yrd 1 - Shed		NML	1950

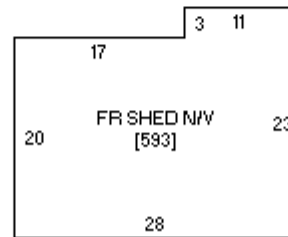
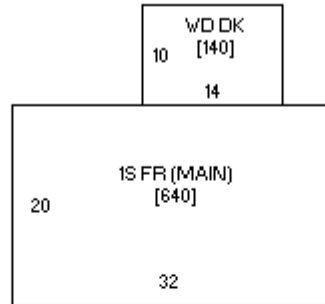

Sketch 1 of 1



Photo 1 of 2 06/26/2008



Photo 2 of 2 05/01/1998