

LEGAL DESCRIPTION:	CLASS:	-----	CSR'S	.00	CODE	VALUE ACRES
04-02	R RESIDENTIAL		GROSS	CURRENT		
SL HAYES S-W S SD			ROADS	LAND	66,250	
CASINO BEACH			D.D.	BLDG		
			R.R.	DWLG	27,210(1)	
			MISC			
				TOTAL	93,460	
			NET			

-----		YEAR	2015	
		LAND	66,250	
		BLDG		
		DWLG	27,210(1)	
		TOTAL	93,460	
		NET TX		

DEED HOLDER:	DATE REFER	CONTRACT HOLDER:	DATE REFER	YEAR	2014	
BROWN JAMI L	11062015 3			LAND	63,700	
BAUER JON M				BLDG		
206 SCOTT				DWLG	26,160(1)	
STORM LAKE IA 50588				TOTAL	89,860	
				NET TX		

-----		YEAR	2013	
LANPHERE MARY A REV TRUST	01152010 2	LAND	63,700	
114 WHITE CAP RD		BLDG		
STORM LAKE IA 50588		DWLG	26,160(1)	
		TOTAL	89,860	
		NET TX		

-----		YEAR	2012	
LANPHERE MARY A	1	LAND	63,700	
114 WHITE CAP RD		BLDG		
STORM LAKE IA 50588		DWLG	26,160(1)	
		TOTAL	89,860	
		NET TX		

-----		YEAR	2011	
REMARKS:		LAND	63,700	
1 QCD 58/238 01-14-92 & QCD 58/255		BLDG		
2 W.D. #093791 11-24-09		DWLG	26,160(1)	
3 W.D. #152427 08-18-15 \$75,000		TOTAL	89,860	
		NET TX		

-----		YEAR	2010	
		LAND	63,700	
		BLDG		
		DWLG	26,160(1)	
		TOTAL	89,860	
		NET TX		

109 WHITE CAP RD, STORM LAKE

Deed: BROWN JAMI L,BAUER JON M

Map Area: HAYES-RES(CASINO)

Checks/Tags: S

Contract:

Route: 915-001-320

Lister/Date: LF, 06/19/2008

CID#: 0947900

Tax Dist: SL HAYES S-W S SD

Review/Date: TG, 11/26/2008

DBA:

Plat Page: -

Entry Status: Inspected

MLS: 17912

Subdiv: [NONE]

RURAL/RESIDENTIAL

Legal: 04-02 SL HAYES S-W S SD CASINO BEACH

Land										
Land Basis	Front	Rear	Side 1	Side 2	R. Lot	SF	Acres			
FF Main	40.00	40.00	100.00	100.00	0.00					
Sub Total						4,000.00	0.092			
Grand Total						4,000.00	0.092			

Street	Utilities	Zoning	Land Use
FF Main Paved	City	Not Applicable	Not Applicable

Sales				Building Permits				Values			
Date	\$ Amount	NUTC	Recording	Date	Number	Tag	\$ Amount	Reason			
08/18/2015	\$75,000	D0	152427								
11/24/2009	\$0	D38	093791								

Res. Structure	1 of 1	Finish				Plumbing				Addition		Garage	
Occ. Code	101	Ttl Rooms Above #	4	Bedrooms Above #	1	Full Bath	1	Addition	No Additions	Garage	No garages		
Occ. Descr.	Single-Family / Owner Occupied	Ttl Rooms Below #	0	Bedrooms Below #	0	Shower Stall Bath		Year Built		Style			
Year Built	1944	Bsmt Fin Area #1				Toilet Room		EFA		W X L			
EFA / EFYr	65 / 1944	Bsmt Fin Area #2				Lavatory		EFA Year		Area (SF)			
Arch. Dsgn	N/A	Bsmt Fin Area #3				Water Closet		Style		Year Built			
Style	1 Story Frame	Foundation	C Bk			Sink		Area (SF)		EFA			
AreaSF/TLA	640 / 640	Exterior Walls	Composite			Shower Stall/Tub		Condition		EFF Year			
GLA 1st/2nd	640 / 0	Roof	Asph / Gable			Mtl St Sh Bath				Condition			
		Interior Finish	Drwl			Mtl Stall Shower		Bsmt (SF)		Bsmt (SF)			
		Flooring	Carp / Vinyl			No Bathroom		NoBsmt Flr(SF)		Qtrs Over			
		Non-base Heating		Fireplace		Wet Bar		Heat		Qtrs Over (SF)			
		Floor/Wall #	0			Whirlpool Bathroom		AC		Qtrs AC (SF)			
		Pipeless #	0			Whirlpool Tub		Attic (SF)					
		Hand Fired (Y/N)	No			No Hot Water Tank							
Condition	NML	Space Heat #	0			No Plumbing				Door Opnrs			
		Appliances				Sewer & Water Only				Bsmt Stalls			
Basement	None	Range Unit	Built-In Vacuums			Water Only w/Sink							
No Bsmt Flr.	0	Oven - Single	Intercom System			Hot Tub							
Heat	Elec - Basebd	Oven - Double	BI Stereo			Bidet							
AC	No	Dishwasher				FbglS Service Sink							
Attic	None	Microwave				Urinal							
		Trash Compactor				Sauna							
		Jennair				W'Pool Bath w/Shower							
		Security System				Water Only							
						No Tub/Shower							



Bldg / Addn 1 of 1	Description	Units	Year				
	101 — Single-Family / Owner Occupied						
	1 Story Frame	640					
	Adjustment for basement - None						
	Base Heat: Elec - Basebd						
	Deck #1: Wood Deck-Low	140 SF					

Yrd	Description	Units	Cond	Year											
1	Sheds		NML	1950											

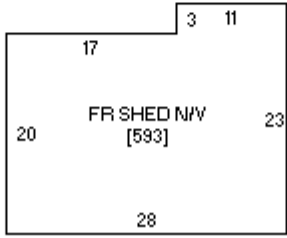
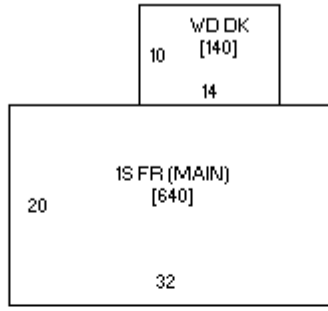

Sketch 1 of 1

