

Pin: 15-10-400-004
Sale Date: 04/14/15
Sale Price: \$270,000
Net Acres: 4.78
Classification: Rural Residential

15-10-400-004

#8203.50

R-Res

Page 1 of 2



Mach Shed



#3 -
Horse
Shed

#4 -
Roof

Att
Gar

LEGAL DESCRIPTION:

CLASS:

10-90-36 R RESIDENTIAL
NEWELL PROV. PROV.
PT SE SE
(748.86' X 290.84')

-----		CSR'S	.00		
				CODE	VALUE ACRES
GROSS	5.00	CURRENT			
ROADS	.22	LAND	24,960		
D.D.		BLDG			
R.R.		DWLG	213,730(1)		
MISC					
		TOTAL	238,690		
NET	4.78				

=====		=====		=====	
		YEAR	2015		
		LAND	24,960	ROAD	.22
		BLDG			
		DWLG	213,730(1)		
		TOTAL	238,690		
		NET TX			

-----		-----		-----	
DEED HOLDER:	DATE REFER	CONTRACT HOLDER:	DATE REFER	YEAR	2014
				LAND	24,000
WHITE DOUGLAS	05282015 2			ROAD	.22
				BLDG	
WHITE ALLISON				DWLG	205,510(1)
6179 170TH AVE				TOTAL	229,510
NEWELL IA 50568				NET TX	

-----		-----		-----	
				YEAR	2013
LAURSEN LYNN C	1			LAND	24,000
				ROAD	.22
LAURSEN TAMI				BLDG	
700 LAKESHORE DR				DWLG	205,510(1)
LAKESIDE IA 50588				TOTAL	229,510
				NET TX	

-----		-----		-----	
				YEAR	2012
				LAND	24,000
				ROAD	.22
				BLDG	
				DWLG	205,510(1)
				TOTAL	229,510
				NET TX	

-----		-----		-----	
				YEAR	2011
REMARKS:				LAND	24,000
				ROAD	.22
				BLDG	
1 W.D. 55/199 04-27-87 \$3,125				DWLG	205,510(1)
2 W.D. #150780 04-14-15 \$270,000				TOTAL	229,510
				NET TX	

-----		-----		-----	
				YEAR	2010
				LAND	24,000
				ROAD	.22
				BLDG	
				DWLG	205,510(1)
				TOTAL	229,510
				NET TX	

6179 170TH AVE, NEWELL

Deed: WHITE DOUGLAS,WHITE ALLISON

Map Area: PROV-RES

Checks/Tags:

Contract:

Route: 914-001-610

Lister/Date: LF, 09/23/2008

CID#: 0820350

Tax Dist: N-P PROVIDENCE

Review/Date: DS, 11/11/2008

DBA:

Plat Page:

Entry Status: Inspected

MLS:

Subdiv: [NONE]

RURAL/RESIDENTIAL

Legal: 10-90-36 NEWELL PROV. PROV. PT SE SE (748.86' X 290.84')

Land									
Land Basis	Front	Rear	Side 1	Side 2	R. Lot	SF	Acres		
Site-Excess							1.000		
Excess 1							3.780		
Sub Total						208,216.80	4.780		
Grand Total						208,216.80	4.780		

Sales				Building Permits				Values			
Date	\$ Amount	NUTC	Recording	Date	Number	Tag	\$ Amount	Reason			
04/14/2015	\$270,000	D0	150780								
04/27/1987	\$3,125	D26									

Res. Structure		Finish				Plumbing		Addition		Garage	
Occ. Code	101	Ttl Rooms Above #	7	Bedrooms Above #	3	Full Bath	1	Addition	1 of 1	Garage	1 of 1
Occ. Descr.	Single-Family / Owner Occupied	Ttl Rooms Below #	0	Bedrooms Below #	0	Shower Stall Bath	1	Year Built	2004	Style	Att Frm
Year Built	1987	Bsmt Fin Area #1				Toilet Room		EFA	5	W X L	0' X 0'
EFA / EFYr	22 / 1987	Bsmt Fin Area #2				Lavatory	1	EFA Year	2004	Area (SF)	1,292
Arch. Dsgn	N/A	Bsmt Fin Area #3				Water Closet		Style	1 Sty Frm	Year Built	2004
Style	1 Story Frame	Foundation	POURED CONCRETE			Sink		Area (SF)	768	EFA	5
AreaSF/TLA	1,932 / 2,700	Exterior Walls	Brk			Shower Stall/Tub		Condition	Normal	EFF Year	2004
GLA 1st/2nd	2,700 / 0	Roof	Asph / Gable			Mtl St Sh Bath		Bsmt (SF)		Condition	NML
Condition	A NML	Interior Finish	Drwl			Mtl Stall Shower		NoBsmt Flr(SF)		Bsmt (SF)	
Basement	None	Flooring	Carp / Vinyl			No Bathroom		Heat	Elec - Radiant	Qtrs Over	None
No Bsmt Flr.	0	Non-base Heating		Fireplace		Wet Bar		AC	Yes	Qtrs Over (SF)	
Heat	Elec - Radiant	Floor/Wall #	0	Prefab, 1 Sty	1	Whirlpool Bathroom		Attic (SF)		Qtrs AC (SF)	
AC	Yes	Pipeless #	0	Gas/Elec-Side, 1 Sty	1	Whirlpool Tub					
Attic	None	Hand Fired (Y/N)	No			No Hot Water Tank					
		Space Heat #	0			No Plumbing					
		Appliances				Sewer & Water Only					
		Range Unit	Built-In Vacuums			Water Only w/Sink					
		Oven - Single	Intercom System			Hot Tub					
		Oven - Double	BI Stereo			Bidet					
		Dishwasher				Fbgl Service Sink					
		Microwave				Urinal					
		Trash Compactor				Sauna					
		Jennair				W'Pool Bath w/Shower					
		Security System				Water Only					
						No Tub/Shower					



Bldg / Addn 1 of 1	Description	Units	Year				
	101 — Single-Family / Owner Occupied						
	1 Story Frame	1,932					
	Adjustment for basement - None						
	Base Heat: Elec - Radiant						
	Add Central Air	1,932					
#1	Porch: 1S Brick Enclosed	288 SF					
	Deck #1: Concrete Patio-Low	713 SF					
	Veneer #1 1/2 Story Brick	64.0 LF					
	Veneer #2 1 Story Brick	128.0 LF					
	Plumbing	3					
#1	Fireplace: Prefab, 1 Story	1					
#2	Fireplace: Gas/Elec-Side, 1 Story	1					
	Garage: Att Frame	1,292 SF	2004				
1 of 1	Adtn 1 Story Frame	768 SF	2004				

	Count	Ag Building Description	Units	Year					
1 of 3 P:1	1	MTL WD FR 925-Steel Utility Bldg	25' X 40' 1,000 SF	1991					
2 of 3 P:3	1	HORSE BARN MTL WD FR 925-Steel Utility Bldg	24' X 32' 768 SF	2002					
3 of 3 P:0	1	MTL ROOF 908-Lean-To	10' X 24' 240 SF	2002					

Yrd	Description	Units	Cond	Year
1	Sheds		NML	1966

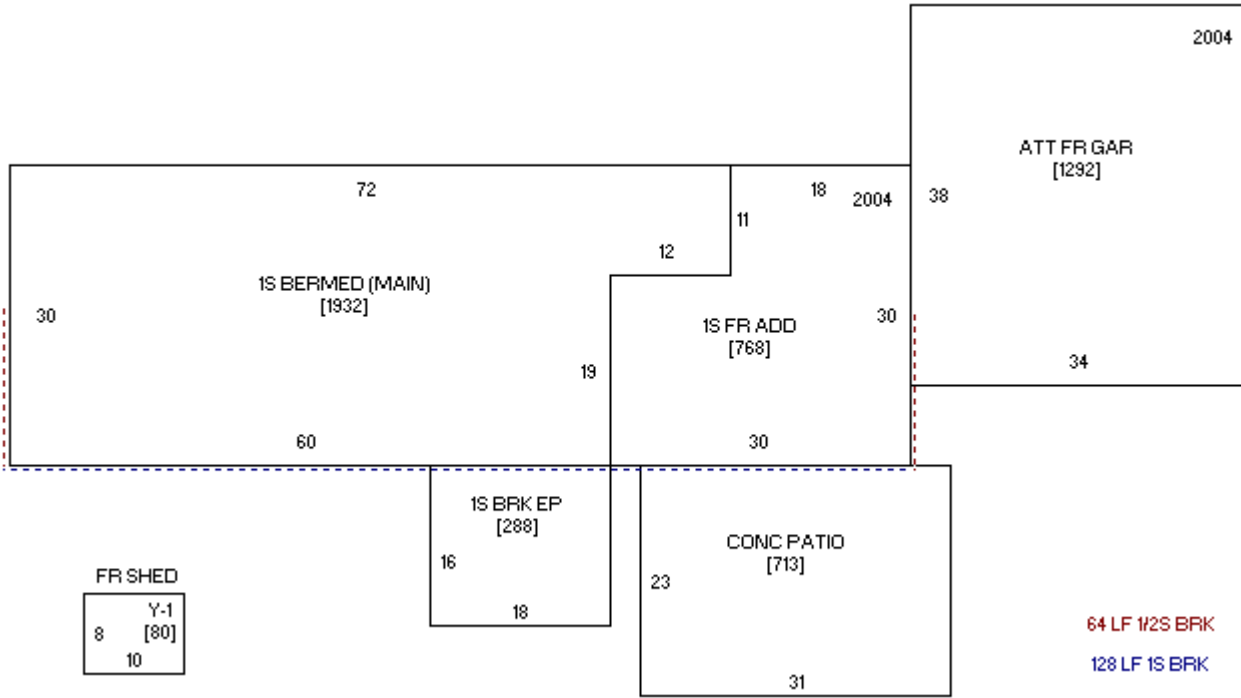

Sketch 1 of 1

