

LEGAL DESCRIPTION:

CLASS:

-----		CSR'S	.00	-----	
				CODE	VALUE ACRES
GROSS	CURRENT				
ROADS	LAND	13,660			
D.D.	BLDG				
R.R.	DWLG	52,420(1)			
MISC					
	TOTAL	66,080			
NET					

29-00 R RESIDENTIAL
 ALTA WASH LC AREA SSD
 LAKE CREEK VILLA 1
 #108-U

=====		YEAR	2015	=====	
LAND		13,660			
BLDG					
DWLG		52,420(1)			
TOTAL		66,080			
NET TX					

DEED HOLDER:	DATE REFER	CONTRACT HOLDER:	DATE REFER	YEAR	2014
ZYLSTRA LAYTON R	09032015 6			LAND	13,130
ZYLSTRA REBECCA M				BLDG	
2329 SUNCREST DR				DWLG	50,400(1)
AMES IA 50014				TOTAL	63,530
				NET TX	

DEED HOLDER:	DATE REFER	CONTRACT HOLDER:	DATE REFER	YEAR	2013
HASELHOFF JIM	07022012 5			LAND	13,130
				BLDG	
1107 ST ANDREWS DR				DWLG	50,400(1)
CHEROKEE IA 51012				TOTAL	63,530
				NET TX	

DEED HOLDER:	DATE REFER	CONTRACT HOLDER:	DATE REFER	YEAR	2012
108 VILLA RD				LAND	13,130
ALTA IA 51002				BLDG	
				DWLG	50,400(1)
MOSEL ALISON B	3			TOTAL	63,530
				NET TX	

REMARKS:	YEAR	2011
3 W.D. #042083 08-12-04 \$51,500 (D008)	LAND	13,130
4 W.D. #082152 07-21-08 \$65,000 (D008)	BLDG	
5 W.D. #121669 06-19-12 \$59,600	DWLG	50,400(1)
6 W.D. #151919 08-06-15 \$61,500	TOTAL	63,530
	NET TX	

REMARKS:	YEAR	2010
	LAND	13,130
	BLDG	
	DWLG	50,400(1)
	TOTAL	63,530
	NET TX	

108 VILLA RD, ALTA

Deed: ZYLSTRA LAYTON R,ZYLSTRA REBECCA M

Map Area: WASH-RES(LAKE CREEK)

Checks/Tags:

Contract:

Route: 910-003-270

Lister/Date: LF, 08/07/2008

CID#: 0982500

Tax Dist: ALTA WASH LC AREA SSD

Review/Date: DS, 12/09/2008

DBA:

Plat Page: -

Entry Status: Inspected

RURAL/RESIDENTIAL

MLS: 17660

Subdiv: [NONE]

Legal: 29-00 ALTA WASH LC AREA SSD LAKE CREEK VILLA 1 #108-U

Land										
Land Basis	Front	Rear	Side 1	Side 2	R. Lot	SF	Acres			
SqFt X Rate						5,250.00	0.120			
Grand Total						5,250.00	0.120			

SqFt X Rate	Street Paved	Utilities City	Zoning Not Applicable	Land Use Not Applicable
-------------	--------------	----------------	-----------------------	-------------------------

Sales				Building Permits				Values			
Date	\$ Amount	NUTC	Recording	Date	Number	Tag	\$ Amount	Reason			
08/06/2015	\$61,500	D0	151919								
06/19/2012	\$59,600	D0	121669								
07/21/2008	\$65,000	D0	082152								
08/12/2004	\$51,500	D0	#043083								

Res. Structure		Finish				Plumbing		Addition		Garage	
Occ. Code	113	Ttl Rooms Above #	4	Bedrooms Above #	2	Full Bath	1	Addition	No Additions	Garage	1 of 1
Occ. Descr.	Condominium	Ttl Rooms Below #	0	Bedrooms Below #	0	Shower Stall Bath		Year Built		Style	Det Frm
Year Built	1973	Bsmt Fin Area #1				Toilet Room		EFA		W X L	14' X 22'
EFA / EfyR	36 / 1973	Bsmt Fin Area #2				Lavatory		EFA Year		Area (SF)	308
Arch. Dsgn	N/A	Bsmt Fin Area #3				Water Closet		Style		Year Built	1973
Style	1 Story Frame	Foundation	Conc			Sink		Area (SF)		EFA	36
AreaSF/TLA	1,136 / 1,136	Exterior Walls	BRICK VENNER			Shower Stall/Tub		Condition		EFF Year	1973
GLA 1st/2nd	1,136 / 0	Roof	Asph / Gable			Mtl St Sh Bath	1			Condition	NML
Condition	NML	Interior Finish	Drwl			Mtl Stall Shower		Bsmt (SF)		Bsmt (SF)	
Basement	None	Flooring	Carp / Vinyl / Hdwd			No Bathroom		NoBsmt Flr(SF)		Qtrs Over	None
No Bsmt Flr.	0	Non-base Heating		Fireplace		Wet Bar		Heat		Qtrs Over (SF)	
Heat	FHA - Electric	Floor/Wall #	0			Whirlpool Bathroom		AC		Qtrs AC (SF)	
AC	Yes	Pipeless #	0			Whirlpool Tub		Attic (SF)		Door Opnrs	
Attic	None	Hand Fired (Y/N)	No			No Hot Water Tank				Bsmt Stalls	
		Space Heat #	0			No Plumbing					
		Appliances				Sewer & Water Only					
		Range Unit	Built-In Vacuums			Water Only w/Sink					
		Oven - Single	Intercom System			Hot Tub					
		Oven - Double	BI Stereo			Bidet					
		Dishwasher				Fbgls Service Sink					
		Microwave				Urinal					
		Trash Compactor				Sauna					
		Jennair				W'Pool Bath w/Shower					
		Security System				Water Only					
						No Tub/Shower					



Bldg / Addn 1 of 1	Description	Units		Year				
	113 — Condominium							
	1 Story Frame	1,136						
	Adjustment for basement - None							
	Base Heat: FHA - Electric							
	Add Central Air	1,136						
	Plumbing	2						
BEx	1/8TH COMMON AREA	126 SF						
	Garage: Det Frame	14' X 22'	308 SF		1973			

P:0	Yrd	Description	Units	Cond	Year				
		1 - 2-12 X 22 ASSOC GAR(1/20th)		NML	1973				

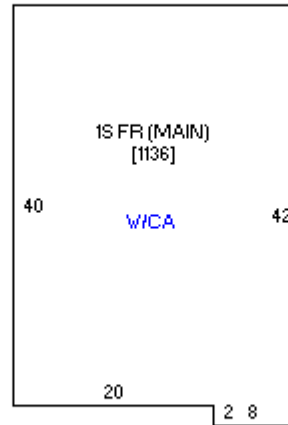

Sketch 1 of 1

