

LEGAL DESCRIPTION:

CLASS:

-----		CSR'S	.00	-----	
				CODE	VALUE ACRES
GROSS		CURRENT			
ROADS		LAND 64,700			
D.D.		BLDG			
R.R.		DWLG 67,550( 1)			
MISC					
		TOTAL 132,250			
NET					

08-06 R RESIDENTIAL  
 SL HAYES S-W S SD  
 CASINO BEACH

===== ===== =====	
YEAR	2016
LAND	64,700
BLDG	
DWLG	67,550( 1)
TOTAL	132,250
NET TX	

-----		DEED HOLDER:	DATE REFER	CONTRACT HOLDER:	DATE REFER	YEAR	2015	-----	
						LAND	64,700		
		ANDERSON EDWARD CORY	05042016 4			BLDG			
		ANDERSON JILL LYN				DWLG	66,340( 1)		
		757 500TH ST				TOTAL	131,040		
		ALTA IA 51002				NET TX			

		CURRIE JEFF B	07091998 3	DEBNER J D	1	YEAR	2014		
		CURRIE JEAN M				LAND	62,210		
		130 SCOTT ST		R R 1		BLDG			
		STORM LAKE IA 50588		STORM LAKE IA		DWLG	63,790( 1)		
						TOTAL	126,000		
		DEBNER J D	10271993 2	.		NET TX			

		R R 2 BOX 148				YEAR	2013		
		KEOSAUQUA IA				LAND	62,210		
						BLDG			
		LUBECK DORIS LIFE ESTATE				DWLG	63,790( 1)		
		LUBECK TERRY				TOTAL	126,000		
		ETAL				NET TX			

		REMARKS:				YEAR	2012		
		1 CONT 140/691 01-16-89 \$50,000 (C000)				LAND	62,210		
		2 W.D. 59/618-619 12-27-88 (D022)				BLDG			
		3 W.D. #982306 06-20-98 \$86,000 (D000)				DWLG	63,790( 1)		
		4 W.D. #160567 03-10-16 \$225,000				TOTAL	126,000		
						NET TX			

						YEAR	2011		
						LAND	62,210		
						BLDG			
						DWLG	63,790( 1)		
						TOTAL	126,000		
						NET TX			

Deed: **ANDERSON EDWARD CORY,ANDERSON JILL LYN** Map Area: **HAYES-RES(CASINO)**  
 Contract: \_\_\_\_\_ Route: **915-001-510**  
 CID#: **0950000** Tax Dist: **SL HAYES S-W S SD**  
 DBA: \_\_\_\_\_ Plat Page: -  
 MLS: **17995** Subdiv: **[NONE]**

Checks/Tags: **S**  
 Lister/Date: **LF, 06/20/2008**  
 Review/Date: **TG, 11/26/2008**  
 Entry Status: **Inspected**

**RURAL/RESIDENTIAL**

Legal: 08-06 SL HAYES S-W S SD CASINO BEACH

Land										
Land Basis	Front	Rear	Side 1	Side 2	R. Lot	SF	Acres			
<b>FF Main</b>	45.00	45.00	80.25	76.00	0.00					
Sub Total						3,515.63	0.081			
<b>Grand Total</b>						3,515.63	0.081			

Sales				Building Permits				Values			
Date	\$ Amount	NUTC	Recording	Date	Number	Tag	\$ Amount	Reason			
03/10/2016	\$225,000	D0	160567	7/23/1998	239899	N	\$5,000	Addition			
06/20/1998	\$86,000	D0	#982306								
01/16/1989	\$50,000	C0									

Res. Structure		Finish				Plumbing				Addition		Garage	
Occ. Code	101	Ttl Rooms Above #	4	Bedrooms Above #	2	Full Bath		Addition	No Additions	Garage	1 of 1		
Occ. Descr.	Single-Family / Owner Occupied	Ttl Rooms Below #	0	Bedrooms Below #	0	Shower Stall Bath	1	Year Built		Style	Att Frm		
Year Built	1955	Bsmt Fin Area #1				Toilet Room		EFA		W X L	0' X 0'		
EFA / EFYr	54 / 1955	Bsmt Fin Area #2				Lavatory		EFA Year		Area (SF)	525		
Arch. Dsgn	N/A	Bsmt Fin Area #3				Water Closet		Style		Year Built	1998		
Style	1 Story Frame	Foundation	C Bk			Sink		Area (SF)		EFA	11		
AreaSF/TLA	751 / 939	Exterior Walls	Vinyl			Shower Stall/Tub		Condition		EFF Year	1998		
GLA 1st/2nd	751 / 188	Roof	Asph / Gable			Mtl St Sh Bath				Condition	V Good		
		Interior Finish	Drwl			Mtl Stall Shower		Bsmt (SF)		Bsmt (SF)			
		Flooring	Carp / Vinyl			No Bathroom	1	NoBsmt Flr(SF)		Qtrs Over	None		
		<b>Non-base Heating</b>		<b>Fireplace</b>		Wet Bar		Heat		Qtrs Over (SF)			
		Floor/Wall #	0			Whirlpool Bathroom		AC		Qtrs AC (SF)			
		Pipeless #	0			Whirlpool Tub		Attic (SF)					
		Hand Fired (Y/N)	No			No Hot Water Tank							
Condition	V Good	Space Heat #	0			No Plumbing				Door Opnrs			
		<b>Appliances</b>				Sewer & Water Only				Bsmt Stalls			
Basement	None	Range Unit	Built-In Vacuums			Water Only w/Sink							
No Bsmt Flr.	0	Oven - Single	Intercom System			Hot Tub							
Heat	FHA - Gas	Oven - Double	BI Stereo			Bidet							
AC	Yes	Dishwasher				FbglS Service Sink							
Attic	1/4 Finished 188SF	Microwave				Urinal							
		Trash Compactor				Sauna							
		Jennair				W'Pool Bath w/Shower							
		Security System				Water Only							
						No Tub/Shower							



Bldg / Addn	Description	Units	Year
	101 — Single-Family / Owner Occupied		
	1 Story Frame	751	
	Adjustment for basement - None		
	Base Heat: FHA - Gas		
	Add Central Air	751	
	Add 1/4 Finished attic	188	
	Deck #1: Wood Deck-Med	96 SF	
	Deck #2: Concrete Patio-Med	252 SF	
	Plumbing	2	
	Garage: Att Frame	525 SF	1998

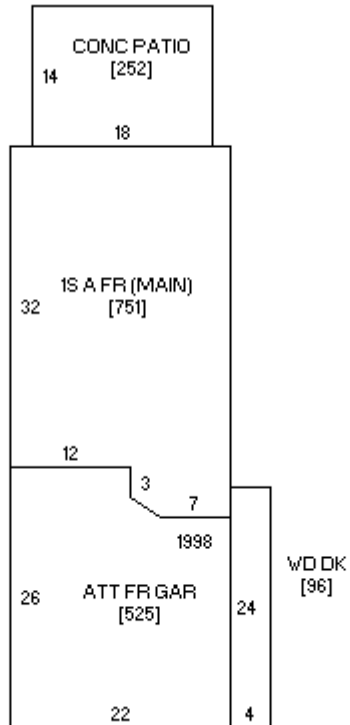

Sketch 1 of 1



Photo 1 of 2 06/26/2008



Photo 2 of 2 05/01/1998