

LEGAL DESCRIPTION:

CLASS:

-----		CSR'S	.00	-----	
				CODE	VALUE ACRES
GROSS	CURRENT				
ROADS	LAND	65,520			
D.D.	BLDG				
R.R.	DWLG	122,630( 1)			
MISC					
	TOTAL	188,150			
NET					

04-07 R RESIDENTIAL  
 SL HAYES S-W S SD  
 CASINO BEACH

=====		=====		=====	
	YEAR	2016			
	LAND	65,520			
	BLDG				
	DWLG	122,630( 1)			
	TOTAL	188,150			
	NET TX				

-----		-----		-----	
DEED HOLDER:	DATE REFER	CONTRACT HOLDER:	DATE REFER	YEAR	2015
HALVERSON MARK E	02102016 4			LAND	65,520
				BLDG	
				DWLG	122,630( 1)
4581 70TH AVE				TOTAL	188,150
LINN GROVE IA 51033				NET TX	

-----		-----		-----	
				YEAR	2014
BRYANT ROBERT E	12142011 3			LAND	63,000
BRYANT REBECCA L				BLDG	
116 SCOTT				DWLG	117,910( 1)
STORM LAKE IA 50588				TOTAL	180,910
				NET TX	

-----		-----		-----	
				YEAR	2013
122 SCOTT				LAND	63,000
STORM LAKE IA 50588				BLDG	
				DWLG	117,910( 1)
BERGLUND DAN B	1			TOTAL	180,910
				NET TX	

-----		-----		-----	
				YEAR	2012
REMARKS:				LAND	63,000
				BLDG	
1 W.D. 58/324 02-20-92 \$75,000 (D000)				DWLG	117,910( 1)
2 W.D. #973341 11-21-97 \$141,000 (D000)				TOTAL	180,910
3 W.D. #113285 11-21-11 \$226,000				NET TX	
4 W.D. #160038 01-04-16 \$295,000					

-----		-----		-----	
				YEAR	2011
				LAND	63,000
				BLDG	
				DWLG	117,910( 1)
				TOTAL	180,910
				NET TX	

Deed: HALVERSON MARK E  
 Contract:  
 CID#: 0950400  
 DBA:  
 MLS: 17823

Map Area: HAYES-RES(CASINO)  
 Route: 915-001-550  
 Tax Dist: SL HAYES S-W S SD  
 Plat Page: -  
 Subdiv: [NONE]

Checks/Tags: S  
 Lister/Date: LF, 06/23/2008  
 Review/Date: TG, 11/26/2008  
 Entry Status: Inspected

RURAL/RESIDENTIAL

Legal: 04-07 SL HAYES S-W S SD CASINO BEACH

Land										
Land Basis	Front	Rear	Side 1	Side 2	R. Lot	SF	Acres			
FF Main	45.00	45.00	79.65	80.72	0.00					
Sub Total						3,608.32	0.083			
Grand Total						3,608.32	0.083			

Sales				Building Permits				Values			
Date	\$ Amount	NUTC	Recording	Date	Number	Tag	\$ Amount	Reason			
01/04/2016	\$295,000	D0	160038								
11/21/2011	\$226,000	D0	113285								
11/21/1997	\$141,000	D0	#973341								
02/20/1992	\$75,000	D0	058-324								

Res. Structure		Finish				Plumbing		Addition		Garage	
Occ. Code	101	Ttl Rooms Above #	4	Bedrooms Above #	2	Full Bath	1	Addition	1 of 1	Garage	1 of 2
Occ. Descr.	Single-Family / Owner Occupied	Ttl Rooms Below #	0	Bedrooms Below #	0	Shower Stall Bath		Year Built	1998	Style	Att Frm
Year Built	1960	Bsmt Fin Area #1				Toilet Room		EFA	11	W X L	0' X 0'
EFA / EFYr	49 / 1960	Bsmt Fin Area #2				Lavatory		EFA Year	1998	Area (SF)	547
Arch. Dsgn	N/A	Bsmt Fin Area #3				Water Closet		Style	1 Sty Frm	Year Built	1960
Style	1 Story Frame	Foundation	Conc / Stn / C Blk			Sink		Area (SF)	347	EFA	49
AreaSF/TLA	1,260 / 1,607	Exterior Walls	Vinyl			Shower Stall/Tub		Condition	Normal	EFF Year	1960
GLA 1st/2nd	1,607 / 0	Roof	Asph / Gable			Mtl St Sh Bath		Bsmt (SF)		Condition	V Good
Condition	V Good	Interior Finish	Drwl / Panel			Mtl Stall Shower		NoBsmt Flr(SF)		Bsmt (SF)	
Basement	None	Flooring	Carp			No Bathroom		Heat	Elec - Basebd	Qtrs Over	None
No Bsmt Flr.	0	Non-base Heating		Fireplace		Wet Bar		AC	No	Qtrs Over (SF)	
Heat	Elec - Basebd	Floor/Wall #	0	Masonry, 1 Sty	1	Whirlpool Bathroom		Attic (SF)		Qtrs AC (SF)	
AC	No	Pipeless #	0			Whirlpool Tub					
Attic	None	Hand Fired (Y/N)	No			No Hot Water Tank					
		Space Heat #	0			No Plumbing					
		Appliances				Sewer & Water Only					
		Range Unit	Built-In Vacuums			Water Only w/Sink					
		Oven - Single	Intercom System			Hot Tub					
		Oven - Double	BI Stereo			Bidet					
		Dishwasher				FbglS Service Sink					
		Microwave				Urinal					
		Trash Compactor				Sauna					
		Jennair				W'Pool Bath w/Shower					
		Security System				Water Only					
						No Tub/Shower					



Bldg / Addn	Description	Units	Year
	101 — Single-Family / Owner Occupied		
	1 Story Frame	1,260	
	Adjustment for basement - None		
	Base Heat: Elec - Basebd		
	Deck #1: Concrete Patio-Low	108 SF	
	Deck #2: Wood Deck-Med	495 SF	
#1	Fireplace: Masonry, 1 Story	1	
	Garage: Att Frame	547 SF	1960
	Garage: Carport Att Frame/Asph	357 SF	1960
Adtn	1 Story Frame	347 SF	1998

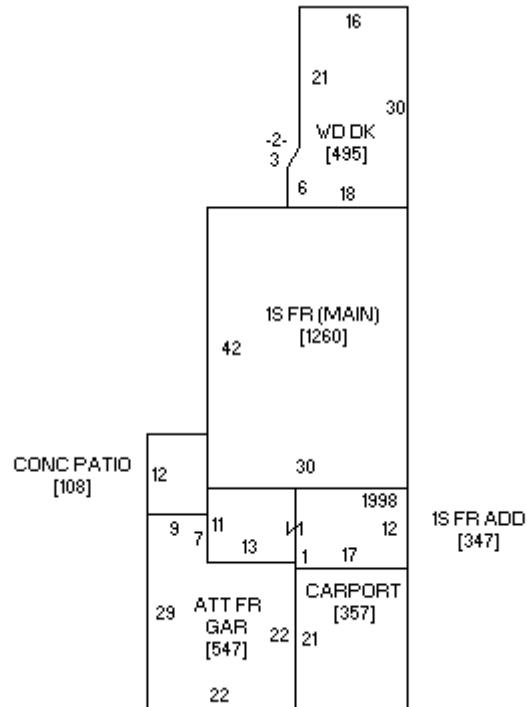

Sketch 1 of 1

