

LEGAL DESCRIPTION:

CLASS:

28-01 R RESIDENTIAL
 SL HAYES S-W S SD
 SCHALLERS S/D
 GOV LOTS 3 & 4
 SEC 15-90-37

-----		CSR'S	.00	-----	
				CODE	VALUE ACRES
GROSS	CURRENT				
ROADS	LAND	273,970			
D.D.	BLDG				
R.R.	DWLG	110,750(1)			
MISC					
	TOTAL	384,720			
NET					

=====		=====		=====	
		YEAR	2016		
	LAND	273,970			
	BLDG				
	DWLG	110,750(1)			
	TOTAL	384,720			
	NET TX				

DEED HOLDER:

DATE REFER

CONTRACT HOLDER:

DATE REFER

GODBERSEN MICHELLE
 267 SOUTH SHORE
 STORM LAKE IA 50588

05042016 6

-----		YEAR	2015	-----	
	LAND	273,970			
	BLDG				
	DWLG	110,750(1)			
	TOTAL	384,720			
	NET TX				

MANASOTA KEY LLC

11202013 5

P O BOX 336
 STORM LAKE IA 50588-0336

-----		YEAR	2014	-----	
	LAND	263,430			
	BLDG				
	DWLG	106,490(1)			
	TOTAL	369,920			
	NET TX				

SNOW RIDGE LLC

02162011 4

P O BOX 336
 STORM LAKE IA 50588-0336

-----		YEAR	2013	-----	
	LAND	263,430			
	BLDG				
	DWLG	106,490(1)			
	TOTAL	369,920			
	NET TX				

DVERGSTEN DAVID

3

EICHNER KAREN
 267 SOUTH SHORE
 STORM LAKE IA 50588

-----		YEAR	2012	-----	
	LAND	263,430			
	BLDG				
	DWLG	106,490(1)			
	TOTAL	369,920			
	NET TX				

REMARKS:

3 CHG TITLE #093957 12-18-09
 4 W.D. #110217-18 01-31-11 \$350,000
 5 W.D. #133476 08-27-13
 6 W.D. #160708 03-27-16 \$377,500

-----		YEAR	2011	-----	
	LAND	263,430			
	BLDG				
	DWLG	106,490(1)			
	TOTAL	369,920			
	NET TX				

267 SOUTH SHORE DR, STORM LAKE

Deed: GODBERSEN MICHELLE

Map Area: HAYES-RES(SCHALLERS)

Checks/Tags:

Contract:

Route: 915-002-480

Lister/Date: LF, 06/17/2008

CID#: 0955900

Tax Dist: SL HAYES S-W S SD

Review/Date: TG, 12/02/2008

DBA:

Plat Page: -

Entry Status: Estimated

RURAL/RESIDENTIAL

MLS: 18108

Subdiv: [NONE]

Legal: 28-01 SL HAYES S-W S SD SCHALLERS S/D GOV LOTS 3 & 4 SEC 15-90-37

Land										
Land Basis	Front	Rear	Side 1	Side 2	R. Lot	SF	Acres			
FF Main	185.00	88.00	227.00	227.00	0.00					
Sub Total						30,985.50	0.711			
Grand Total						30,985.50	0.711			

Sales				Building Permits				Values			
Date	\$ Amount	NUTC	Recording	Date	Number	Tag	\$ Amount	Reason			
03/27/2016	\$377,500	D0	160708								
08/27/2013	\$0	D7	133476								
01/31/2011	\$350,000	D0	110217								
12/18/2009	\$0	D14	093957								

Res. Structure		Finish				Plumbing		Addition		Garage	
Occ. Code	101	Ttl Rooms Above #	5	Bedrooms Above #	3	Full Bath	1	Addition	1 of 1	Garage	1 of 1
Occ. Descr.	Single-Family / Owner Occupied	Ttl Rooms Below #	1	Bedrooms Below #	0	Shower Stall Bath	1	Year Built	1954	Style	Att Frm
Year Built	1954	Bsmt Fin Area #1	400	Table		Toilet Room		EFA	55	W X L	0' X 0'
EFA / EFYr	55 / 1954	Bsmt Fin Area #2				Lavatory		EFA Year	1954	Area (SF)	504
Arch. Dsgn	N/A	Bsmt Fin Area #3				Water Closet		Style	1 Sty Frm	Year Built	1954
Style	1 Story Frame	Foundation	C Bk			Sink		Area (SF)	336	EFA	55
AreaSF/TLA	1,318 / 1,654	Exterior Walls	Wd Lap			Shower Stall/Tub		Condition	Normal	EFF Year	1954
GLA 1st/2nd	1,654 / 0	Roof	Asph / Gable			Mtl St Sh Bath		Bsmt (SF)	336	Condition	NML
		Interior Finish	PLASTER/HARDWOOD			Mtl Stall Shower		NoBsmt Flr(SF)		Bsmt (SF)	
		Flooring	Hdwd			No Bathroom		Heat	FHA - Gas	Qtrs Over	None
		Non-base Heating		Fireplace		Wet Bar		AC	Yes	Qtrs Over (SF)	
		Floor/Wall #	0	Masonry w/1 Extra, 1 Sty	1	Whirlpool Bathroom		Attic (SF)		Qtrs AC (SF)	
		Pipeless #	0			Whirlpool Tub					
		Hand Fired (Y/N)	No			No Hot Water Tank					
Condition	NML	Space Heat #	0			No Plumbing				Door Opnrs	
		Appliances				Sewer & Water Only				Bsmt Stalls	
Basement	Full	Range Unit	Built-In Vacuums			Water Only w/Sink					
No Bsmt Flr.	0	Oven - Single	Intercom System			Hot Tub					
Heat	FHA - Gas	Oven - Double	BI Stereo			Bidet					
AC	Yes	Dishwasher				FbglS Service Sink					
Attic	None	Microwave				Urinal					
		Trash Compactor				Sauna					
		Jennair				W'Pool Bath w/Shower					
		Security System				Water Only					
						No Tub/Shower					



Bldg / Addn	Description	Units	Year
	101 — Single-Family / Owner Occupied		
	1 Story Frame	1,318	
#1	Bsmt Fin - Rec. Room W/ Walk-out (Avg)	400 Tbl	
	Base Heat: FHA - Gas		
	Add Central Air	1,318	
	Deck #1: Wood Deck-Med	112 SF	
	Deck #2: Wood Deck-Med	82 SF	
	Deck #3: Concrete Patio-Med	437 SF	
	Deck #4: Concrete Patio-Low	160 SF	
	Plumbing	2	
#1	Fireplace: Masonry w/1 Extra, 1 Story	1	
	Garage: Att Frame	504 SF	1954
Adtn	1 Story Frame	336 SF	1954
	Basement area	336 SF	

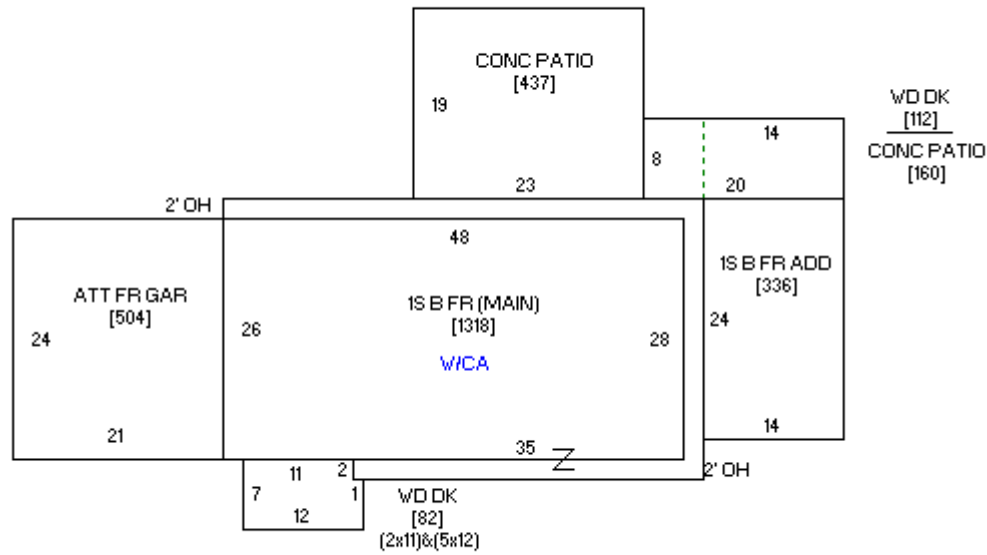



Photo 1 of 2, 06/26/2008



Photo 2 of 2, 05/01/1998