

LEGAL DESCRIPTION:

CLASS:

14-01 R RESIDENTIAL
SL HAYES S-W S SD
STONEY POINT BEACH

-----		CSR'S	.00	-----	
				CODE	VALUE ACRES
GROSS	CURRENT				
ROADS	LAND	240,450			
D.D.	BLDG				
R.R.	DWLG	292,000(1)			
MISC					
	TOTAL	532,450			
NET					

=====		=====		=====	
	YEAR	2016			
	LAND	240,450			
	BLDG				
	DWLG	292,000(1)			
	TOTAL	532,450			
	NET TX				

DEED HOLDER:

DATE REFER

CONTRACT HOLDER:

DATE REFER

YEAR 2015

GOETTSCHE ANDREW T

06142016 3

201 STONEY POINT

STORM LAKE IA 50588

LAND	240,450
BLDG	
DWLG	292,000(1)
TOTAL	532,450
NET TX	

IVEY TROY DONOVAN

05161994 2

IVEY GRACE CATHERINE

201 STONEY POINT DR

STORM LAKE IA 50588

YEAR	2014
LAND	231,200
BLDG	
DWLG	280,770(1)
TOTAL	511,970
NET TX	

ALTMAN BRETT A

1

9037 92ND AVE

STORM LAKE IA

YEAR	2013
LAND	231,200
BLDG	
DWLG	280,770(1)
TOTAL	511,970
NET TX	

REMARKS:

1 WD 58/409 04-17-92 \$132,000 (D000)

2 WD 60/165 03-20-84 \$164,300 (D000)

3 W.D. #161387 05-20-16 \$575,000

YEAR	2012
LAND	231,200
BLDG	
DWLG	280,770(1)
TOTAL	511,970
NET TX	

YEAR	2011
LAND	231,200
BLDG	
DWLG	280,770(1)
TOTAL	511,970
NET TX	

201 STONEY POINT DR, STORM LAKE

Deed: GOETTSCH ANDREW T

Map Area: HAYES-RES(STONEY PT)

Checks/Tags:

Contract:

Route: 915-002-240

Lister/Date: TG, 06/12/2008

CID#: 0959500

Tax Dist: SL HAYES S-W S SD

Review/Date: TG, 12/01/2008

DBA:

Plat Page: -

Entry Status: Inspected

MLS:

Subdiv: [NONE]

RURAL/RESIDENTIAL

Legal: 14-01 SL HAYES S-W S SD STONEY POINT BEACH

Land										
Land Basis	Front	Rear	Side 1	Side 2	R. Lot	SF	Acres	Depth	EFF	Qual./Land
FF Main	147.20	125.00	156.00	156.00	0.00			1.05	146.79	R-1750
Sub Total						21,231.60	0.487			
Grand Total						21,231.60	0.487			

Street	Utilities	Zoning	Land Use
FF Main Paved	City	Not Applicable	Not Applicable

Sales				Building Permits				Values			
Date	\$ Amount	NUTC	Recording	Date	Number	Tag	\$ Amount	Reason			
05/20/2016	\$575,000	D0	161387	5/11/1998	209798	N	\$70,000	Addition			
04/20/1994	\$164,300	D0	060-165								
04/17/1992	\$132,000	D0	058-409								
08/01/1985	\$38,000	D0									

Res. Structure	Finish	Plumbing	Addition	Garage
Occ. Code 101	Ttl Rooms Above # 6	Bedrooms Above # 2	Full Bath 1	Garage 1 of 1
Occ. Descr. Single-Family / Owner Occupied	Ttl Rooms Below # 4	Bedrooms Below # 2	Shower Stall Bath 1	Style Att Frm
Year Built 1986	Bsmt Fin Area #1 1600	Table	Toilet Room	W X L 0' X 0'
EFA / EFYr 23 / 1986	Bsmt Fin Area #2		Lavatory	Area (SF) 912
Arch. Dsgn N/A	Bsmt Fin Area #3		Water Closet	Year Built 1994
Style 1 Story Frame	Foundation C Bk	Sink 1	Sink 1	EFA 15
AreaSF/TLA 1,352 / 2,638	Exterior Walls Vinyl	Shower Stall/Tub 1	Shower Stall/Tub 1	EFF Year 1994
GLA 1st/2nd 2,638 / 0	Roof Asph / Hip	Mtl St Sh Bath	Mtl St Sh Bath	Condition Above Normal
	Interior Finish Drwl	Mtl Stall Shower	Mtl Stall Shower	Bsmt (SF)
	Flooring Carp / Hwd	No Bathroom	No Bathroom	NoBsmt Flr(SF)
	Non-base Heating	Wet Bar	Wet Bar	Heat FHA - Gas
	Fireplace	Whirlpool Bathroom 1	Whirlpool Bathroom 1	AC Yes
	Floor/Wall # 0	Prefab, 1 Sty 1	Whirlpool Tub	Attic (SF)
	Pipeless # 0	Gas/Elec-Side, 1 Sty 1	No Hot Water Tank	See other pages for more additions.
	Hand Fired (Y/N) No	Gas-Vertical, 1 Sty 1	No Plumbing	Door Opnrs
Condition A NML	Space Heat # 0		Sewer & Water Only	Bsmt Stalls
	Appliances		Water Only w/Sink	
Basement Full	Range Unit	Built-In Vacuums	Hot Tub	
No Bsmt Flr. 0	Oven - Single	Intercom System	Bidet	
Heat FHA - Gas	Oven - Double	BI Stereo	FbglS Service Sink	
AC Yes	Dishwasher		Urinal	
Attic None	Microwave		Sauna	
	Trash Compactor		W'Pool Bath w/Shower	
	Jennair		Water Only	
	Security System		No Tub/Shower	



Bldg / Addn	Description	Units	Year
	101 — Single-Family / Owner Occupied		
	1 Story Frame	1,352	
#1	Bsmt Fin - Living Qtrs. W/ Walk-out (Avg)	1,600 Tbl	
	Base Heat: FHA - Gas		
	Add Central Air	1,352	
#1	Porch: 1S Frame Open	96 SF	
	Deck #1: Wood Deck-Low	338 SF	
	Deck #2: Brick/Blk Patio-Med	170 SF	
	Deck #3: Concrete Patio-Med	160 SF	
	Plumbing	5	
#1	Fireplace: Prefab, 1 Story	1	
#2	Fireplace: Gas/Elec-Side, 1 Story	1	
#3	Fireplace: Gas-Vertical, 1 Story	1	
	Garage: Att Frame	912 SF	1994
1 of 2 Adtn	1 Story Frame	676 SF	1986
2 of 2 Adtn	1 Story Frame	610 SF	1998
	Basement area	610 SF	

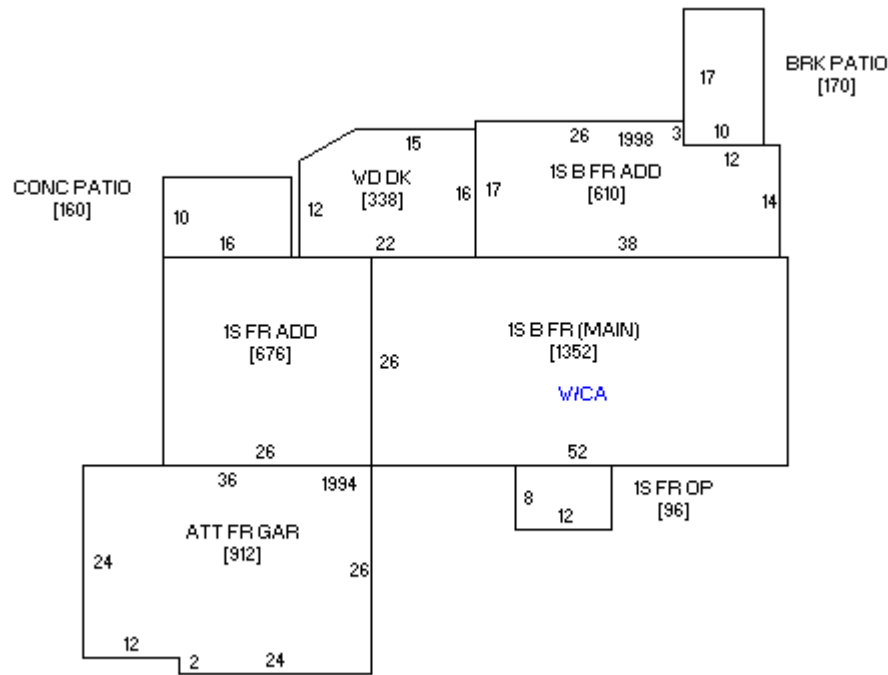



Photo 1 of 2 12/01/2008



Photo 2 of 2 05/11/2001