

Pin: 03-06-452-006
Sale Date: 06/16/16
Sale Price: \$14,400
Classification: Rural
Residential

03-06-452-006

R-Res

#9002.00

217 Northwestern



NOV 13 2001



Buena Vista County

Assessor
 P.O. Box 148
 215 E. 5th
 Storm Lake, Iowa 50588
 (712) 749-2543

WITHERS JERRY L
 217 NORTHWESTERN
 SIOUX RAPIDS, IA 50585

**Assessor's Parcel Information Report
 For Parcel Number 0306452006**

Assessment Year: 2016
Situs Address: 217 NORTHWESTERN SIOUX RAPIDS
Alternate Parcel Number: 0000900200
Last Deeded: Date: 8/12/2016, Book: 16, Page: 2198, Instrument: 162198
Last Contract:
Legal: 06-93-36
 S.R.-REMB. LEE
 S/D S 1/2 SE
 ALL LOT 5

Type	Owner	Percentage
Deed	WITHERS JERRY L	

	Valuations				Total	Counts					
	Land	Bldg	Dwlg			Acres	Unit	Bldg	Dwlg	Adj. CSR	Unadj. CSR
Tax District: 00470 - S.R.-REMB. LEE Property Class: Residential											
Full:	6,970	0	31,910		38,880	0.870	0.000	0	1	0.00	0.00
Exemptions:	0	0	0		0	0.000	0.000	0	0	0.00	0.00
Assessed:	6,970	0	31,910		38,880	0.870	0.000	0	1	0.00	0.00

217 NORTHWESTERN, SIOUX RAPIDS

Deed: WITHERS JERRY L

Map Area: LEE-RES

Checks/Tags: S

Contract:

Route: 903-001-280

Lister/Date: JH, 09/23/2008

CID#: 0900200

Tax Dist: SR-R LEE

Review/Date: DS, 10/29/2008

DBA:

Plat Page: -

Entry Status: Inspected

RURAL/RESIDENTIAL

MLS:

Subdiv: [NONE]

Legal: 06-93-36 S.R.-REMB. LEE S/D S 1/2 SE ALL LOT 5

Land										
Land Basis	Front	Rear	Side 1	Side 2	R. Lot	SF	Acres	Depth	EFF	Qual./Land
FF Main	165.00	165.00	231.00	231.00	0.00			1.16	191.40	R-50
Sub Total						38,115.00	0.875			
Grand Total						38,115.00	0.875			

Street	Utilities	Zoning	Land Use
FF Main Gravel	City	Not Applicable	Not Applicable

Sales				Building Permits				Values				
Date	\$ Amount	NUTC	Recording	Date	Number	Tag	\$ Amount	Reason				
06/16/2016	\$14,400	D0	162198	11/13/2013	OFFICE	N	\$0	Ext-Remodel				
08/01/1983	\$31,500	D0										

Res. Structure	Finish	Plumbing	Addition	Garage
Occ. Code 101	Ttl Rooms Above # 6	Bedrooms Above # 4	Addition 1 of 1	Garage 1 of 1
Occ. Descr. Single-Family / Owner Occupied	Ttl Rooms Below # 0	Bedrooms Below # 0	Year Built 1920	Style Det Frm
Year Built 1920	Bsmt Fin Area #1	Full Bath 1	EFA 89	W X L 0' X 0'
EFA / EFYr 89 / 1920	Bsmt Fin Area #2	Shower Stall Bath	EFA Year 1920	Area (SF) 528
Arch. Dsgn N/A	Bsmt Fin Area #3	Toilet Room	Style 1 Sty Frm	Year Built 1977
Style 1 Story Frame	Foundation Conc	Lavatory	Area (SF) 24	EFA 32
AreaSF/TLA 971 / 1,529	Exterior Walls Wd Lap	Water Closet	Condition Poor	EFF Year 1977
GLA 1st/2nd 995 / 534	Roof Asph / Gable	Sink	Bsmt (SF) 24	Condition Poor
	Interior Finish Plas / Panel	Shower Stall/Tub	NoBsmt Flr(SF)	Bsmt (SF)
	Flooring Carp / Tile / Hdwd	Mtl St Sh Bath 1	Heat Elec - Basebd	Qtrs Over None
	Non-base Heating	Mtl Stall Shower	AC No	Qtrs Over (SF)
	Fireplace	No Bathroom	Attic (SF)	Qtrs AC (SF)
	Floor/Wall # 0	Wet Bar		Door Opnrs
	Pipeless # 0	Whirlpool Bathroom		Bsmt Stalls
	Hand Fired (Y/N) No	Whirlpool Tub		
	Space Heat # 0	No Hot Water Tank		
		No Plumbing		
	Appliances	Sewer & Water Only		
	Range Unit	Water Only w/Sink		
Basement Full	Oven - Single	Hot Tub		
No Bsmt Flr. 0	Oven - Double	Bidet		
Heat Elec - Basebd	Dishwasher	Fbgls Service Sink		
AC No	Microwave	Urinal		
Attic Fully Finished 534SF	Trash Compactor	Sauna		
	Jennair	W'Pool Bath w/Shower		
	Security System	Water Only		
		No Tub/Shower		



Bldg / Addn	Description	Units	Year			
	101 — Single-Family / Owner Occupied					
	1 Story Frame	971				
	Base Heat: Elec - Basebd					
	Add Fully Finished attic	534				
#1	Porch: 1S Frame Enclosed	288 SF				
	Plumbing	2				
Adtn	1 Story Frame	24 SF	1920			
	Basement area	24 SF				
	Garage: Det Frame 0' X 0'	528 SF	1977			

P:1	Yrd	Description	Units	Cond	Year
		1 — ATT SHED TO GARAGE		NML	2001

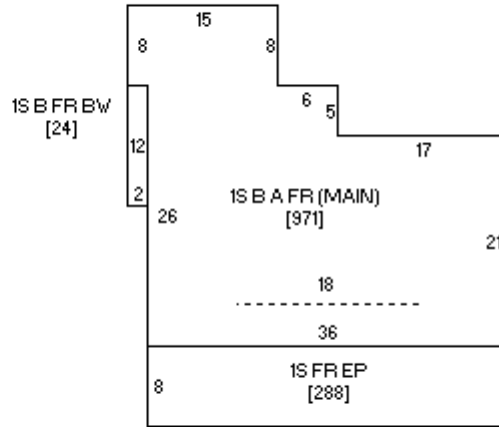
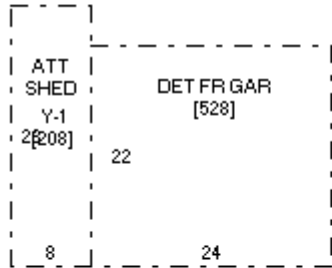

Sketch 1 of 1

