

Pin: 03-29-100-006
Sale Date: 12/29/16
Sale Price: \$102,000
Acres: 5.34 Net
Classification: Change in Use
from Ag to Rural Residential

03-29-100-006

#9135.50

R-Res

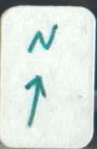

Res. Structure		Finish				Plumbing		Addition		Garage	
Occ. Code	101	Ttl Rooms Above #	8	Bedrooms Above #	4	Full Bath	1	Addition	1 of 1	Garage	No garages
Occ. Descr.	Single-Family / Owner Occupied	Ttl Rooms Below #	0	Bedrooms Below #	0	Shower Stall Bath		Year Built	1900	Style	
Year Built	1900					Toilet Room		EFA	109	WXL	
EFA / EFYr	109 / 1900					Lavatory		EFA Year	1900	Area (SF)	
Arch. Dsgn	N/A	Foundation	C Blk			Water Closet	1	Style	1 Sty Frm	Year Built	
Style	2 Story Frame	Exterior Walls	Vinyl			Sink		Area (SF)	280	EFA	
AreaSF/TLA	840 / 1,960	Roof	Asph / Hip			Shower Stall/Tub		Condition	Normal	EFF Year	
GLA 1st/2nd	1,120 / 840	Interior Finish	Plas			Mtl St Sh Bath		Bsmt (SF)		Condition	
		Flooring	Carp / Vinyl			Mtl Stall Shower		NoBsmt Flr(SF)		Bsmt (SF)	
		Non-base Heating		Fireplace		No Bathroom		Heat	FHA - Gas	Qtrs Over	
		Floor/Wall #	0			Wet Bar		AC	Yes	Qtrs Over (SF)	
		Pipeless #	0			Whirlpool Bathroom		Attic (SF)		Qtrs AC (SF)	
		Hand Fired (Y/N)	No			Whirlpool Tub				Door Opnrs	
Condition	NML	Space Heat #	0			No Hot Water Tank				Stalls- Bsmt / Std	
						No Plumbing					
		Appliances				Sewer & Water Only					
Basement	Full	Range Unit	Built-In Vacuums			Water Only w/Sink					
No Bsmt Flr.	0	Oven - Single	Intercom System			Hot Tub					
Heat	FHA - Gas	Oven - Double	BI Stereo			Bidet					
AC	Yes	Dishwasher				FbglS Service Sink					
Attic	None	Microwave				Urinal					
		Trash Compactor				Sauna					
		Jennair				W'Pool Bath w/Shower					
		Security System				Water Only					
						No Tub/Shower					



Bldg / Addn	Description	Units	Year				
	101 – Single-Family / Owner Occupied						
	2 Story Frame	840					
	Base Heat: FHA - Gas						
	Add Central Air	840					
	Deck #1: Bsmt Entry-Low	32 SF					
	Plumbing	2					
Adtn	1 Story Frame	280 SF	1900				

	Count	Ag Building Description	Units	Year						
1 of 12 P:1	1	STORAGE CHIEF 904-Bin - Stl. Grain Storage 27' X 19' X 19'	9,485 Bu	1978						
2 of 12 P:2	1	OHC 921-Confinement - Deluxe Oper 16' X 40'	640 SF	1984						
3 of 12 P:3	1	HOG HSE FR @ .90 927-Shed 20' X 50'	1,000 SF	1900						
4 of 12 P:4	1	SHED FR @ .90 943-Lean-To 12' X 20' X 20'	1,818 Bu	1900						
5 of 12 P:5	1	ELEV. OHB L FR @ .90 926-Crib 27' X 32'	864 SF	1900						
6 of 12 P:6	1	L FR @ .90 906-Barn - Flat 20' X 42'	840 SF	1900						
7 of 12 P:7	1	SHED FR @ .90 908-Lean-To 8' X 42'	336 SF	1900						
8 of 12 P:8	1	SHED L FR @ .90 908-Lean-To 12' X 52'	624 SF	1900						
9 of 12 P:9	1	SHED FR @ .90 908-Lean-To 8' X 42'	336 SF	1900						
10 of 12 P:10	1	STORAGE @ SV 904-Bin - Stl. Grain Storage 14' X 8' X 8'	1,044 Bu	1900						
11 of 12 P:12	1	MACH P FR @ .40 927-Shed 23' X 48'	1,104 SF	1900						
12 of 12 P:13	1	MTL POLE 925-Steel Utility Bldg 24' X 30'	720 SF	1973						

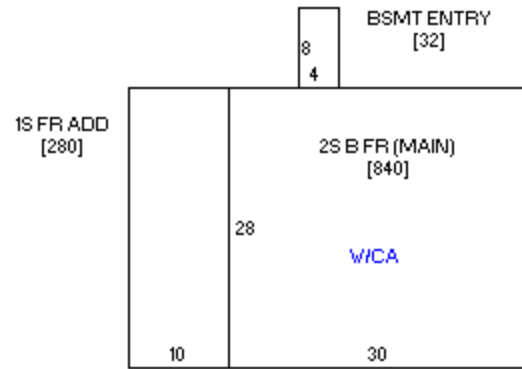

Sketch 1 of 1



Photo 1 of 1 09/29/2008