

Pin: 09-21-400-014  
Sale Date: 06/24/16  
Sale Price: \$245,000  
Acres: 3.93 Net  
Classification: Rural Residential

09-21-400-014

R-Res

#10972.50



~~NOV~~ 1 2001



LOCATION: 393 HWY 7

DISTRICT: 00240 REF #:

PARCEL #: 09-21-400-014

ALT ID: 0001097250

LEGAL DESCRIPTION:

CLASS:

21-91-38  
ALTA NOKOMIS  
PT S 1/2 SE 1/4  
LYING N OF HWY  
(EX LOT A)

R RESIDENTIAL

		CSR'S	.00		
				CODE	VALUE ACRES
GROSS		CURRENT			
ROADS		LAND	27,560		
D.D.		BLDG			
R.R.		DWLG	193,690 ( 1)		
MISC					
		TOTAL	221,250		
NET	3.93				

YEAR 2016	
LAND	27,560
BLDG	
DWLG	193,690 ( 1)
TOTAL	221,250
NET TX	

DEED HOLDER:                      DATE REFER

FLINK TRAVIS W                      07062016 3

FLINK VICKI M

393 HWY 7

ALTA IA 51002

CONTRACT HOLDER:                      DATE REFER

YEAR 2015	
LAND	27,560
BLDG	
DWLG	193,690 ( 1)
TOTAL	221,250
NET TX	

DEHNER MICHAEL A                      12142011 2

DEHNER ELLEN R

393 HWY 7

ALTA IA 51002

YEAR 2014	
LAND	26,500
BLDG	
DWLG	186,240 ( 1)
TOTAL	212,740
NET TX	

POTRATZ ROGER W

POTRATZ BRENDA R

393 HWY 7

ALTA IA 51002

YEAR 2013	
LAND	26,500
BLDG	
DWLG	186,240 ( 1)
TOTAL	212,740
NET TX	

REMARKS:

2 W.D. #113017 10-31-11 \$215,000  
3 W.D. #161716 06-24-16 \$245,000

YEAR 2012	
LAND	26,500
BLDG	
DWLG	186,240 ( 1)
TOTAL	212,740
NET TX	

YEAR 2011	
LAND	26,500
BLDG	
DWLG	186,240 ( 1)
TOTAL	212,740
NET TX	



Res. Structure		Finish				Plumbing		Addition		Garage	
Occ. Code	101	Ttl Rooms Above #	6	Bedrooms Above #	3	Full Bath	2	Addition	No Additions	Garage	1 of 1
Occ. Descr.	Single-Family / Owner Occupied	Ttl Rooms Below #	3	Bedrooms Below #	1	Shower Stall Bath	1	Year Built		Style	Att Frm
Year Built	2000	Bsmt Fin Area #1	1550	Table		Toilet Room		EFA		W X L	0' X 0'
EFA / EFYr	9 / 2000	Bsmt Fin Area #2				Lavatory	1	EFA Year		Area (SF)	1,268
Arch. Dsgn	N/A	Bsmt Fin Area #3				Water Closet		Style		Year Built	2000
Style	1 Story Frame	Foundation	Conc			Sink		Area (SF)		EFA	9
AreaSF/TLA	1,568 / 1,568	Exterior Walls	Vinyl			Shower Stall/Tub		Condition		EFF Year	2000
GLA 1st/2nd	1,568 / 0	Roof	Asph / Gable			Mtl St Sh Bath				Condition	NML
Condition	NML	Interior Finish	Drwl			Mtl Stall Shower		Bsmt (SF)		Bsmt (SF)	
Basement	Full	Flooring	Carp / Vinyl			No Bathroom		NoBsmt Flr(SF)		Qtrs Over	None
No Bsmt Flr.	0	<b>Non-base Heating</b>		<b>Fireplace</b>		Wet Bar		Heat		Qtrs Over (SF)	
Heat	FHA - Gas	Floor/Wall #	0			Whirlpool Bathroom		AC		Qtrs AC (SF)	
AC	Yes	Pipeless #	0			Whirlpool Tub		Attic (SF)		Door Opnrs	
Attic	None	Hand Fired (Y/N)	No			No Hot Water Tank				Bsmt Stalls	
		Space Heat #	0			No Plumbing					
		<b>Appliances</b>				Sewer & Water Only					
		Range Unit	Built-In Vacuums			Water Only w/Sink					
		Oven - Single	Intercom System			Hot Tub					
		Oven - Double	Bl Stereo			Bidet					
		Dishwasher				Fbgls Service Sink					
		Microwave				Urinal					
		Trash Compactor				Sauna					
		Jennair				W'Pool Bath w/Shower					
		Security System				Water Only					
						No Tub/Shower					



Copyright © 1995-2015  
Vanguard Appraisals, Inc.

Bldg / Addn	Description	Units	Year			
	101 — Single-Family / Owner Occupied					
	1 Story Frame	1,568				
#1	Bsmt Fin - Living Qtrs. (Multi) (Avg)	1,550 Tbl				
	Base Heat: FHA - Gas					
	Add Central Air	1,568				
#1	Porch: Frame 3 Seasons	180 SF				
	Deck #1: Concrete Patio-Med	112 SF				
	Deck #2: Wood Deck-Med	352 SF				
	Plumbing	4				
	Garage: Att Frame	1,268 SF	2000			

P:1	Yrd	Description	Units	Cond	Year
		1 — Shed		NML	2002

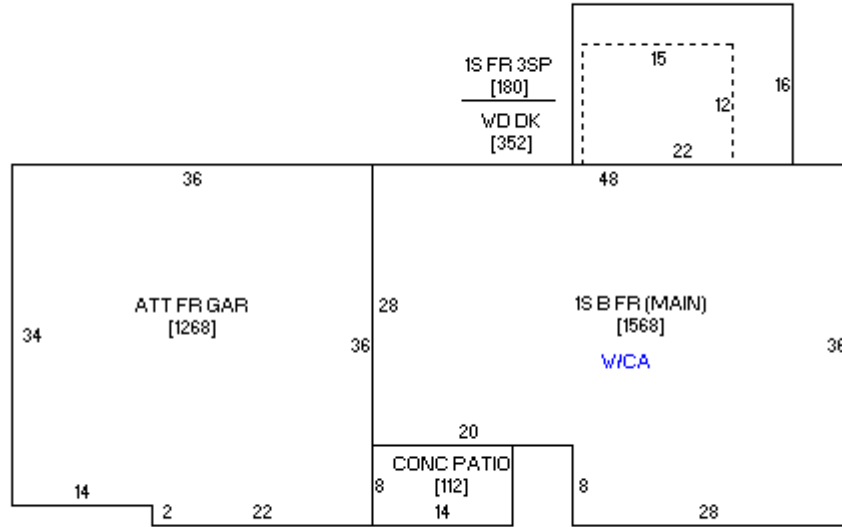
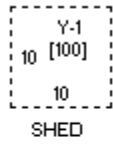

Sketch 1 of 1

