

09-34-200-00



#11076.0

Photo 1 of 2

Pin: 09-34-200-004

Sale Date: 07/01/16

Sale Price: \$210,000

Acres: 3.04 Net

Classification:

Change in Use from Ag to Rural Residential

4

See Photo 2

2

1

A

M



Buena Vista County

Assessor
 P.O. Box 148
 215 E. 5th
 Storm Lake, Iowa 50588
 (712) 749-2543

DIISCHER COREY A
 5903 50TH AVE
 ALTA, IA 51002

**Assessor's Parcel Information Report
 For Parcel Number 0934200004**

Assessment Year: 2016
 Situs Address: 5903 50TH AVE ALTA
 Deeded Acres: 3.750
 Alternate Parcel Number: 0001107600

	Date	Book	Page	Instrument
Last Deeded:	7/20/2016	16	2001	162001
Last Contract:				
Legal:	34-91-38 ALTA NOKOMIS PT NE NE			

Type	Owner	Percentage
Deed	DIISCHER COREY A	JT
	DIISCHER HOLLY M	JT

	Valuations				Counts						
	Land	Bldg	Dwlg	Total	Acres	Unit	Bldg	Dwlg	Adj. CSR	Unadj. CSR	

Tax District: 00240 - ALTA NOKOMIS		Property Class: Agriculture										
Full:	7,020	23,830	0	30,850	3.750	0.000	3	0	216.00	0.00		
Exemptions:	0	0	0	0	0.710	0.000	0	0	0.00	0.00		
Assessed:	7,020	23,830	0	30,850	3.040	0.000	3	0	216.00	0.00		

Exemptions	Type	Value	Acres	Credits	Type	Value
ROAD	ROAD RIGHT OF WAY	0	0.710		AGLAND	3,237

Tax District: 00240 - ALTA NOKOMIS		Property Class: Ag Dwelling										
Full:	0	0	153,050	153,050	0.000	0.000	0	1	0.00	0.00		
Exemptions:	0	0	0	0	0.000	0.000	0	0	0.00	0.00		
Assessed:	0	0	153,050	153,050	0.000	0.000	0	1	0.00	0.00		

Totals for Parcel Number 0934200004											
	Land	Bldg	Dwlg	Total	Acres	Unit	Bldg	Dwlg	Adj. CSR	Unadj. CSR	
Full:	7,020	23,830	153,050	183,900	3.750	0.000	3	1	216.00	0.00	
Assessed:	7,020	23,830	153,050	183,900	3.040	0.000	3	1	216.00	0.00	

Res. Structure		Finish				Plumbing		Addition		Garage	
Occ. Code	101	Ttl Rooms Above #	7	Bedrooms Above #	2	Full Bath	1	Addition	No Additions	Garage	1 of 1
Occ. Descr.	Single-Family / Owner Occupied	Ttl Rooms Below #	5	Bedrooms Below #	3	Shower Stall Bath		Year Built		Style	Att Frm
Year Built	1974	Bsmt Fin Area #1	1150	Table		Toilet Room	2	EFA		W X L	0' X 0'
EFA / EFYr	35 / 1974	Bsmt Fin Area #2				Lavatory		EFA Year		Area (SF)	711
Arch. Dsgn	N/A	Bsmt Fin Area #3				Water Closet		Style		Year Built	1974
Style	1 Story Frame	Foundation	C Blk			Sink		Area (SF)		EFA	35
AreaSF/TLA	1,430 / 1,788	Exterior Walls	Brk			Shower Stall/Tub		Condition		EFF Year	1974
GLA 1st/2nd	1,430 / 358	Roof	Other			Mtl St Sh Bath				Condition	NML
Condition	NML	Interior Finish	Drwl / Panel			Mtl Stall Shower		Bsmt (SF)		Bsmt (SF)	
Basement	Full	Flooring	Carp / Ceramic			No Bathroom		NoBsmt Flr(SF)		Qtrs Over	None
No Bsmt Flr.	0	Non-base Heating		Fireplace		Wet Bar		Heat		Qtrs Over (SF)	
Heat	Elec - Basebd	Floor/Wall #	0	Masonry w/1 Extra, 1 Sty	1	Whirlpool Bathroom		AC		Qtrs AC (SF)	
AC	No	Pipeless #	0	Prefab, 1 Sty	1	Whirlpool Tub		Attic (SF)		Door Opnrs	
Attic	1/4 Finished 358SF	Hand Fired (Y/N)	No			No Hot Water Tank				Bsmt Stalls	
		Space Heat #	0			No Plumbing					
		Appliances				Sewer & Water Only					
		Range Unit	1	Built-In Vacuums		Water Only w/Sink					
		Oven - Single	1	Intercom System		Hot Tub					
		Oven - Double		Bl Stereo		Bidet					
		Dishwasher	1			Fbgls Service Sink					
		Microwave				Urinal					
		Trash Compactor				Sauna					
		Jennair				W'Pool Bath w/Shower					
		Security System				Water Only					
						No Tub/Shower					



Copyright © 1995-2015
Vanguard Appraisals, Inc.

Bldg / Addn	Description	Units	Year
	101 — Single-Family / Owner Occupied		
	1 Story Frame	1,430	
#1	Bsmt Fin - Living Qtrs. (Multi) (Avg)	1,150 Tbl	
	Base Heat: Elec - Basebd		
	Add 1/4 Finished attic	358	
#1	Porch: 1S Frame Open	96 SF	
#2	Porch: 1S Frame Open	384 SF	
#3	Porch: 1S Frame Open	10 SF	
	Veneer #1 1/2 Story Stone	24.0 LF	
	Veneer #2 1 Story Stone	96.0 LF	
	Plumbing	3	
	B.I. Appliances	3	
#1	Fireplace: Masonry w/1 Extra, 1 Story	1	
#2	Fireplace: Prefab, 1 Story	1	
	Garage: Att Frame	711 SF	1974

	Count	Ag Building Description	Units	Year						
1 of 3 P:1	1	MTL POLE FR 925-Steel Utility Bldg	36' X 54'	1,944 SF	1973					
2 of 3 P:2	1	MTL POLE FR 925-Steel Utility Bldg	44' X 70'	3,080 SF	1977					
3 of 3 P:4	1	MTL P FR 925-Steel Utility Bldg	60' X 81'	4,860 SF	2012					

Description	Units	Cond	Year
Yrd 1 - Shed		NML	1990

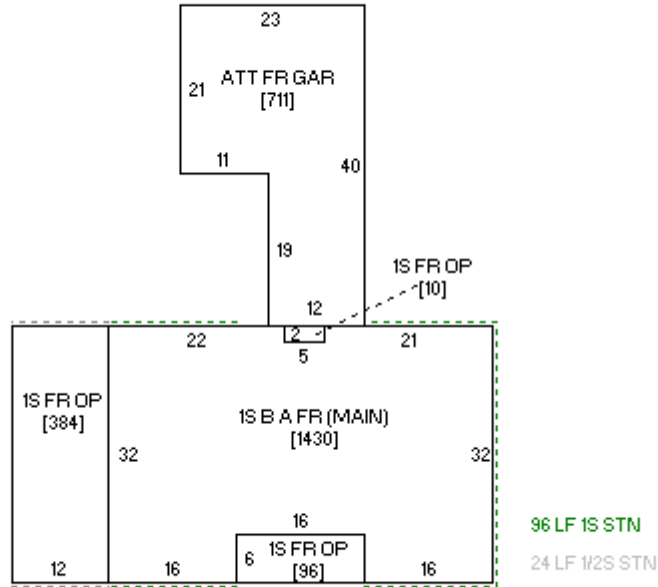
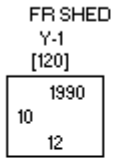

Sketch 1 of 1



Photo 1 of 1 09-09-2016