

Pin: 14-32-200-021/-022
Sale Date: 05/25/18
Sale Price: \$230,000
Acres: 10.25
Classification: Change in Use
from Ag to Rural Residential

9390.50

R-Res



14-32-200-021

MKB 12/13/15
NEWER MTL/TILE
ROOF ON DWLG

COMP
ODK

13

11

9

13

R-Res 9390.51
14-32-200-022

14-32-200-022

99

99

5
BIN

#9390.20

#12-LEAN-TO
(14 x 38)

See Photo 2

13

16

2

7

5

6

4

2

3

1

9

8

7

6

4

3

5

99

99

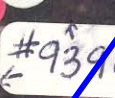

6531 90TH AVE (DWLG & O/BLDGS), STORM LAKE Deed: HOLTORF SHANE R,HOLTORF KATIE J

Map Area: HAYES-AG

Checks/Tags:

Contract:

Route: 915-004-780

Lister/Date: LF, 07/21/2008

CID#: 0000939050

Tax Dist: STORM LAKE HAYES

Review/Date: TG, 12/04/2008

DBA:

Plat Page: -

Entry Status: Inspected

MLS: 19996

Subdiv: [NONE]

RURAL / AG DWELLING

Legal: 32-90-37 STORM LAKE HAYES LOT A IN NE 1/4 (EX LOT A OF LOT A)

Land													
Land Basis	Front	Rear	Side 1	Side 2	R. Lot	SF	Acres						
BS							7.890						
CR						16,988.40	0.390						
Grand Total						360,676.80	8.280						

	Street	Utilities	Zoning	Land Use
BS	None	None	Not Applicable	Building Site
CR	None	None	Not Applicable	Cropland

Sales				Building Permits				Values				
Date	\$ Amount	NUTC	Recording	Date	Number	Tag	\$ Amount	Reason	Type		St. Equalized	
05/25/2018	\$230,000	D15	181291						Land		\$10,740	
01/31/2017	\$191,000	D0	170698						LandC		\$0	
06/27/2016	\$0	D14	161746						Dwlg		\$88,680	
11/25/2003	\$0	D22	111872-73						Impr		\$1,760	
									Total		\$101,180	

Res. Structure		Finish				Plumbing		Addition		Garage	
Occ. Code	101	Ttl Rooms Above #	7	Bedrooms Above #	3	Full Bath	1	Addition	No Additions	Garage	No garages
Occ. Descr.	Single-Family / Owner Occupied	Ttl Rooms Below #	1	Bedrooms Below #	0	Shower Stall Bath		Year Built		Style	
Year Built	1921	Standard Finish	325			Toilet Room		EFA		W X L	
EFA / EFYr	88 / 1921					Lavatory	1	EFA Year		Area (SF)	
Arch. Dsgn	N/A	Foundation	C Blk			Water Closet	1	Style		Year Built	
Style	1 Story Brick	Exterior Walls	Brk			Sink		Area (SF)		EFA	
AreaSF/TLA	1,465 / 1,978	Roof	Tile / Gable			Shower Stall/Tub		Condition		EFF Year	
GLA 1st/2nd	1,465 / 513	Interior Finish	Plas			Mtl St Sh Bath				Condition	
		Flooring	Carp / Hdwd			Mtl Stall Shower	1	Bsmt (SF)		Bsmt (SF)	
		Non-base Heating		Fireplace		No Bathroom		NoBsmt Flr(SF)		Bsmt (SF)	
		Floor/Wall #	0	Masonry, 1 Sty	1	Wet Bar		Heat		Qtrs Over	
		Pipeless #	0			Whirlpool Bathroom		AC		Qtrs Over (SF)	
		Hand Fired (Y/N)	No			Whirlpool Tub		Attic (SF)		Qtrs AC (SF)	
Condition	NML	Space Heat #	0			No Hot Water Tank				Door Opnrs	
		Appliances				No Plumbing				Stalls- Bsmt / Std	
Basement	Full	Range Unit	Built-In Vacuums			Sewer & Water Only					
No Bsmt Flr.	0	Oven - Single	Intercom System			Water Only w/Sink					
Heat	FHA - Gas	Oven - Double	Bl Stereo			Hot Tub					
AC	Yes	Dishwasher				Bidet					
Attic	1/2 Finished 513SF	Microwave				Fbgls Service Sink					
		Trash Compactor				Urinal					
		Jennair				Sauna					
		Security System				W'Pool Bath w/Shower					
						Water Only					
						No Tub/Shower					



Bldg / Addn	Description	Units	Year				
	101 — Single-Family / Owner Occupied						
	1 Story Brick	1,465					
#1	Bsmt Fin - Standard Finish (Low)	325 Tbl					
	Base Heat: FHA - Gas						
	Add Central Air	1,465					
	Add 1/2 Finished attic	513					
#1	Porch: 1S Brick Enclosed	200 SF					
	Deck #1: Concrete Patio-Low	144 SF					
	Deck #2: Vinyl/CompoDeck-Med	240 SF					
	Plumbing	4					
#1	Fireplace: Masonry, 1 Story	1					

	Count	Ag Building Description	Units	Year					
1 of 10 P:1	1	C/S 932-Silo - Conc	16' X 40' 6,463 Bu	1900					
2 of 10 P:2	1	SILO SHED @ SV 927-Shed	1' X 1' 1 SF	1900					
3 of 10 P:3	1	ATT SHED @ .20 927-Shed	20' X 40' 800 SF	1900					
4 of 10 P:4	1	FEED FR @ .40 907-Barn - Feed and Livestock	32' X 60' 1,920 SF	1900					
5 of 10 P:5	1	SHED FR @ .40 908-Lean-To	32' X 40' 1,280 SF	1900					
6 of 10 P:6	1	HAY FR @ .70 927-Shed	24' X 40' 960 SF	1900					
7 of 10 P:7	1	OP CONC @ .40 927-Shed	16' X 40' 640 SF	1900					
8 of 10 P:9	1	MACH FR @ .40 927-Shed	24' X 80' 1,920 SF	1900					
9 of 10 P:11	1	GARAGE FR @ .90 927-Shed	12' X 20' 240 SF	1900					
10 of 10 P:12	1	LEAN-TO #6 908-Lean-To	14' X 38' 532 SF	2012					

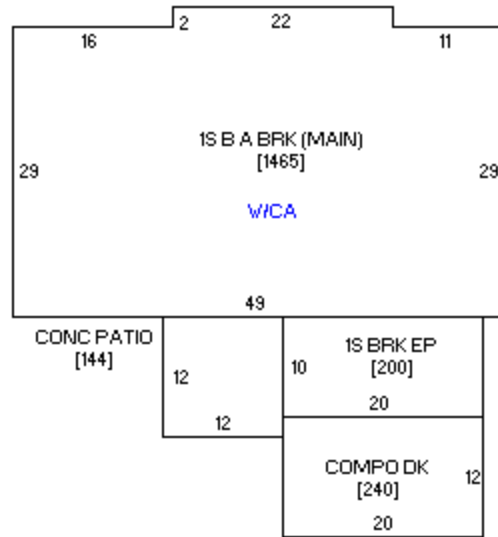

Sketch 1 of 1



Photo 1 of 2 12/15/2016



Photo 2 of 2 07/25/2008

PDF+PIN: 003+14-32-200-022
 6531 90TH AVE (O/BLDGS), STORM LAKE

Buena Vista County Assessor

CERTIFIED

Tue, 7/24/2018, 9:39 AM Page 1

Deed: HOLTORF SHANE R,HOLTORF KATIE J
 Contract:
 CID#: 0000939051
 DBA:
 MLS:

Map Area: HAYES-AG
 Route: 000-000-000
 Tax Dist: STORM LAKE HAYES
 Plat Page: -
 Subdiv: [NONE]

Checks/Tags:
 Lister/Date: CVH, 11/13/1986
 Review/Date:
 Entry Status: Inspected

RURAL / AG LAND

Legal: 32-90-37 STORM LAKE HAYES LOT C IN W 1/2 NE

Land												
Land Basis	Front	Rear	Side 1	Side 2	R. Lot	SF	Acres					
BS							1.970					
Grand Total						85,813.20	1.970					

Street	Utilities	Zoning	Land Use
BS None	None	Not Applicable	Building Site

Sales				Building Permits				Values				
Date	\$ Amount	NUTC	Recording	Date	Number	Tag	\$ Amount	Reason	Type		St. Equalized	
05/25/2018	\$0	D15	181291						Land		\$2,510	
01/31/2017	\$0	D0	170698						LandC		\$0	
01/31/2017	\$40,000	D9	170279						Dwlg		\$0	
08/16/2011	\$0	D22	112362						Impr		\$8,800	
									Total		\$11,310	

	Count	Ag Building Description	Units	Year						
1 of 8 P:2	1	MTL POLE 925-Steel Utility Bldg	54' X 90' 4,860 SF	1977						
2 of 8 P:3	1	STORAGE @ SV 904-Bin - Stl. Grain Storage	18' X 16' 3,468 Bu	1900						
3 of 8 P:4	1	STORAGE @ SV 904-Bin - Stl. Grain Storage	18' X 18' 3,902 Bu	1975						
4 of 8 P:5	1	STORAGE 904-Bin - Stl. Grain Storage	30' X 20' 12,383 Bu	1998						
5 of 8 P:6	1	HOG HSE FR @ .90 927-Shed	24' X 50' 1,200 SF	1900						
6 of 8 P:7	1	MACH FR @ .90 927-Shed	18' X 24' 432 SF	1900						
7 of 8 P:8	1	STORAGE @ SV 904-Bin - Stl. Grain Storage	18' X 16' 3,468 Bu	1900						
8 of 8 P:9	1	GOVT 904-Bin - Stl. Grain Storage	18' X 11' 2,384 Bu	1900						