

Pin: 15-20-300-007
Sale Date: 11/08/18
Sale Price: \$73,000
Acres: 5.92 Net
Classification: Change in use from
Ag to Rural Residential

15-20-300-007

R-Res

#8396.50



Res. Structure		Finish				Plumbing		Addition		Garage	
Occ. Code	101	Ttl Rooms Above #	7	Bedrooms Above #	4	Full Bath	1	Addition	1 of 1	Garage	1 of 1
Occ. Descr.	Single-Family / Owner Occupied	Ttl Rooms Below #	0	Bedrooms Below #	0	Shower Stall Bath		Year Built	1900	Style	Att Fr.
Year Built	1900					Toilet Room		EFA	119	W X L	0' X 0'
EFA / EFYr	119 / 1900					Lavatory		EFA Year	1900	Area (SF)	336
Arch. Dsgn	N/A	Foundation	Stn			Water Closet		Style	1 Sty Fr.	Year Built	1900
Style	1 1/2 Story Frame	Exterior Walls	Stl			Sink		Area (SF)	536	EFA	119
AreaSF/TLA	416 / 1,243	Roof	Asph / Gable			Shower Stall/Tub		Condition	Normal	EFF Year	1900
GLA 1st/2nd	952 / 291	Interior Finish	Plas / Panel			Mtl St Sh Bath		Bsmt (SF)		Condition	NML
		Flooring	Carp / Vinyl			Mtl Stall Shower		NoBsmt Flr(SF)		Bsmt (SF)	
		Non-base Heating		Fireplace		No Bathroom		Heat	FHA - Gas	Qtrs Over	None
		Floor/Wall #	0			Wet Bar		AC	No	Qtrs Over (SF)	
		Pipeless #	0			Whirlpool Bathroom		Attic (SF)		Qtrs AC (SF)	
		Hand Fired (Y/N)	No			Whirlpool Tub				Door Opnrs	
Condition	NML	Space Heat #	0			No Hot Water Tank				Stalls- Bsmt / Std	
		Appliances				No Plumbing					
		Range Unit		Built-In Vacuums		Sewer & Water Only					
Basement	Full	Oven - Single		Intercom System		Water Only w/Sink					
No Bsmt Flr.	0	Oven - Double		Bl Stereo		Hot Tub					
Heat	FHA - Gas	Dishwasher				Bidet					
AC	No	Microwave				FbglS Service Sink					
Attic	None	Trash Compactor				Urinal					
		Jennair				Sauna					
		Security System				W'Pool Bath w/Shower					
						Water Only					
						No Tub/Shower					



Bldg / Addn	Description	Units	Year			
	101 — Single-Family / Owner Occupied					
	1 1/2 Story Frame	416				
	Base Heat: FHA - Gas					
#1	Porch: 1S Frame Enclosed	154 SF				
	Deck #1: Concrete Patio-Low	216 SF				
	Garage: Att Frame	336 SF	1900			
Adtn	1 Story Frame	536 SF	1900			

	Count	Ag Building Description	Units	Year						
1 of 13 P:1	1	STORAGE @ SV 904-Bin - Stl. Grain Storage	18' X 18' 3,902 Bu	1900						
2 of 13 P:3	1	DRYER 904-Bin - Stl. Grain Storage	24' X 20' 7,838 Bu	1973						
3 of 13 P:4	1	DBL OHB L FR @ .90 926-Crib	27' X 44' 1,188 SF	1900						
4 of 13 P:5	1	FEED ST L FR; Pole Frame; Enameled 925-Steel Utility Bldg	32' X 52' 1,664 SF	1978						
5 of 13 P:6	1	FR @ .40 916-Shed - Hay	20' X 32' 640 SF	1900						
6 of 13 P:7	1	STG FR @ .90 927-Shed	10' X 16' 160 SF	1900						
7 of 13 P:8	1	MACH FR @ .40 927-Shed	20' X 40' 800 SF	1900						
8 of 13 P:10	1	HEN HSE FR @ .90 927-Shed	16' X 32' 512 SF	1900						
9 of 13 P:11	1	MACH FR @ .90 927-Shed	20' X 40' 800 SF	1900						
10 of 13 P:12	1	GARAGE FR @ .40 927-Shed	12' X 20' 240 SF	1900						
11 of 13 P:14	1	STORAGE 904-Bin - Stl. Grain Storage	18' X 16' 3,468 Bu	1900						
12 of 13 P:15	1	STORAGE 904-Bin - Stl. Grain Storage	18' X 18' 3,902 Bu	1900						
13 of 13 P:16	1	STORAGE 904-Bin - Stl. Grain Storage	30' X 18' 11,144 Bu	2000						

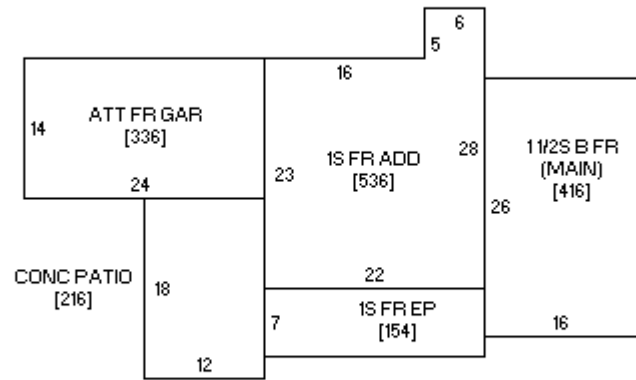

Sketch 1 of 1

